



ARCHITECTURAL AND PLANNING UNIT-1
NEELGIRI COMPLEX, INDIRA NGR, LUCKNOW
Email : uphdb@sachamethi

DRG. NO:

FILE NO.

SHEET NO.

NOTE

1. THIS PART LAY-OUT PLAN HAS BEEN PREPARED ON THE BASIS OF INFORMATION RECEIVED FROM E.E CD-32 VIDE HIS LETTER NO.985/Y-23 DT DATED-20.08.2015. & RECOMMENDED BY SE2 IN THE DISCUSSION.

PARTICULARS

TOTAL PLOT AREA							1748400 SQ.M.	
EXCLUDING COMM. CENTRE (CSC & SCHOOL)								
S.N.	FLAT TYPE	HOLD. FLOOR	FLATS PER BLOCK	NO. OF FLOOR	TOTAL PLATS	TOTAL AREA (SQ.M)	ONE SIDE (SQ.M)	TOTAL OF SIDE (SQ.M)
(A)	F-45	13	18	G+3	208	44.97	17890	2338.80
(B)	F-70	10	18	G+3	180	69.71	27184	2788.80
TOTAL		21			368		5127.30	29.32%

F.A.R. ACHIEVED

1.17

CAR PARKING PROVIDED

PROJECT

PROPOSED LAYOUT PLAN FOR F-45 & F-70 TYPE G+3 STORIED FLATS IN SECTOR-2A, SHAKUMBHARI YOJNA, SAHARAN PUR.

DRG. TITLE

PROP. LAYOUT PLAN FOR F-45 & F-70 TYPE FLATS ON PLOT NOS. 2AVGH-02,03 & 04.

DATE : 11.03.2016

SCALE: In m.



V.B.PATHAK
DRAUGHT'S MAN

SUBODH KUMAR
DIP.ARCH.AIA
ASSTT. ARCH. PLANNER

S.JYADAV
BARCH
ARCHITECT PLANNER

CHIEF ARCHITECT PLANNER
RUDRA PRATAP SINGH
I.A.S.
AVAS AYUKT

Handwritten signatures and dates:
23/2/16
24/2/16
24/2/16

45.0 M. WD. ROAD

N A T I O N A L HIGHWAY

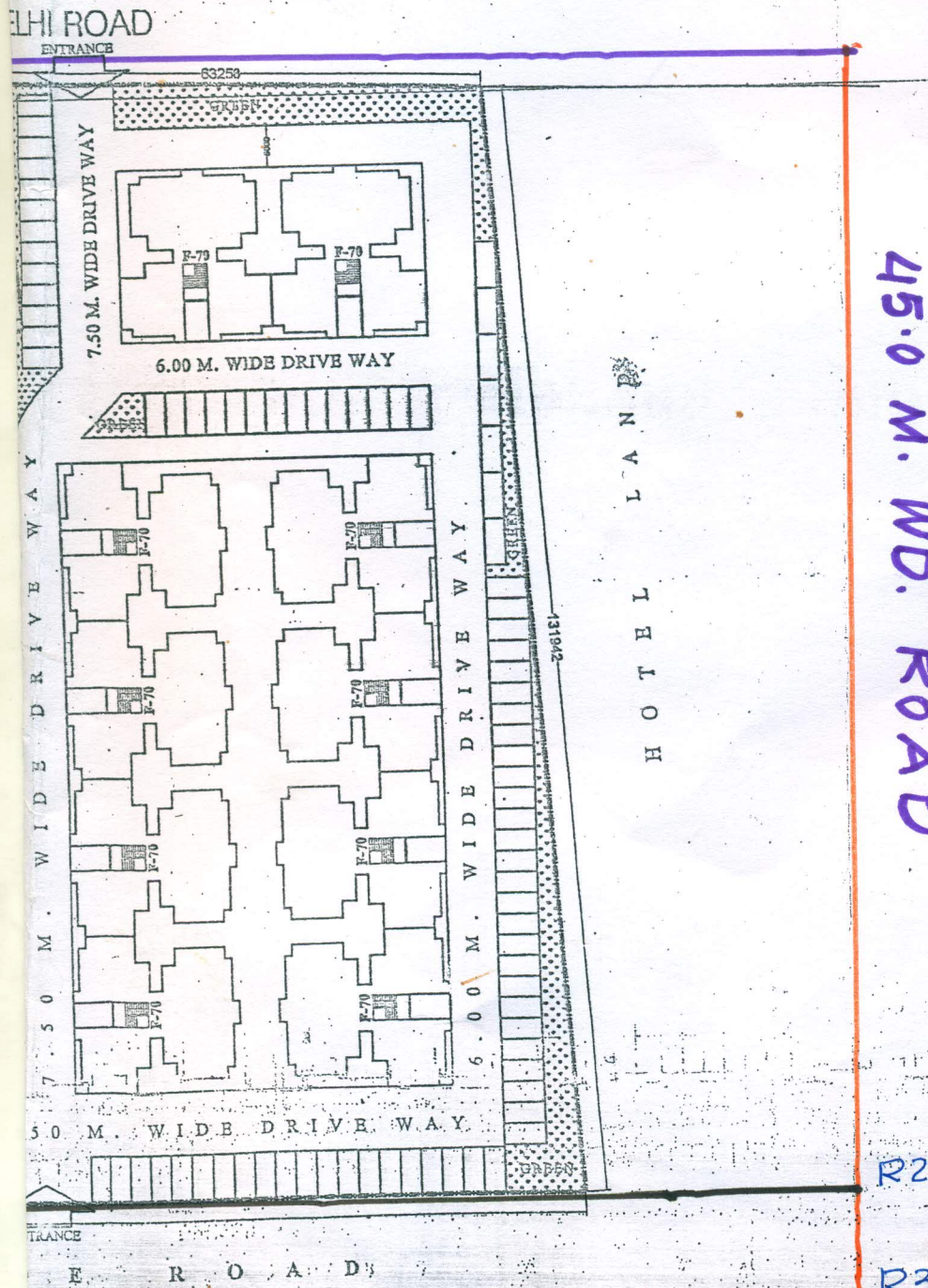
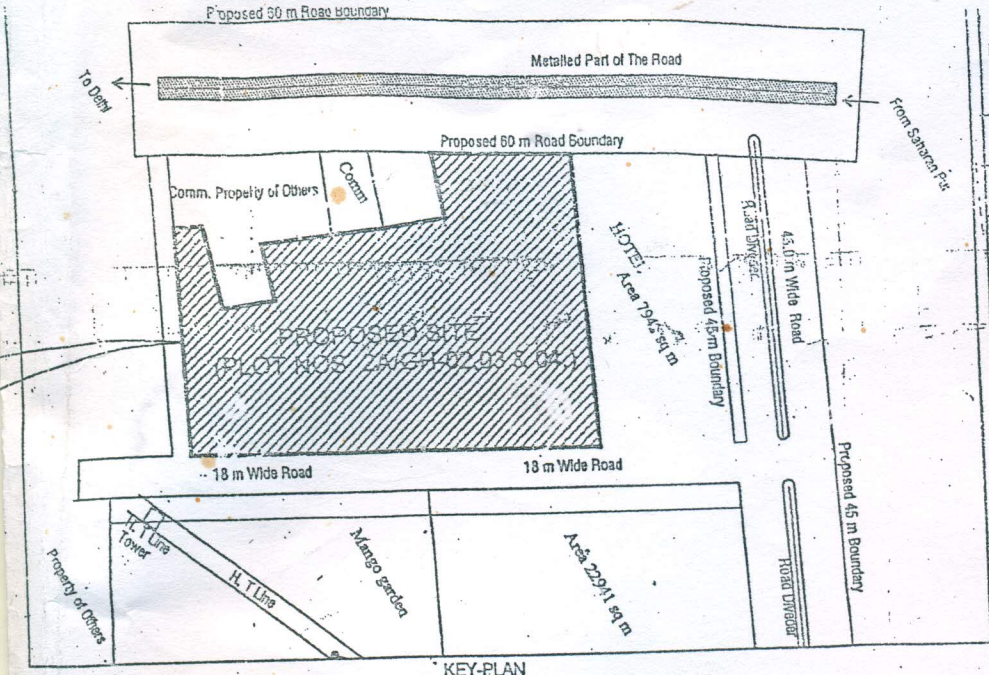

R2
R3