

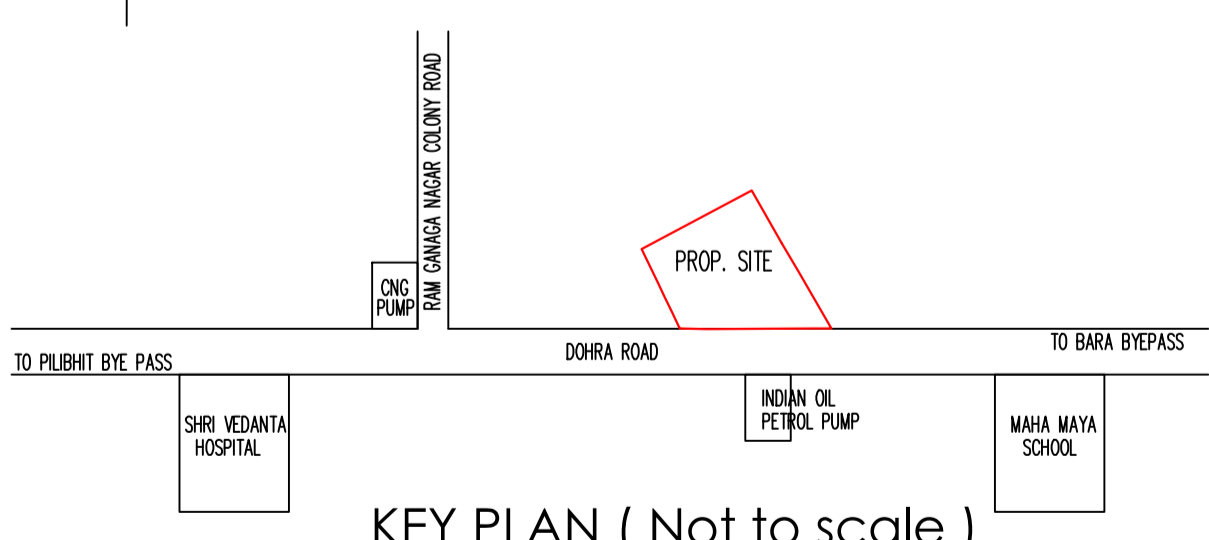

TOTAL LAND AREA IN DEED = 8960.00 SQ.MT.  
 TOTAL LAND AREA ON SITE = 8959.83 SQ.MT.  
 ROAD WIDENING AREA = 629.63 SQ.MT.  
 NET LAND AREA ON SITE = 8330.20 SQ.MT.

REQ. GREEN 15% = 1249.53 SQ.MT.  
 PROVIDED GREEN = 1338.41 SQ.MT.  
 REQ. COMMERCIAL 5% = 354.91 SQ.MT.  
 PROVIDED COMMERCIAL = 302.41 SQ.MT.  
 BAZAR STREET PLOT'S AREA ( B-1 TO B-11 ) = 1231.85 SQ.MT.  
 PLOTTED AREA = 3636.42 SQ.MT.  
 ROAD AREA = 1821.11 SQ.MT.

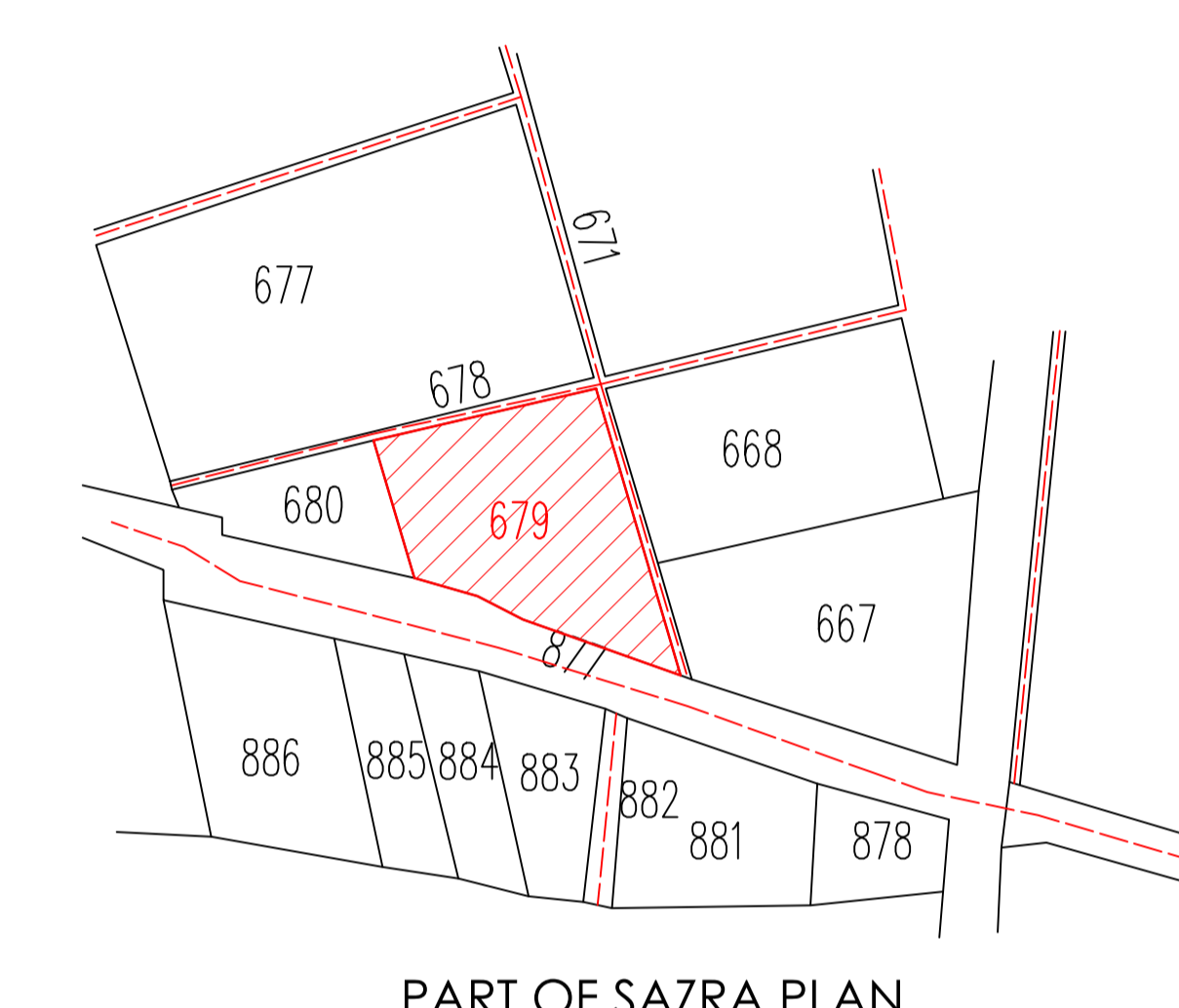

WATER SUPPLY PLAN ( 1:100 )

|                      |              |
|----------------------|--------------|
| SERVICES:--          | LEGEND:--    |
| INDIVISIBLE BORING ○ | PROP. WORK □ |

LAYOUT PLAN OF ( ROYAL RESIDENCY ) UNDER AFFORDABLE SCHEME AS PER GOVERNMENT ORDER NO. 63/2021/1093/8- 1-21-34 SITTING/2014 T.C. DATED 23 SEPTEMBER 2021, FOR AKASH BUILDTech PVT. LTD. AKASHPURAM BAREILLY THROUGH ITS DIRECTOR SHRI SHYAM SINGH RATHORE S/O SHRI STYADEV RATHORE OFFICE - 5, AKASH TOWER, PILIBHIT BYE PASS, BAREILLY. SITE AT KHET NO. 679, VILLAGE CHANDPUR BICHPURI, PARGANA, TEHSIL AND DIST. BAREILLY.

|                       |               |   |
|-----------------------|---------------|---|
| NORTH/ SCALE:--       | APP. SIGN.:-- | ARCHITECT:--  |
| <br>NORTH<br>AS SHOWN |               | PAWAN BHATT<br>M.Arch.<br>P6-7 BEHIND B.B.L. SCHOOL<br>D.D. PURAM BAREILLY.<br>9837059454 ( M ) |