

TRANSFORMER DIESEL GENSET OTHER'S PLOT

38.50

9000 WIDE ROAD

FEEDER PILLAR

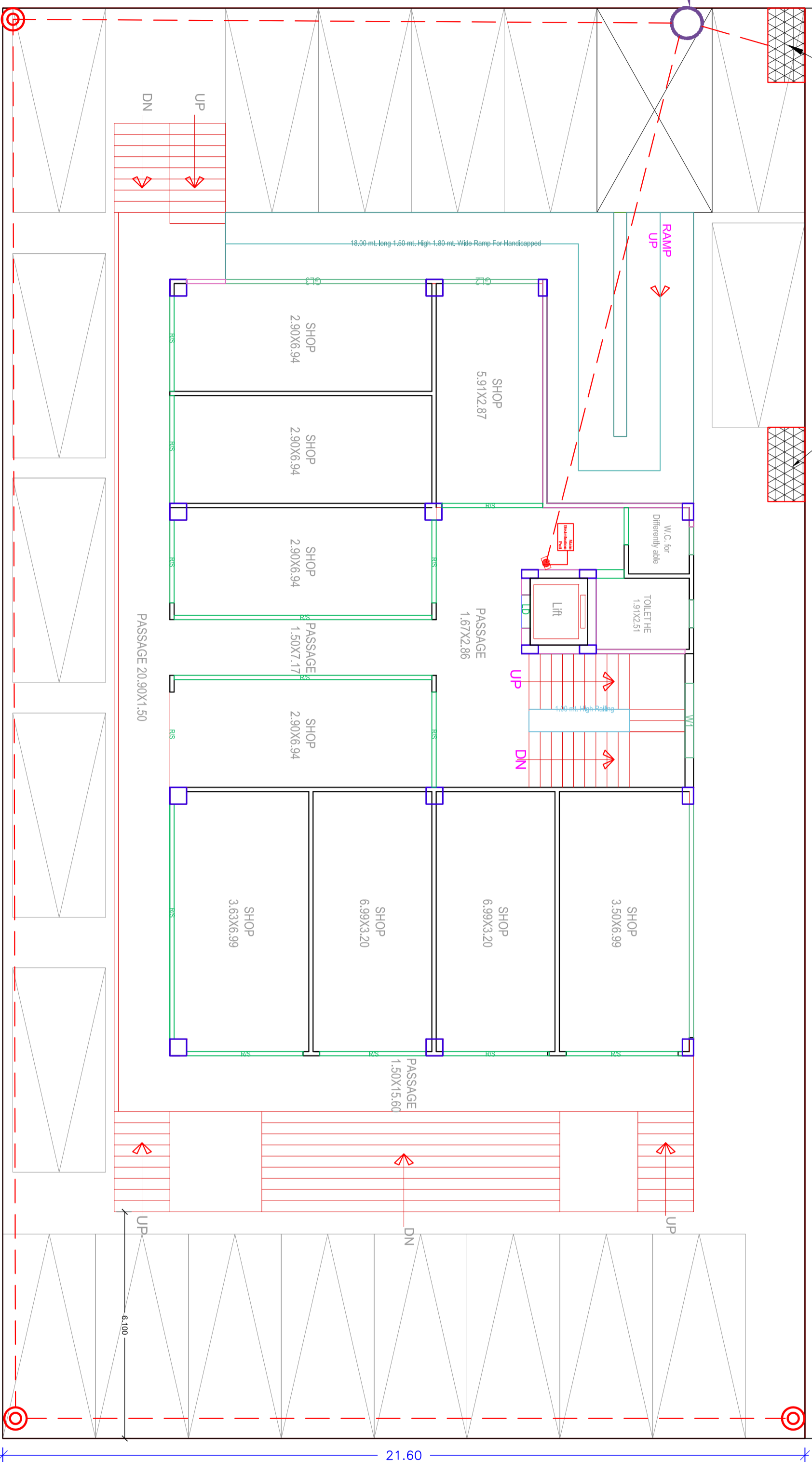

18000 WIDE ROAD

30000 WIDE ROAD

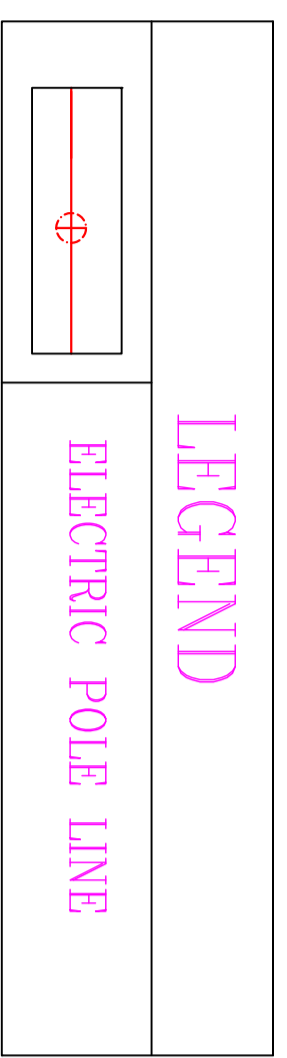

PROJECT

PROPOSED COMMERCIAL BUILDING
 PLAN FOR Smt. SHAHAHAN KHATOON &
 AZURE INFRA TECH PVT. LTD.
 (DIRECTOR - M. BRIJ BEHARILAL) AT
 PLOT NO. - 11/COM-103, SECTOR - 11,
 VRINDAVAN YOJNA -3, LUCKNOW.

EXTERNAL ELECTRICAL PLAN

DATE	SCALE	RVS/ION	SHEET NO.
30/05/2024	R0		01
DRAWING NO.	SHEET SIZE		
FIRE-01			

NOTE

1. ALL DIMENSIONS ARE IN METERS.
 2. THE DRAWING TO BE SCALED FROM THE DRAWINGS NOT TO BE ENLARGED.
 3. THE LIST OF INSTRUMENTS AND SCALE GIVEN TO DRAWINGS SHALL SUPPORT QUALITY AND ACCURACY OF THE DRAWINGS AND TO BE BROUGHT OUT TO THE NOTICE OF THE ARCHITECT AT THE TOP OF EACH DRAWING SHEET.
 4. ALL DIMENSIONS TO BE GIVEN ONLY FOR THE TOTAL AND NOT FOR THE PARTS.
 5. ALL DIMENSIONS TO BE GIVEN IN METERS.
 6. ALL DIMENSIONS TO BE GIVEN IN METERS.
 7. ALL DIMENSIONS TO BE GIVEN IN METERS.

THIS IS TO CERTIFY THAT PROPOSED BUILDING HAS BEEN PREPARED ACCORDING TO THE INFORMATION GIVEN BY THE OWNER AND BUILDING BYE LAWS.

architect's avenue
 D-2/122, Sambhav Tower, Vibhuti
 Khand Gomi Nagar, Lucknow, U.P.

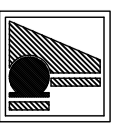

ARCHITECT

OWNER