

DESIGN OF SEWER OF KOTDWAR ROAD BHODMI VIKAS EVAM GRAHSTHAN YOTHA NAJIBABAD DIST. BIZBER

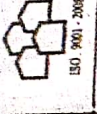

UPHDB  
ARCHITECTURE AND PLANNING SECTION  
NEELGIRI COMPLEX, INDIRA NAGAR,  
LUCKNOW-226016  
E-MAIL: uphdb@sancharnet.in

PROPOSED TRANSPORT LAYOUT PLAN OF KOTDWAR ROAD  
BHODMI VIKAS EVAM GRAHSTHAN YOTHA  
FILES NO. - **APP/UN-2/12/190-1/11/12**

DATE: 09.02.16

1. ALL DIMENSIONS ARE IN METERS.  
2. FIGURED DIMENSIONS SHALL BE FOLLOWED.  
3. ANY DISCREPANCY IF FOUND IN THE DRAWING SHALL BE BROUGHT TO THE NOTICE OF A.P. UNIT 3, BEFORE EXECUTION OF WORK.  
4. THIS TRANSPORT LAYOUT PLAN HAS BEEN PREPARED ON THE BASIS OF INFORMATION RECEIVED FROM E.C.O.24, VIDE HIS LETTER NO. 867/4/19 DATED 05.03.15 ON WHICH FEASIBILITY PROVIDED BY E.C.O.24 VIDE HIS LETTER NO. 490/4/16 DATED 20.07.15.  
5. THIS DETAILED LAYOUT PLAN HAS BEEN PREPARED ON THE BASIS OF INFORMATION / REQUIREMENT AND DETAILED TOPOGRAPHICAL SURVEY PROVIDED BY E.C.O.24 VIDE HIS LETTER NO. 110/4/11 DATED 22.04.15 AND S.E. CIR VIDE HIS LETTER NO. 182/24/18 DATED 22.07.15 IN WHICH IS AGAIN REVISED ON THE BASIS OF LATEST DATA FOR TOPOGRAPHICAL SURVEY PROVIDED BY E.C.O.24 VIDE HIS LETTER NO. 156/4/17 DATED 02.12.15.  
6. THIS DETAILED LAYOUT PLAN HAS BEEN PREPARED ON THE BASIS OF FEASIBILITY RECEIVED FROM E.C.O.24 VIDE HIS LETTER NO. 162/4/17/11/14 DATED 19.12.15.  
7. THIS DETAILED LAYOUT PLAN HAS BEEN PREPARED ON THE BASIS OF FEASIBILITY RECEIVED FROM E.C.O.24 VIDE HIS LETTER NO. 847/4/19 DATED 21.01.16 AND S.E. CIR VIDE HIS LETTER NO. 152/4/19 DATED 29.01.16.  
PROPERTY DETAIL:-

SL. NO.	PARTICULARS	SIZE(SQ.)	AREA	TOTAL( NOS.)
1	Plot	11.30 X 22.70	256.30	34
	Plot	9.00 X 18.00	162.00	64
	Plot	6.50 X 15.00	97.50	30
	Plot	6.00 X 12.00	72.00	111
	TOTAL			239
2	Plot	5.41 X 11.30	60.59	37
	Plot	4.85 X 8.45	40.74	308
	TOTAL			345
3	COMMERCIAL PLOTS		5051.05	10
4	COMMUNITY CENTRE		2372.68	1
5	PRIMARY SCHOOL		1891.75	1
6	S.I.P.		2234.00	1
	TOTAL		11749.48	13
	5 TOTAL			558

SCHEME AREA = 121009.19 SQM  
SCHEME AREA = 12.91 HECTARE

LANDUSE DETAILS:-

S.NO.	DESCRIPTION	AREA (Sqm)	%
1	RESIDENTIAL AREA	49716.33	40.42
2	COMMERCIAL AREA	5137.67	4.24
3	EDUCATIONAL	1981.75	1.61
4	FACILITY S.P.	2234.00	1.82
5	COMMUNITY CENTRE	2372.68	1.92
6	GREEN OPEN AREA	18425.06	15.00
7	CEMENTATION AREA	41908.59	34.07
	TOTAL	121009.19	100.00

PROPOSED TRANSPORT LAYOUT PLAN OF KOTDWAR ROAD  
BHODMI VIKAS EVAM GRAHSTHAN YOTHA,  
VAHABAD DIST. BIZBER.



SCALE:-  
 CHANGER  
 SLAS TYPE MANHOLE  
 ARCK TYPE MANHOLE

DEEP MALA  
SACIL ABST.  
HEMA SHAH  
ASST. ARCHITECT PLANNER  
GOPAL GARG  
ARCHITECT MANAGER  
R.P. SINGH  
ADDITIONAL CHIEF ENGINEER & SECRETARY  
STATE HABITATION CORPORATION  
SHAHABUDDIN MOHAMMAD  
CHIEF ENGINEER  
CHIEF ARCHITECT

FOR EXECUTION

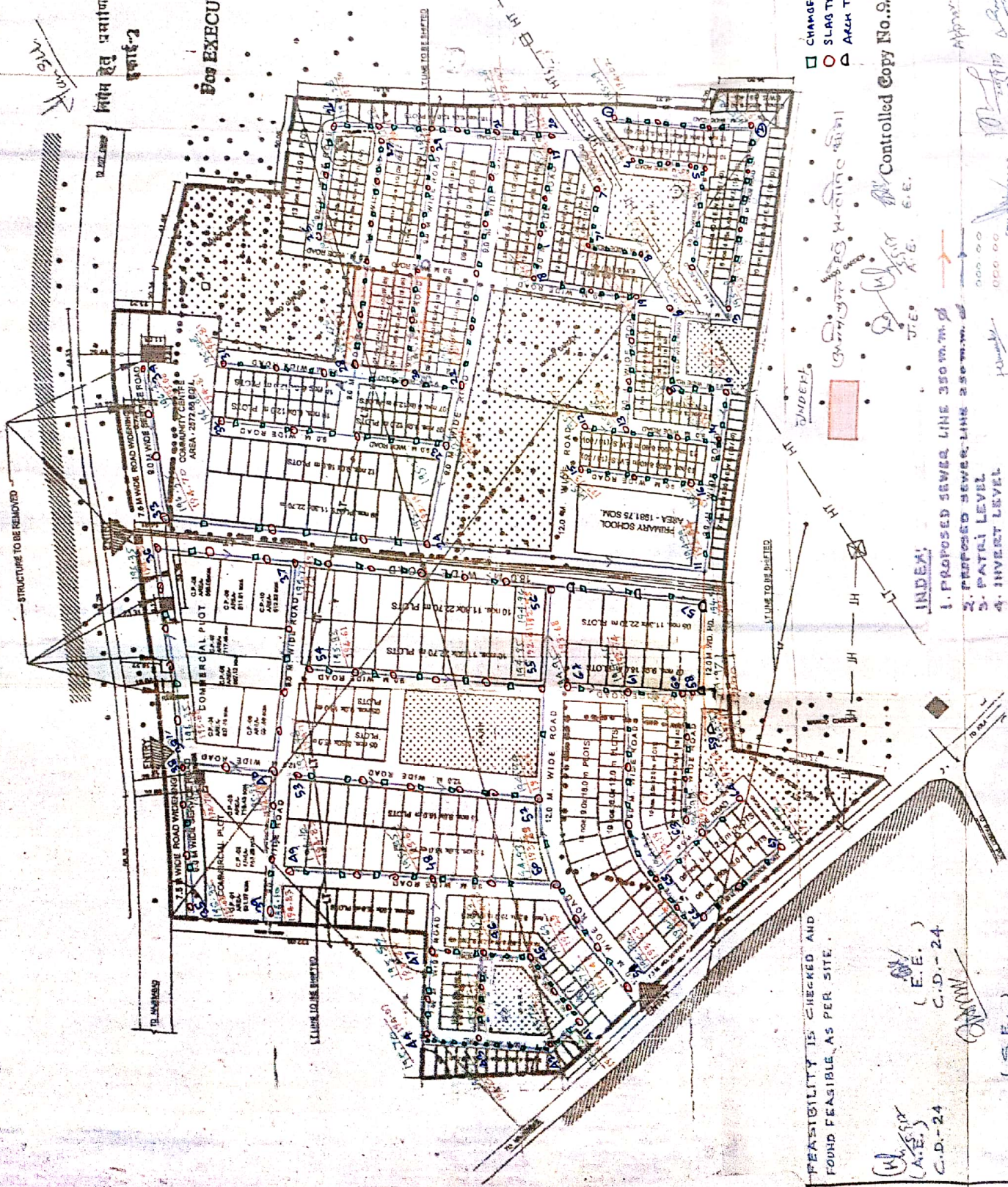

1. PROPOSED SEWER LINE 350 MM DIA.  
2. PROPOSED SEWER LINE 250 MM DIA.  
3. PATRI LEVEL  
4. INVERT LEVEL

INDEX:-

FEASIBILITY IS CHECKED AND FOUND FEASIBLE AS PER SITE.

(S.E.)  
C.D.-24

(A.E.)  
C.D.-24

(E.E.)  
C.D.-24

Controlled Copy No. 5000

Approved

Approved

(S.E.)  
C.D.-24

(A.E.)  
C.D.-24

(E.E.)  
C.D.-24

APPROVED

(S.E.)  
C.D.-24

(A.E.)  
C.D.-24

(E.E.)  
C.D.-24

APPROVED

(S.E.)  
C.D.-24

(A.E.)  
C.D.-24

(E.E.)  
C.D.-24