

SITE PLAN

130M WIDE ROAD

NOTES

- THIS DEVELOPMENT HAS BEEN CONCEIVED, DESIGNED AND DRAFTED ON THE BASIS OF THE FOLLOWING
1. ALL USEABLE OFFICE SPACES/RETAIL SPACES (LIKE SHOP AREAS, ENTERTAINMENT AND ATRIUM) WILL BE CENTRALLY AIR-CONDITIONED. THEREFORE, NO PROVISION HAS BEEN MADE FOR NATURAL VENTILATION OF SPACES.
 2. ALL TOILETS WILL BE MECHANICALLY (PROVISION OF HVAC) VENTILATED. CONDITIONED AIR FROM THE FLOOR WILL BE SUCKED IN TO THE TOILETS AND VENTED OUT THROUGH A VENT SHAFT
 3. ALL SPACES (RETAIL SPACES, SERVICE AREAS, PARKING BASEMENT, ETC) WILL BE ARTIFICIALLY LIT.
 4. 100% STANDBY GENERATING CAPACITY WILL BE PROVIDED FOR THE ENTIRE ELECTRICAL REQUIREMENT OF THE TOTAL SCHEME. THIS THEREFORE INCLUDES STANDBY GENERATION FOR ALL COMMON SERVICES, FIRE SERVICES, LIFTS ETC.
 5. BASEMENT WILL BE MECHANICALLY (PROVISION OF HVAC) VENTILATED.
 6. THIS BUILDING WILL BE SPRINKLED AS PER NBC NORMS.
 7. HANDICAP RAMP WITH RAILING PROVIDED.
 8. ALL NON-TOWER SLABS ARE STRUCTURALLY DESIGNED AS PER FIRE TENDER LOAD.
 9. THE PUBLIC HEALTH SERVICES I.E. WATER SUPPLY, SEWERAGE, STORM WATER, DRAINAGE/RAIN WATER HARVESTING SCHEMES WILL BE PROVIDED AS PER PUBLIC HEALTH NORMS.
 10. THE STRUCTURE OF THE BUILDING SHALL BE DESIGNED AND SUPERVISED BY A QUALIFIED STRUCTURAL ENGINEER AND A CERTIFICATE TO THIS EFFECT BE FURNISHED AT THE TIME OF SEEKING FULL COMPLETION CERTIFICATE OF THE BUILDING.
 11. THE OWNER SHALL BE PROVIDED WITH FIRE FIGHTING SYSTEM BEFORE OCCUPYING THE BUILDING A CERTIFICATE OF COMPLIANCE FROM THE FIRE DEPARTMENT WILL BE FURNISHED AT THE TIME OF SEEKING FULL COMPLETION OF THE BUILDING.



OWNER'S SIGN ARCHITECT'S SIGN

CLIENT:
PARTH BUILTECH PVT.LTD.

PROJECT:
NIRALA DIADEM
AT PLOT NO. C-6, SECTOR-10, GR. NOIDA WEST

SANCTION DRAWINGS TITLE
WASTE DISPOSAL PLAN

THIS DRAWING IS THE PROPERTY OF GIAN P. MATHUR & ASSOCIATES (P) LTD. AND SHALL NOT BE USED, COPIED OR REPRODUCED WITHOUT THEIR WRITTEN PERMISSION.		<p>GIAN P. MATHUR AND ASSOCIATES (P) LTD. C-55, East Of Kailash, New Delhi-110065 T: 46099991 P: 46099112 E: info@gpmindia.com I W: www.gpmindia.com</p>	
DEALT	SUGANDHA		
CHKD	RAHUL	SCALE - 1:200	DRG.NO. -S-01

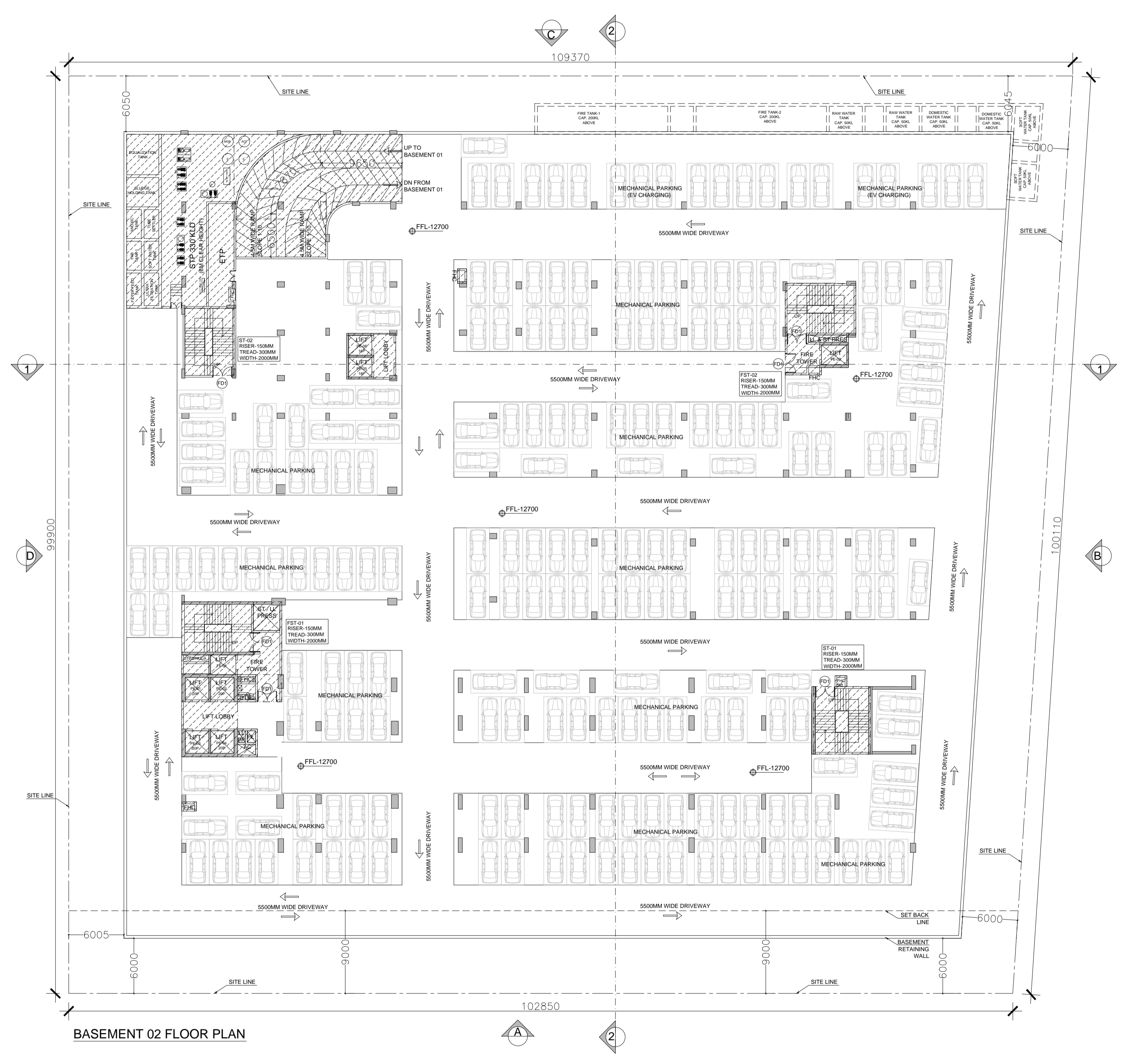

BASEMENT 02 FLOOR PLAN

OWNER'S SIGN		ARCHITECT'S SIGN	
CLIENT: PARTH BUILTECH PVT.LTD.			
PROJECT: NIRALA DIADEM AT PLOT NO. C-6, SECTOR-10, GR. NOIDA WEST			
SANCTION DRAWINGS		TITLE WASTE DISPOSAL PLAN	
<small>THIS DRAWING IS THE PROPERTY OF GIANP. MATHUR & ASSO. PVT. LTD. AND SHALL NOT BE USED, COPIED OR REPRODUCED WITHOUT THEIR WRITTEN PERMISSION.</small>		<small>GIAN P. MATHUR AND ASSOCIATES (P) LTD. C - 55, East Of Kailash, New Delhi-110065 ARCHITECTS A, FLANNORBI T : 46099999 F : 46099512 E : info@gpmda.com I W : www.gpmda.com</small>	
DEALT	SUGANDHA		
CHKD	RAHUL	SCALE - 1:200	DRG. NO. - S-02

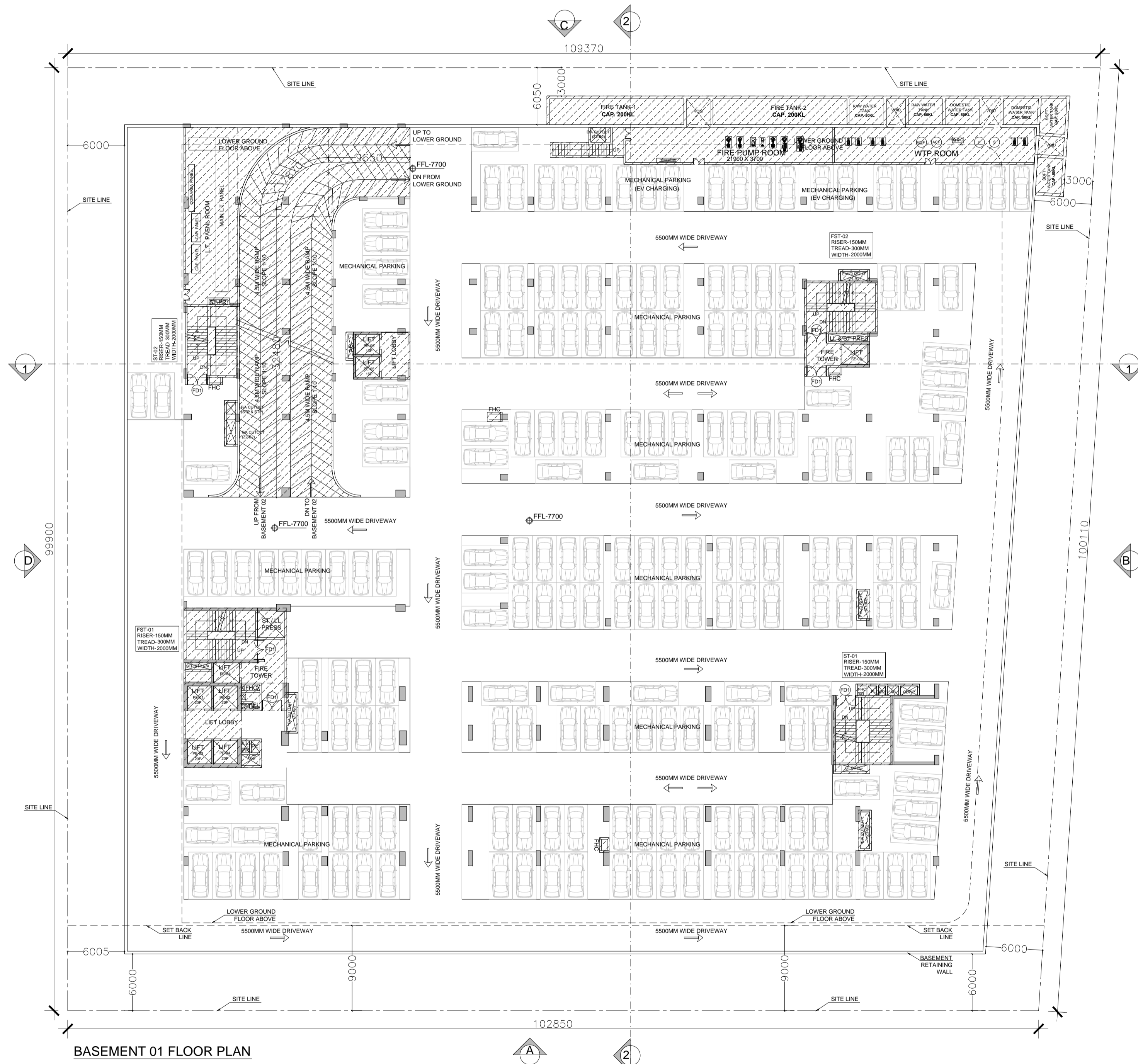

BASEMENT 01 FLOOR PLAN

OWNER'S SIGN		ARCHITECT'S SIGN	
CLIENT: PARTH BUILTECH PVT.LTD.			
PROJECT: NIRALA DIADEM AT PLOT NO. C-6, SECTOR-10, GR. NOIDA WEST			
SANCTION DRAWINGS		TITLE WASTE DISPOSAL PLAN	
<small>THIS DRAWING IS THE PROPERTY OF GIAN P. MATHUR & ASSO. PVT. LTD. AND SHALL NOT BE USED, COPIED OR REPRODUCED WITHOUT THEIR WRITTEN PERMISSION.</small>		<small>GIAN P. MATHUR AND ASSOCIATES (P) LTD. C - 55, East Of Kailash, New Delhi-110065 T : 46099999 F : 46099112 E : info@gpmindia.com W : www.gpmindia.com</small>	
DEALT	SUGANDHA	SCALE - 1:200	DRG.NO. - S-03
CHKD	RAHUL		