

Particulars	Area	Rate	Total
Total setback area	4.75	10,218.00	48,536.25
Area reserved for parking (25%)	2.37	9,606.75	22,976.81
Proposed area for parking	0.00	0.00	0.00
Total proposed area for parking	2.37	9,606.75	22,976.81

Particulars	Area	Rate	Total
Total setback area	4.75	10,218.00	48,536.25
No. of trees to be planted (1 tree/100 sq. m)	0.0475	10,218.00	485.36
Proposed no. of trees	0.00	0.00	0.00
Total proposed trees	0.0475	10,218.00	485.36

Particulars	Area	Rate	Total
Total setback area	4.75	10,218.00	48,536.25
Area reserved for parking (25%)	2.37	9,606.75	22,976.81
Proposed area for parking	0.00	0.00	0.00
Total proposed area for parking	2.37	9,606.75	22,976.81
Area reserved for green open space (75%)	2.38	9,606.75	22,976.81
Proposed area for green open space	0.00	0.00	0.00
Total proposed area for green open space	0.00	0.00	0.00
Total green area	2.38	9,606.75	22,976.81

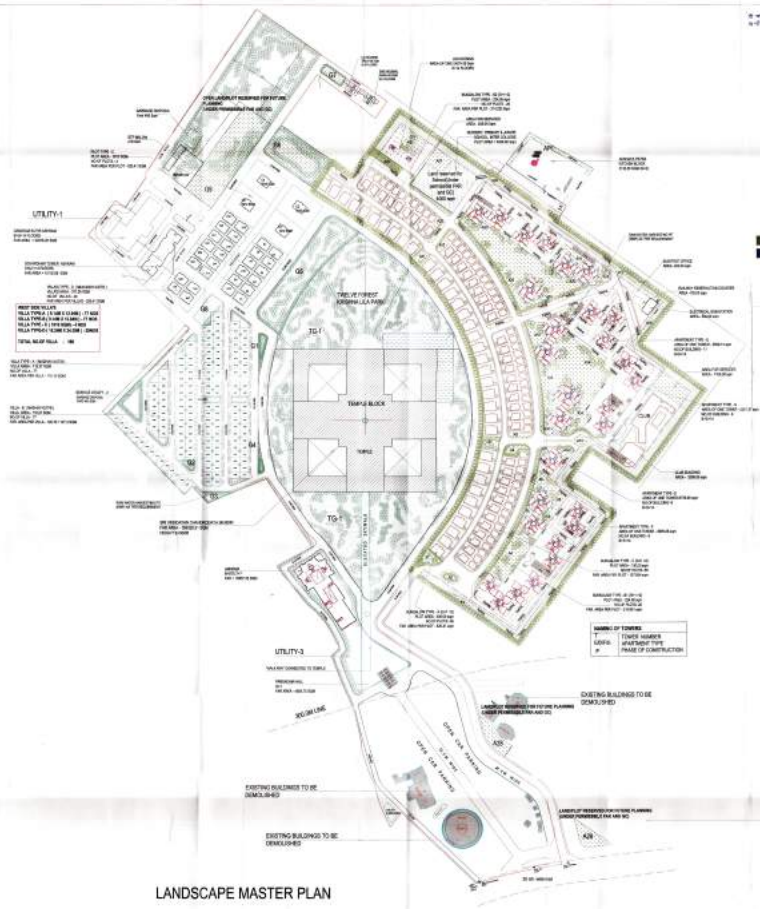
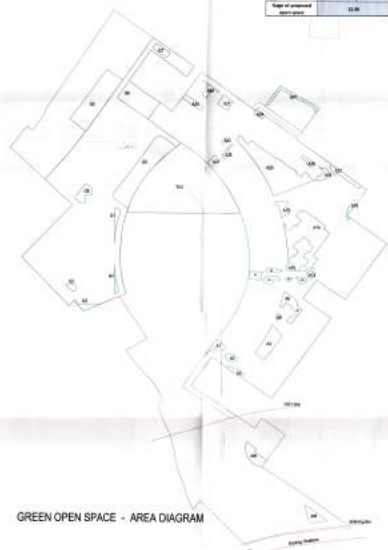

APPROVED FOR CONSTRUCTION

DATE: 10/10/2023

PROJECT: Sri Ratha Vinodan Chandra Mandir, Krishna Lila Theme Park and Group Housing

ARCHITECT: Rajeev Agarwal Architects

SCALE: 1:500

DATE: 10/10/2023

PROJECT NO: RAJ/23/01

LANDSCAPE MASTER PLAN

KBSSD Type A | A-100 | 00