

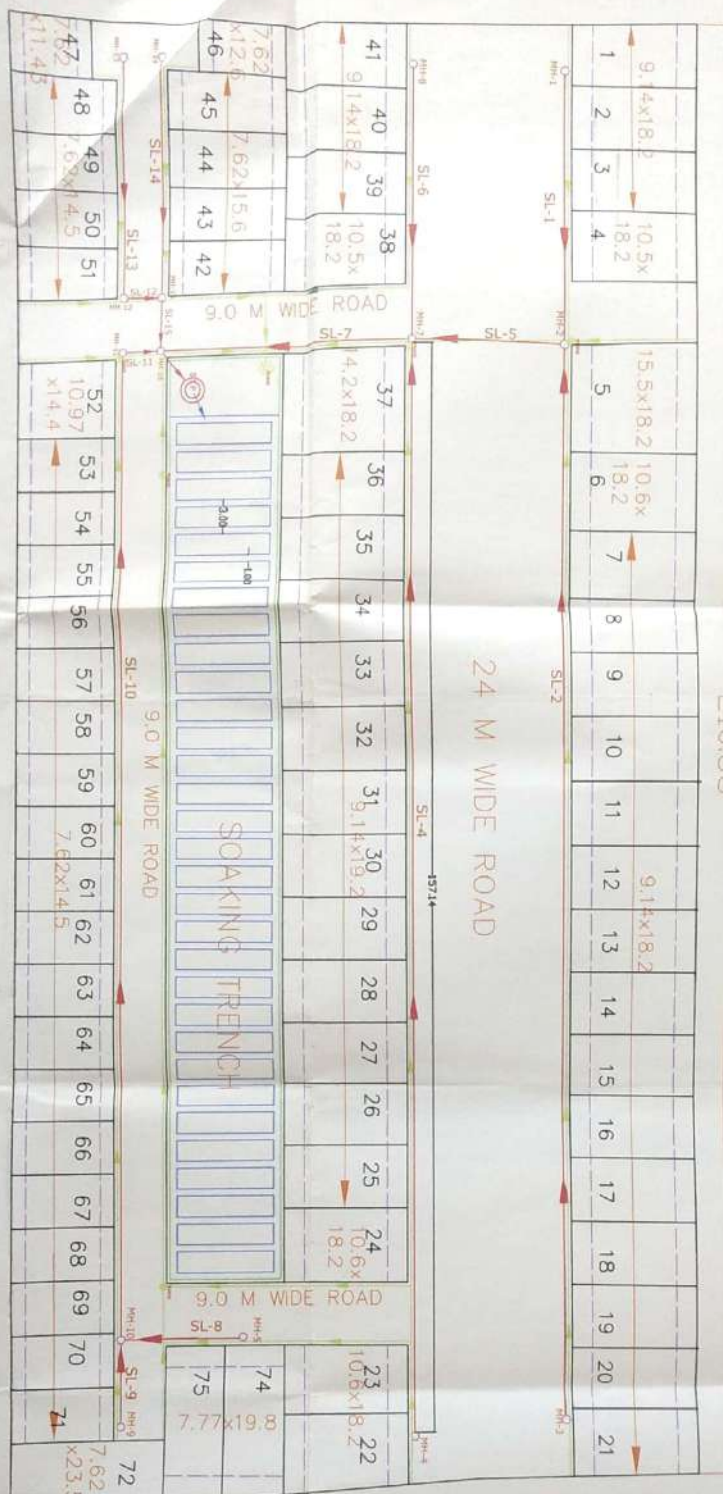

shape	triangular
width	0.6 meter
minimum depth	0.2 meter
maximum depth	0.5 meter
minimum velocity	0.7 m/s
maximum velocity	1.5 m/s
material of construction	Brick work
Position road	Between Road and way of right

-210.68



P. Indar Saxena
DINKAR SAXENA
MSc., MLE, C.Eng., M.I.P.E.
Environmental Auditor

Design criteria for sewer lines





Line	Velocity (g) full	Length (M)
SL-1	0.85 m/s minimum	38.95
SL-2	in all lines	154.63
SL-4		157.14
SL-5		20.88
SL-8		38.86
SL-7		36.17
SL-8		16.51
SL-8		11.18
SL-10		141.76
SL-11		4.48
SL-12		4.48
SL-13		32.09
SL-14		32.19
SL-15		6.70

PROPOSED LAYOUT PLAN OF RESIDENTIAL SCHEME KAILASH RESIDENCY ^{Part-D} IN KHASRA 185, 186, 187, 188C pink NO. 190 SITUATED AT MAUZA BARAULI AHIR TAUGANJ WARD AGRA

SMT. RAUNDANA AGRAWAL W/O SHRI PRAHALAD
AGRAWAL
SHRI: RAJEEV AGRAWAL S/O SHRI
BRAJMOHAN AGRAWAL

TITLE: PROPOSED SERVICES LAYOUT PLAN
FOR KAILASH RESIDENCY PART-II

LEGEND

Sewage treatment plant	
Sewer Line	
Sewage Flow Direction	
Manhole	
Rain water harvesting system	
Rain water drain	
Rain water flow direction	

SERVICE CONCEPT
M.Sc. M.E., M.P.H.E.
C.Eng. (Chartered Engineer)
DRAWN BY: TARIQUE MALIK

401 BILTM IN, BRADSHAW AVE, 1400 KANSAS CITY, MISSOURI 64111
Phone: 417-261-0100 FAX: 417-261-0101
E-mail: dkb@worldnet.att.net www.dkb.com

UASB specifications
 Cross section 5.62 sq. M
 Flow rate 75 K L/D
 Avg. Flow rate 3.125 m³/hr
 Sedimentation velocity 0.5 m/hr
 B.O.D 410 PPM
 C.O.D 1280 PPM
 UP Flow velocity 1.5 m/hr MAX
 HRT 12 hrs

Media specifications
 Cross section 120X44 mm
 Hydraulic radius 150 mm
 Shape hexagonal- chevron
 Material PVC
 Settling area at 55° 13 m² /m³
 Max. Working temp. 55°

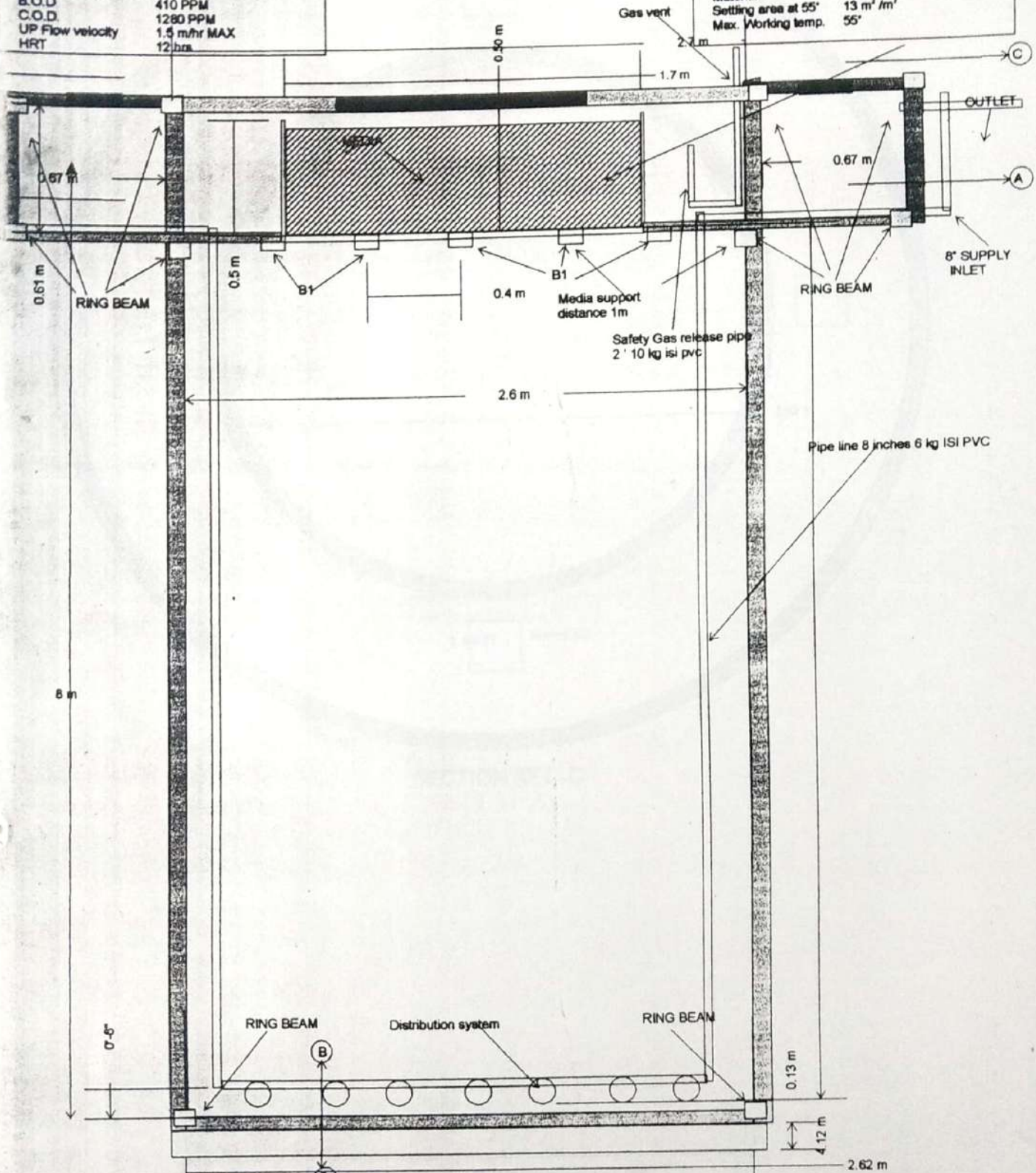

SECTION VIEW

PROJECT 70 KLD SEWAGE TREATMENT PLANT (concept drawing)
 DRAWING NO UASB 1
 SCALE NTS
 TITLE PLAN SECTION AND R.C.C DETAILS OF UASB REACTOR
 PREPARED BY DASS RASAYANIC SERVICES
 441 SECTOR 16 SIKANDRA AVAS YOJNA SIKANDRA AGRA
 0562-2641868, 3956890, MO. 9837007304
 PROJECT KAILASH RESIDENCY PHASE II, AGRA



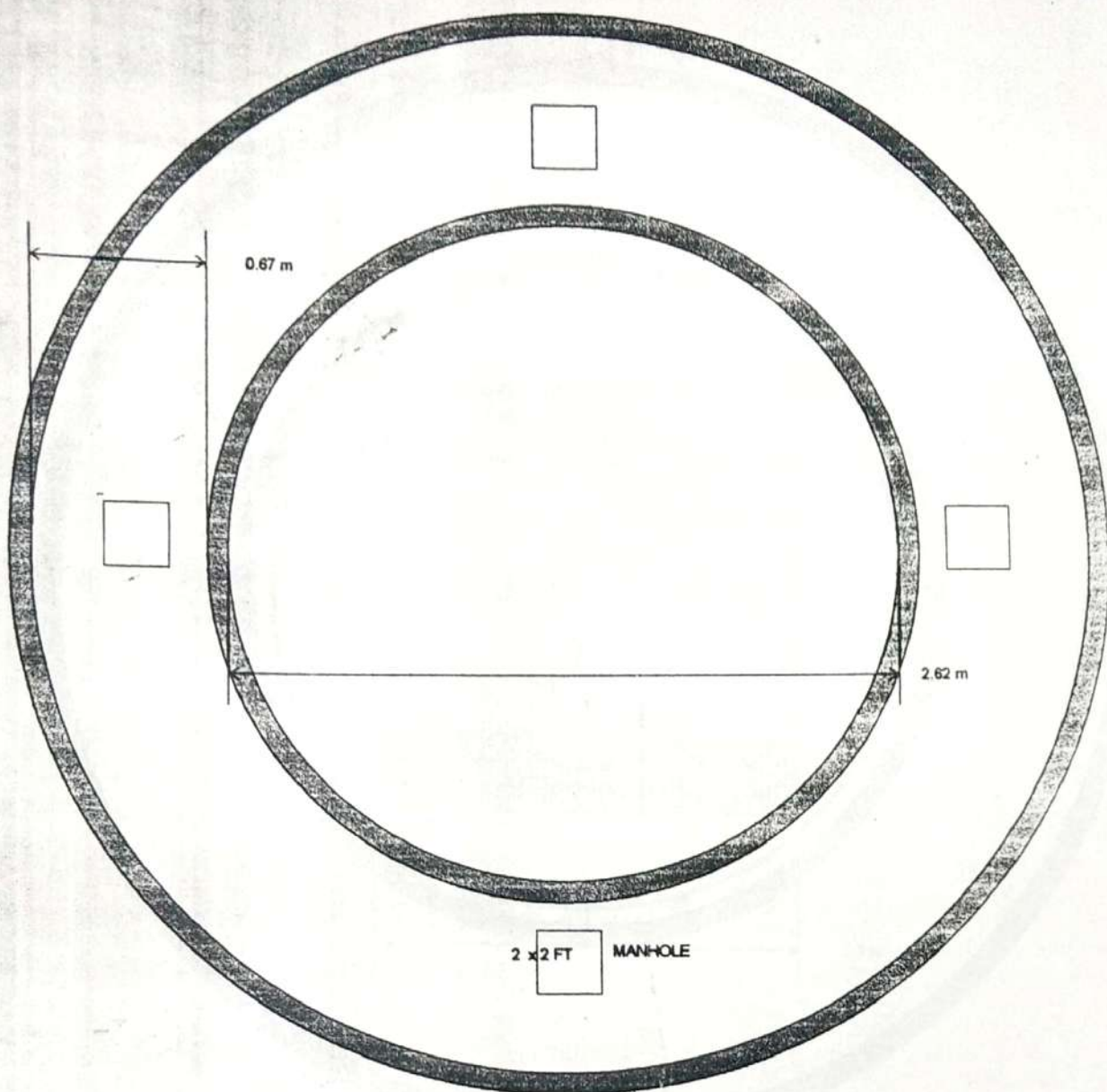

SECTION AT C-C

PROJECT	70 KLD SEWAGE TREATMENT PLANT (concept drawing)
DRAWING NO	UASB 2
SCALE	NTS
TITLE	PLAN SECTION AND R.C.C DETAILS OF UASB REACTOR
PREPARED BY	DASS RASAYANIC SERVICES
	441 SECTOR 16 SIKANDRA AVAS YOJNA SIKANDRA AGRA
	0562-2641866, 3956990, M.O. 9837007304
PROJECT	KAILASH RESIDENCY PHASE II, AGRA



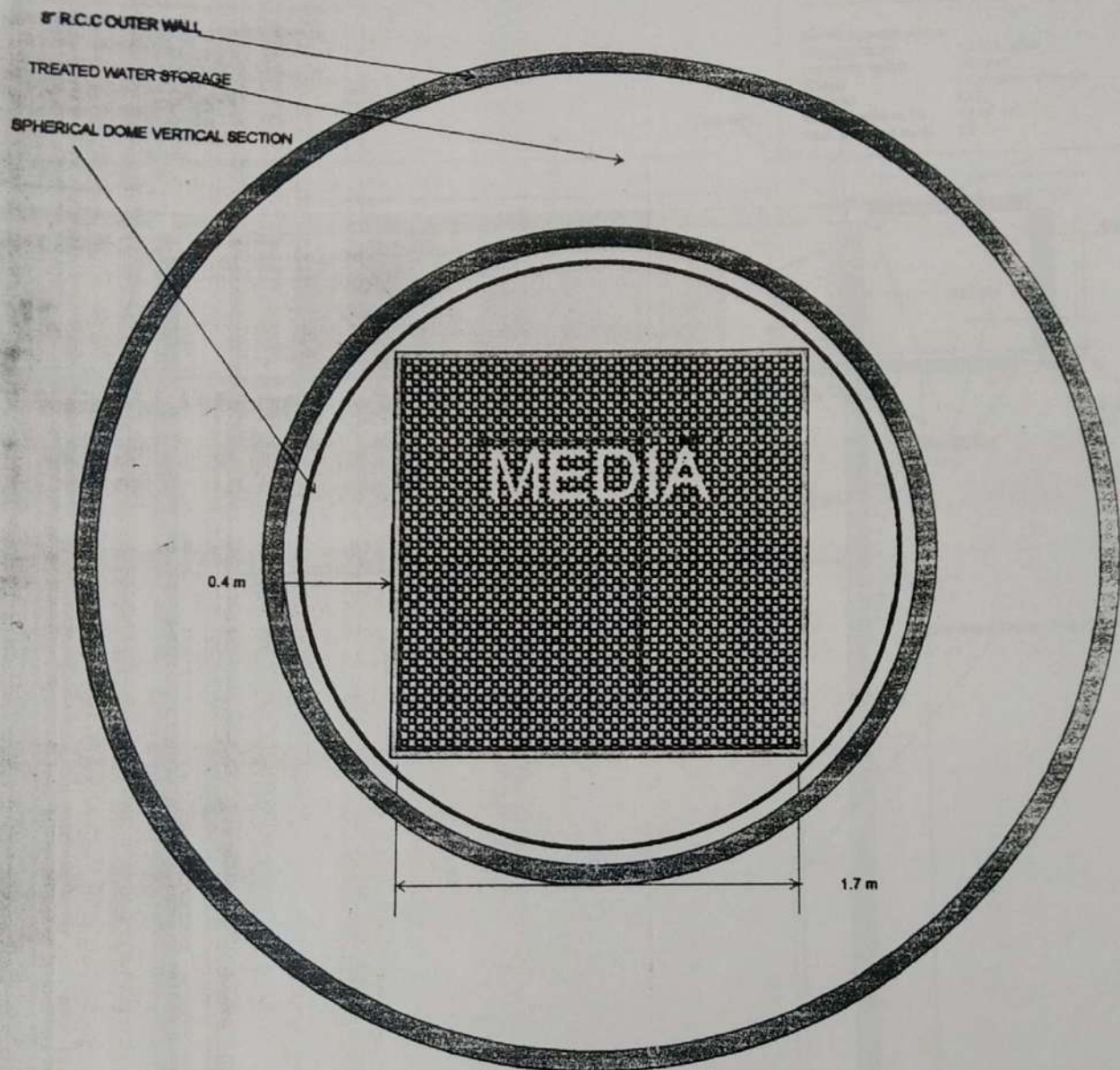

SECTION AT A-A

PROJECT	70 KLD SEWAGE TREATMENT PLANT (concept drawing)
DRAWING NO	UASB 3
SCALE	NTS
TITLE	PLAN SECTION AND R.C.C DETAILS OF UASB REACTOR
PREPARED BY	DASS RASAYANIC SERVICES
	441 SECTOR 16 SIKANDRA AVAS YOUNA SIKANDRA AGRA
	0562-2641886, 3956990, MO. 9837007304
PROJECT	KAILASH RESIDENCY PHASE II, AGRA

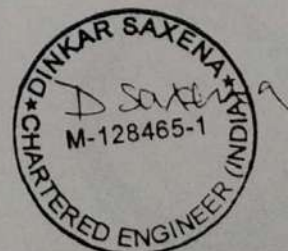

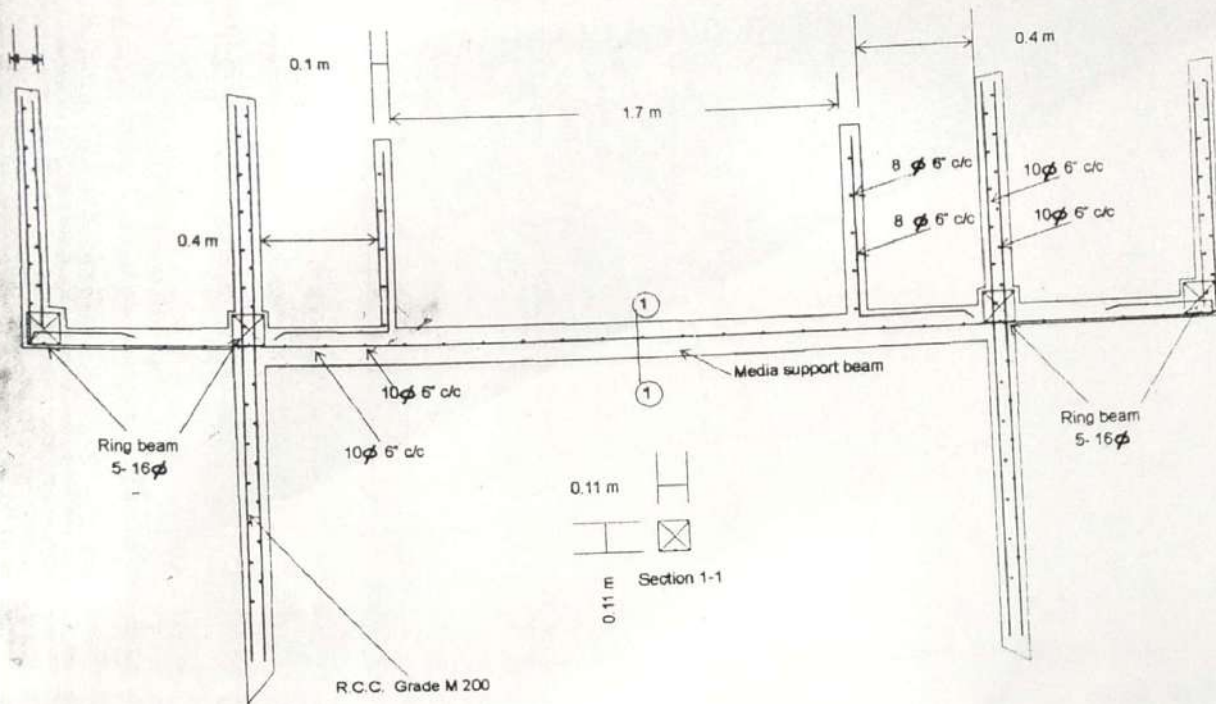

DETAILS OF R.C.C AT SECTION A-A

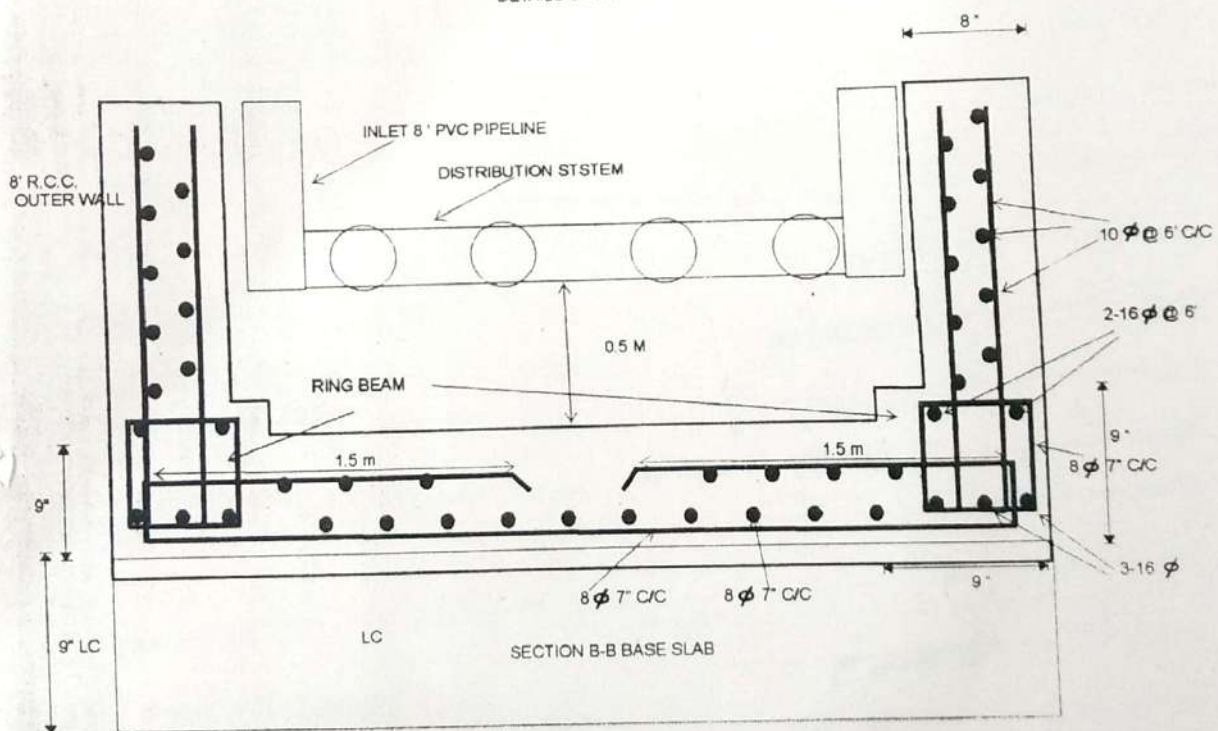

PROJECT 70 KLD SEWAGE TREATMENT PLANT (concept drawing)
 DRAWING NO UASB 4
 SCALE NTS
 TITLE PLAN SECTION AND R.C.C DETAILS OF UASB REACTOR
 PREPARED BY DASS RASAYANIC SERVICES
 441 SECTOR 16 SIKANDRA AVAS YOJNA SIKANDRA AGRA
 0562-2641866, 3956990, MO. 9837007304
 PROJECT KAILASH RESIDENCY PHASE II, AGRA

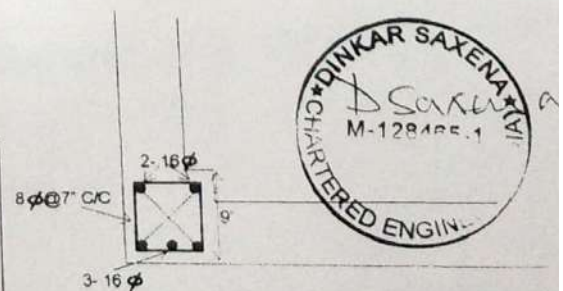

SECTION FOR RING BEAM