

SEWER SERVICES LEGEND:	
	EXTERNAL SEWER MANHOLE
	BRANCH SEWER MANHOLE (600 x 600 MM)
	EXTERNAL SEWER LINE (DIA AS DESIGN CHART & PIPE MATERIAL AS TENDER DOCUMENT)
	1500 DWC PIPE, S=1:100
	SIZE : 600 x 600 MM
STORM SERVICES LEGEND:	
	EXTERNAL STORM WATER MANHOLE
	CATCH BASIN (450 x 450) MM
	BRANCH STORM WATER MANHOLE (600 x 600) MM
	1500 DWC STORM WATER BRANCH LINE, SLOPE=1:150
	EXTERNAL STORM WATER LINE (DIA AS DESIGN CHART & PIPE MATERIAL AS TENDER DOCUMENT)
	1500 DWC PIPE, S=1:150
	SIZE : 600 x 600 MM
	SIZE : 450 x 450 MM
	1500 DWC PIPE, S=1:150
D.C.	DESILTING CHAMBER (3.0 x 1.5) M
R.P.	RECHARGE PIT (3.0 M DIA)
WATER SUPPLY SERVICES LEGEND:	
	VALVE WITH CHAMBER FOR WATER SUPPLY ZONING (750 x 750) MM
	DI DOMESTIC WATER SUPPLY LINE (DIA AS CHART)
	DI FLUSHING WATER SUPPLY LINE (DIA AS CHART)
	MUNICIPAL WATER SUPPLY
	TUBE WELL SUPPLY LINE (DIA AS CHART)
	IRRIGATION SUPPLY LINE (DIA AS CHART)
	G.H. 250 UPVC 10 KG. GARDEN HYDRANT POINT
	EXTERNAL FIRE HYDRANT

WATER SUPPLY LAYOUT

SERVICES DRAWING FOR APPROVAL

PROJECT TITLE: PROPOSED RESIDENTIAL TOWNSHIP AT VILLAGE - JAITIKHERA & NOORNAGAR BHADRASA, PARGANA - BIJNAUR, TEHSIL-SAROJINI NAGAR, LUCKNOW		DIRECTION: 	LAND DETAILS: KHASRA NO: 1026, 1027, 1028, 1029sa, 1031, 1032, 1033, 1035, 1036, 1038, 1046, 1046/1.7.	DEVELOPER: HANSA KUMAR DEVELOPERS PRIVATE LIMITED 	ARCHITECT: Ar. Sanjay Kumar Gupta 108, F. Floor, Corporate Chamber-1, Vidhaya Bhawan, Ganga Nagar, Lucknow-226010 Ph. No. 42893506, 04119114000 email: espaces.arch@gmail.com
Notes: <ul style="list-style-type: none"> OWNERSHIP OF THE SHOWN/LISTED LAND IS BEING VERIFIED BY THE DEVELOPER. ARCHITECT SHALL NOT BE RESPONSIBLE FOR ANY DISPUTE RELATED TO LAND OWNERSHIP. THIS DRAWING IS VALID ONLY IF SIGNED BY THE DEVELOPER. TO BE SUBMITTED BY THE DEVELOPER WITH A COMPETENT AUTHORITY ONLY FOR APPROVAL. 		SHEET NO.: services/01 DATE: 02.05.2025			

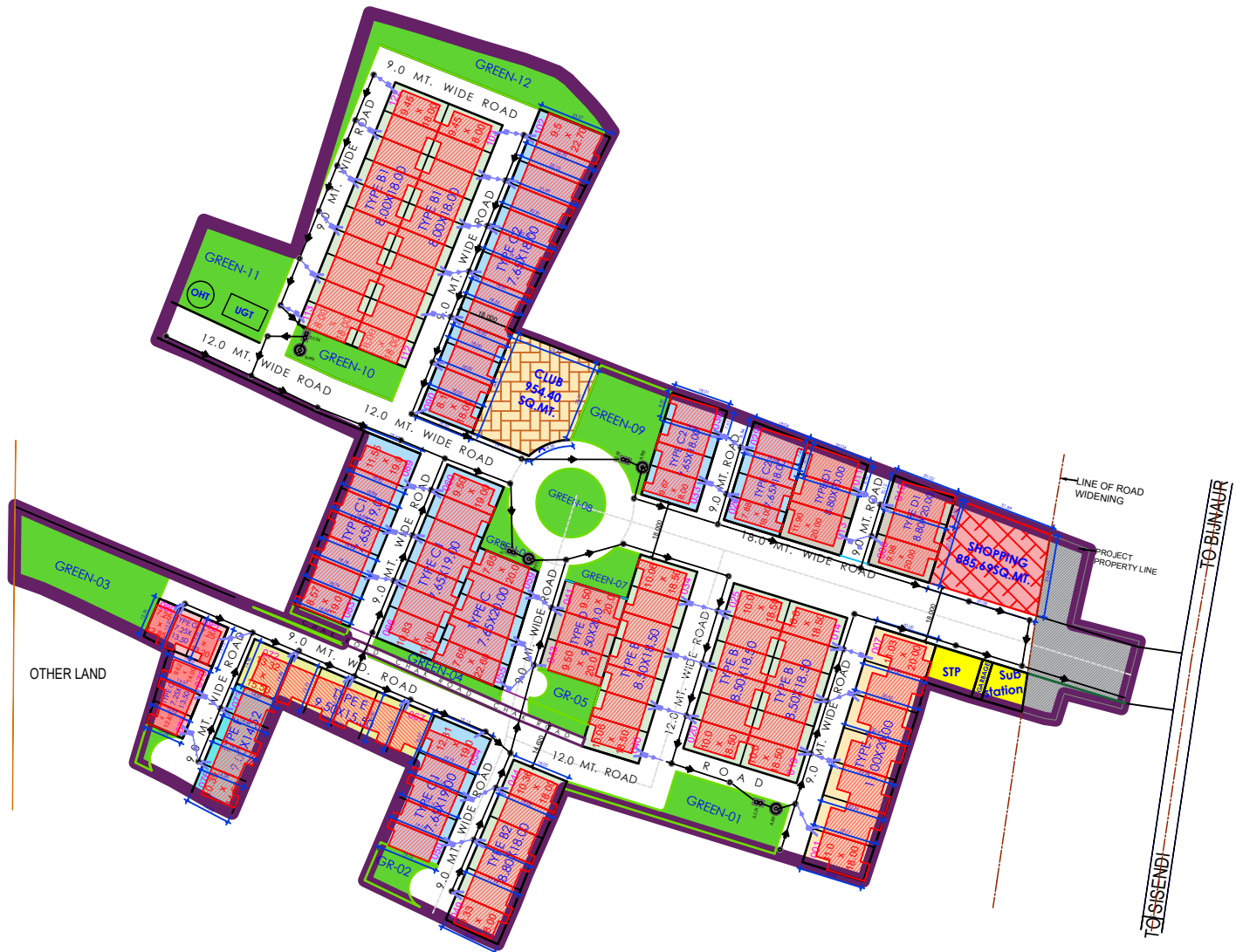

SEWER SERVICES LEGEND:	
	EXTERNAL SEWER MANHOLE
	BRANCH SEWER MANHOLE (600 x 600 MM)
	EXTERNAL SEWER LINE (DIA AS/DESIGN CHART & PIPE MATERIAL AS/TENDER DOCUMENT)
	1500 DWC PIPE, S=1:100
	SIZE: 600 x 600 MM
STORM SERVICES LEGEND:	
	EXTERNAL STORM WATER MANHOLE
	CATCH BASIN (450 x 450 MM)
	BRANCH STORM WATER MANHOLE (600 x 600 MM)
	1500 DWC STORM WATER BRANCH LINE, SLOPE=1:150
	EXTERNAL STORM WATER LINE (DIA AS/DESIGN CHART & PIPE MATERIAL AS/TENDER DOCUMENT)
	1500 DWC PIPE, S=1:150
	SIZE: 600 x 600 MM
	SIZE: 450 x 450 MM
	D.C. DESILTING CHAMBER (3.0 x 1.5) M
	R.P. RECHARGE PIT (3.0 M DIA)
WATER SUPPLY SERVICES LEGEND:	
	VALVE WITH CHAMBER FOR WATER SUPPLY ZONING (750 x 750) MM
	DI DOMESTIC WATER SUPPLY LINE (DIA AS/CHART)
	DI FLUSHING WATER SUPPLY LINE (DIA AS/CHART)
	MUNICIPAL WATER SUPPLY
	TUBE WELL SUPPLY LINE (DIA AS/CHART)
	IRRIGATION SUPPLY LINE (DIA AS/CHART)
	G.H. 250 UPVC 10 KG. GARDEN HYDRANT POINT
	E.F.H. EXTERNAL FIRE HYDRANT

STORM WATER LAYOUT

SERVICES DRAWING FOR APPROVAL

PROJECT TITLE: PROPOSED RESIDENTIAL TOWNSHIP AT VILLAGE - JAITIKHERA & NOORNAGAR BHADRASA, PARGANA - BIJNAUR, TEHSIL-SAROJINI NAGAR, LUCKNOW		DIRECTION: 	LAND DETAILS: KHASRA NO: 1026, 1027, 1028, 1029sa, 1031, 1032, 1033, 1035, 1036, 1038, 1046, 1046/1,7.	DEVELOPER: HANSA KUMAR DEVELOPERS PRIVATE LIMITED 	ARCHITECT: Ar. Sanjay Kumar Gupta 108, F. Floor Corporate Chamber-1, Vishnu Khari Centre Bldg, Lucknow-226010 Ph. No. 4282556, 4419174, 45589 email: spaces_arch@sanjay.com
Notes: <ul style="list-style-type: none"> OWNERSHIP OF THE SHOWN/LISTED LAND IS BEING VERIFIED BY THE DEVELOPER. ARCHITECT SHALL NOT BE RESPONSIBLE FOR ANY DISPUTE RELATED TO LAND OWNERSHIP. THIS DRAWING IS VALID ONLY IF SIGNED BY THE DEVELOPER. TO BE SUBMITTED BY THE DEVELOPER WITH A COMPETENT AUTHORITY ONLY FOR APPROVAL. 		SHEET NO.: services/01 DATE: 02.05.2025			

SEWER SERVICES LEGEND:	
	EXTERNAL SEWER MANHOLE
	BRANCH SEWER MANHOLE (600 x 600 MM)
	EXTERNAL SEWER LINE (DIA AS DESIGN CHART & PIPE MATERIAL AS TENDER DOCUMENT)
	1500 DWC PIPE, S=1:100
	SIZE: 600 x 600 MM
STORM SERVICES LEGEND:	
	EXTERNAL STORM WATER MANHOLE
	CATCH BASIN (450 x 450 MM)
	BRANCH STORM WATER MANHOLE (600 x 600 MM)
	1500 DWC STORM WATER BRANCH LINE, SLOPE=1:150
	EXTERNAL STORM WATER LINE (DIA AS DESIGN CHART & PIPE MATERIAL AS TENDER DOCUMENT)
	1500 DWC PIPE, S=1:150
	SIZE: 600 x 600 MM
	1500 DWC PIPE, S=1:150
	SIZE: 450 x 450 MM
D.C.	DESILTING CHAMBER (3.0 x 1.5) M
R.P.	RECHARGE PIT (3.0 M DIA)
WATER SUPPLY SERVICES LEGEND:	
	VALVE WITH CHAMBER FOR WATER SUPPLY ZONING (750 x 750) MM
	DI DOMESTIC WATER SUPPLY LINE (DIA AS CHART)
	DI FLUSHING WATER SUPPLY LINE (DIA AS CHART)
	MUNICIPAL WATER SUPPLY
	TUBE WELL SUPPLY LINE (DIA AS CHART)
	IRRIGATION SUPPLY LINE (DIA AS CHART)
	G.H. 250 uPVC 10 KG. GARDEN HYDRANT POINT
	EXTERNAL FIRE HYDRANT

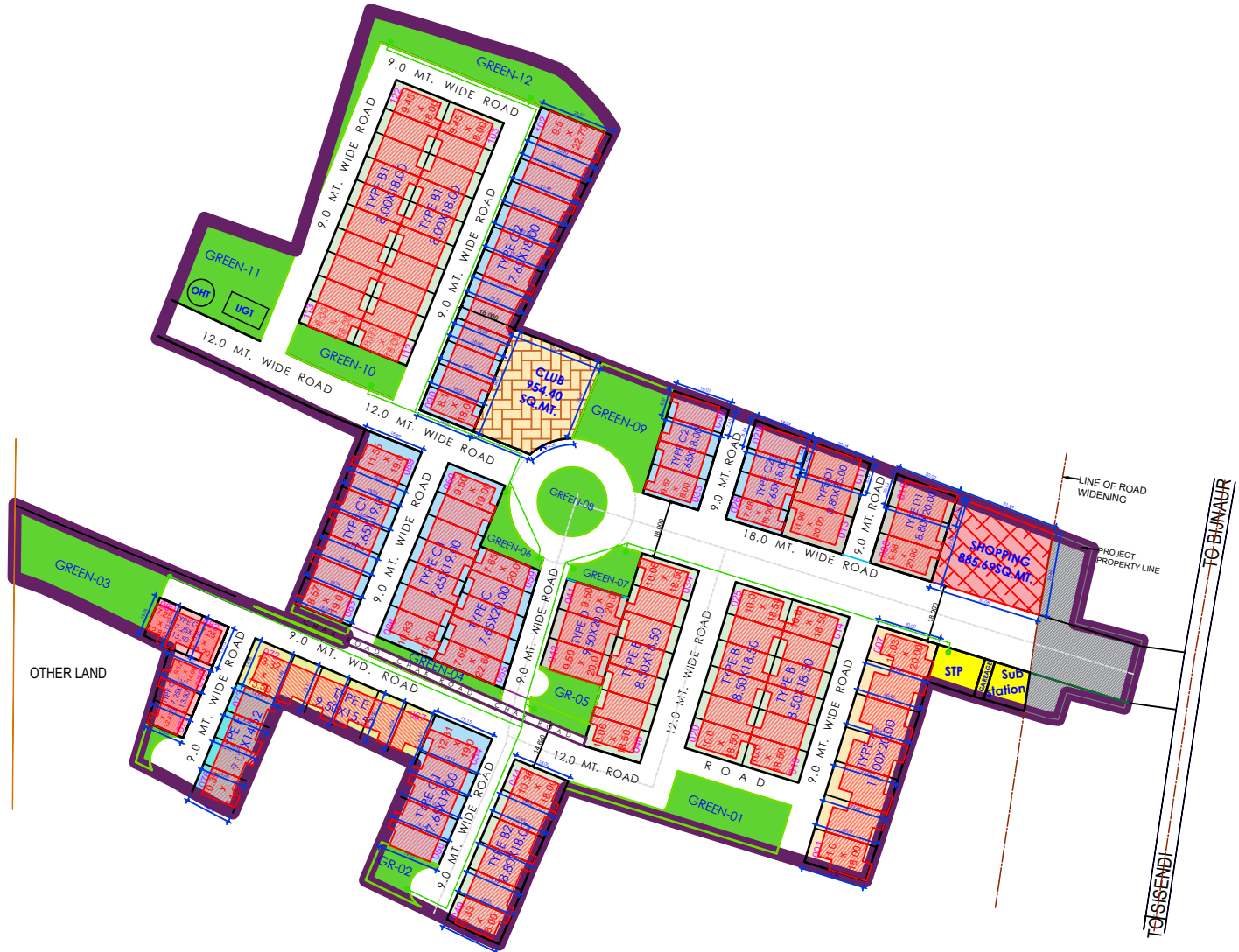

WATER SUPPLY (IRRIGATION) LAYOUT

SERVICES DRAWING FOR APPROVAL

PROJECT TITLE: PROPOSED RESIDENTIAL TOWNSHIP AT VILLAGE - JAITIKHERA & NOORNAGAR BHADRASA, PARGANA - BIJNAUR, TEHSIL-SAROJINI NAGAR, LUCKNOW		DIRECTION: 	LAND DETAILS: KHASRA NO: 1026, 1027, 1028, 1029sa, 1031, 1032, 1033, 1035, 1036, 1038, 1046, 1046/1.7.	DEVELOPER: HANSA KUMAR DEVELOPERS PRIVATE LIMITED 	ARCHITECT: Ar. Sanjay Kumar Gupta 108, F. Floor Corporate Chamber-1, Vishnu Khari Ganga Nagar, Lucknow-226010 Ph. No. 40809506, 04191740009 email: espaces.arch@gmail.com
Notes: <ul style="list-style-type: none"> OWNERSHIP OF THE SHOWN/LISTED LAND IS BEING VERIFIED BY THE DEVELOPER. ARCHITECT SHALL NOT BE RESPONSIBLE FOR ANY DISPUTE RELATED TO LAND OWNERSHIP. THIS DRAWING IS VALID ONLY IF SIGNED BY THE DEVELOPER. TO BE SUBMITTED BY THE DEVELOPER WITH A COMPETENT AUTHORITY ONLY FOR APPROVAL. 		SHEET NO.: services/01 DATE: 02.05.2025			