

FILE No- 608/15 (2012-13)  
ELECTRICAL DRAWING

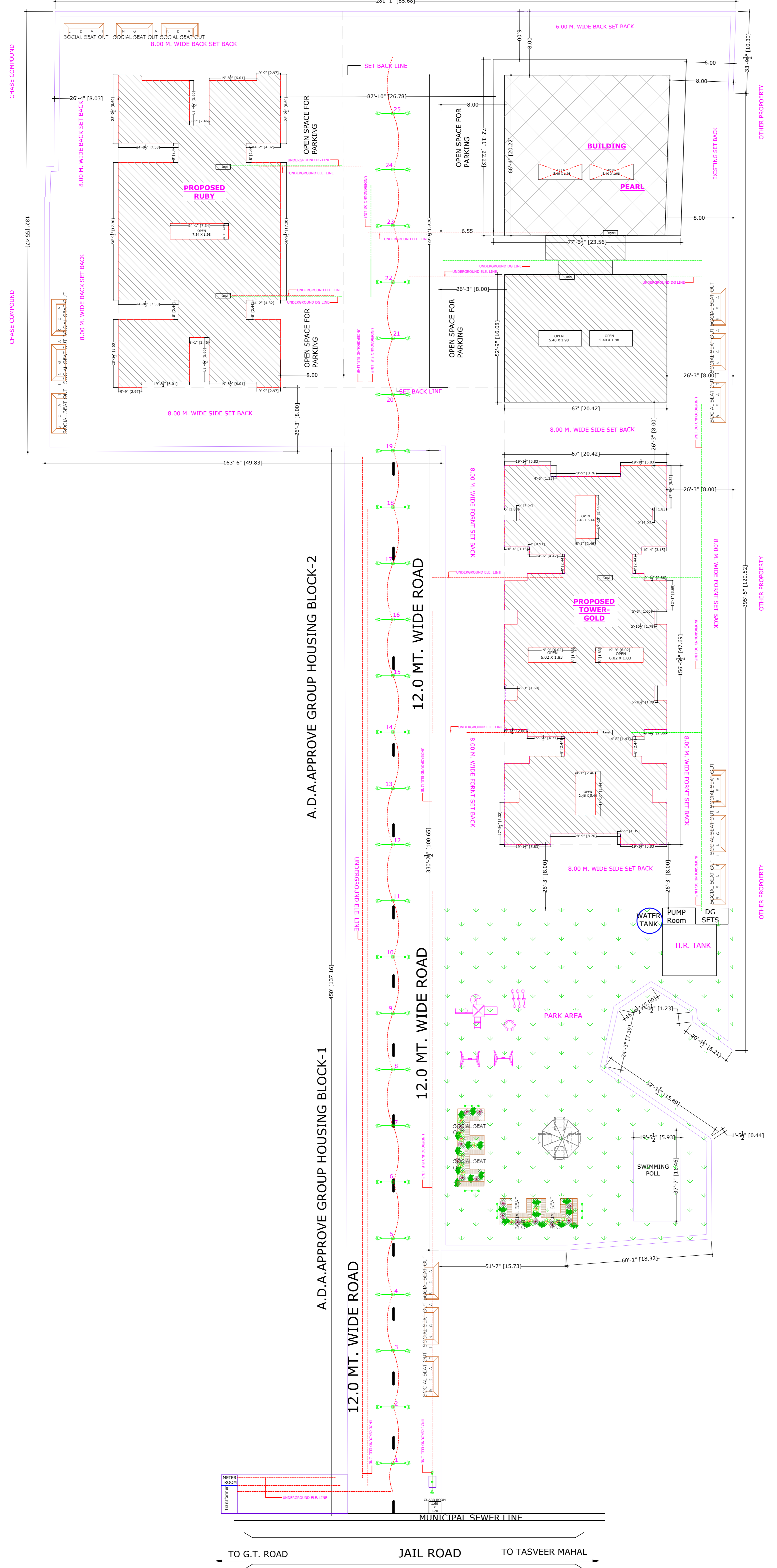

**EXISTING & PROPOSED REVISED GROUP HOUSING PLAN OF**  
**1.MRS. FAUZIA SHERWANI W/o LATE MR. NAIMULLAH KHAN 2.MR. NAJEEB SHERWANI 3.MR. NADEEM SHERWANI R/o.JAIL ROAD ALIGARH**

**SITE AT- KHASRA NO. 982/1, 978/2 KASBA KOIL, JAIL ROAD, ALIGARH.**

LEGEND			
PARTICULARS	SYMBOL	SYMBOL	PARTICULARS
PROPOSED WORK			R.W.H.S. - PLANT
EXISTING WORK			SEWER LINE/SEPTIC TANK
COMPOUND			NALI / DRAIN
TO BE DEMOLISH			WATER HEATING SYSTEM
TREE / LAWN			
R.W. PIPE			

NOTE - THE PROPOSED CONSTRUCTION PLAN IS ACCORDANCE WITH MASTER PLAN AND RULES & BYE LAWS MADE THERE UNDER SOLAR WATER HEATING SYSTEM ON TERRACE AS PER BYE LAWS

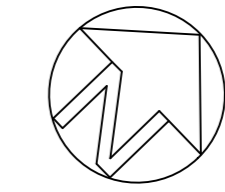
  
**AUTHORISED SIGNATORY**  
 1.MRS. FAUZIA SHERWANI  
 W/o LATE MR. NAIMULLAH KHAN  
 2.MR. NAJEEB SHERWANI  
 3.MR. NADEEM SHERWANI  
 R/o.JAIL ROAD ALIGARH  
**ENG./ARCH. SIGN.**

**SITE PLAN**

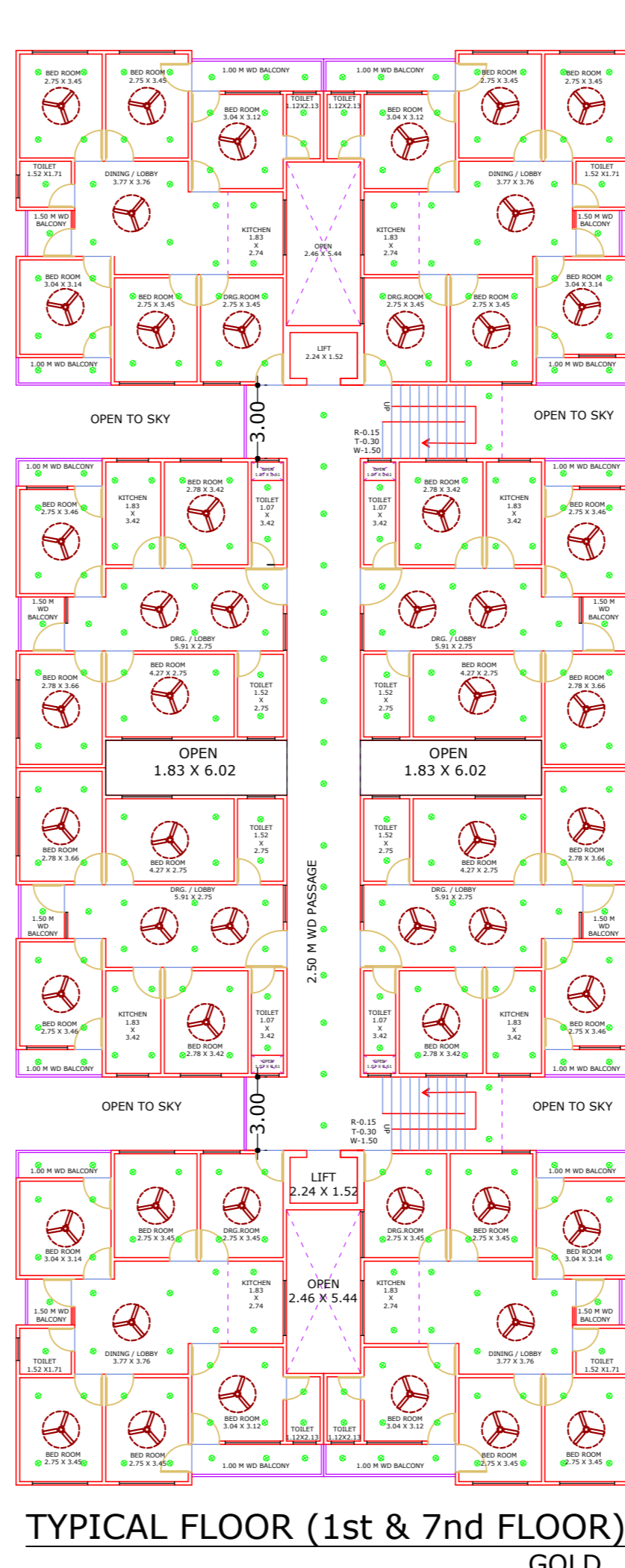
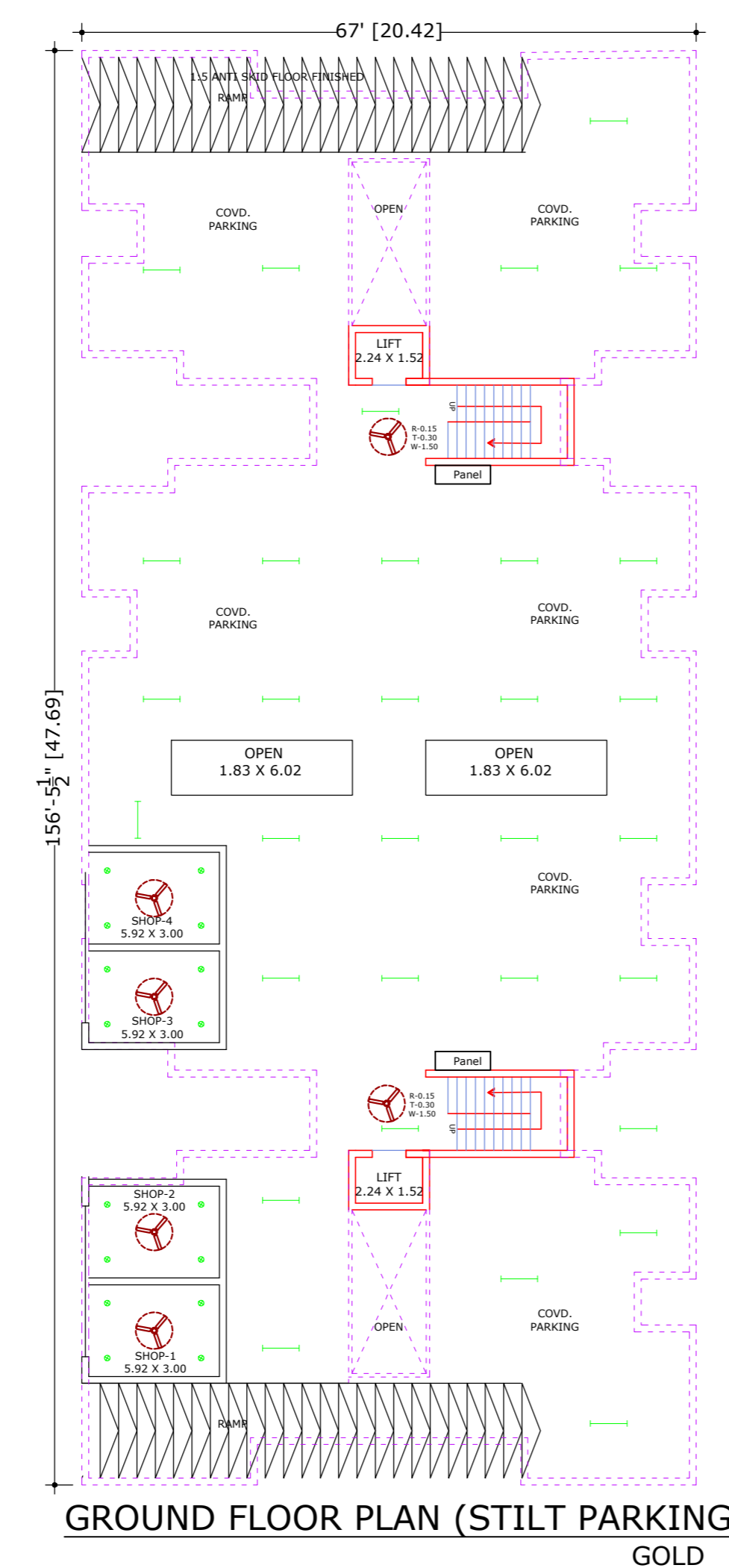
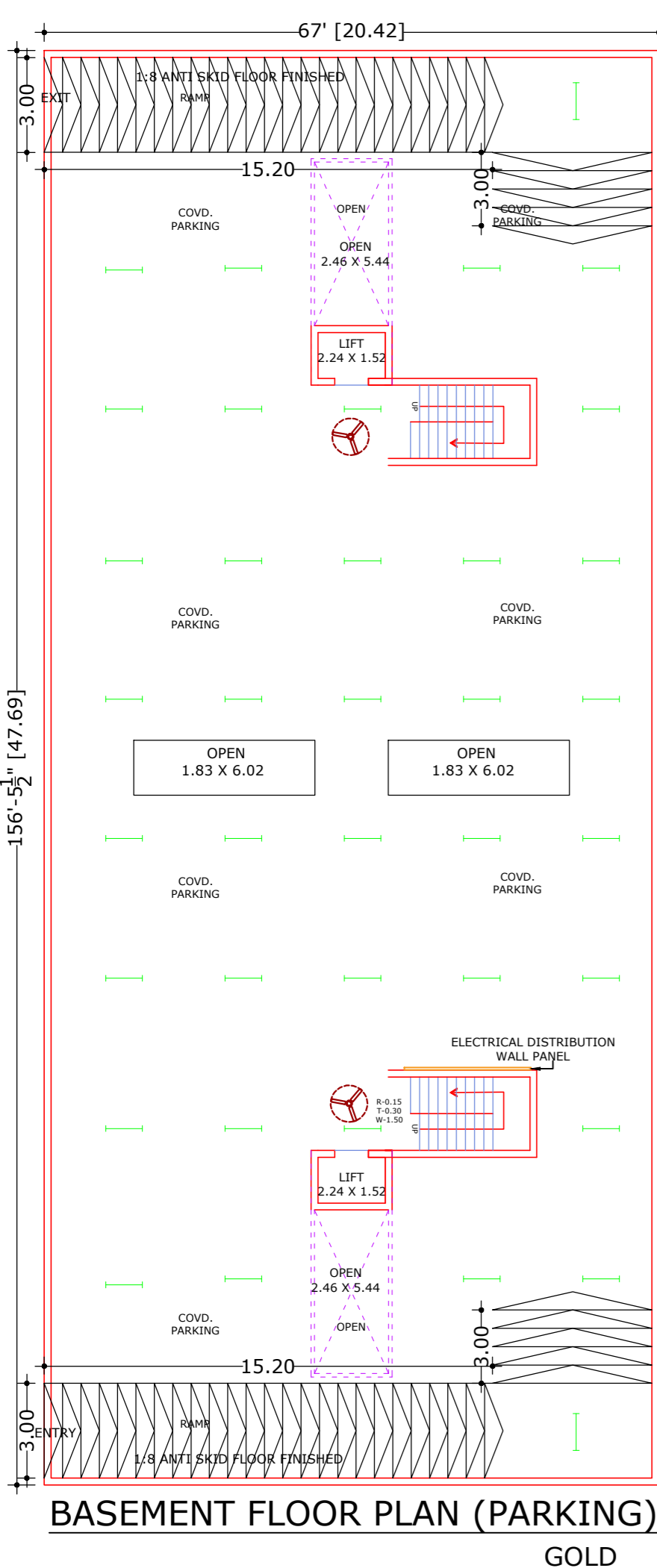
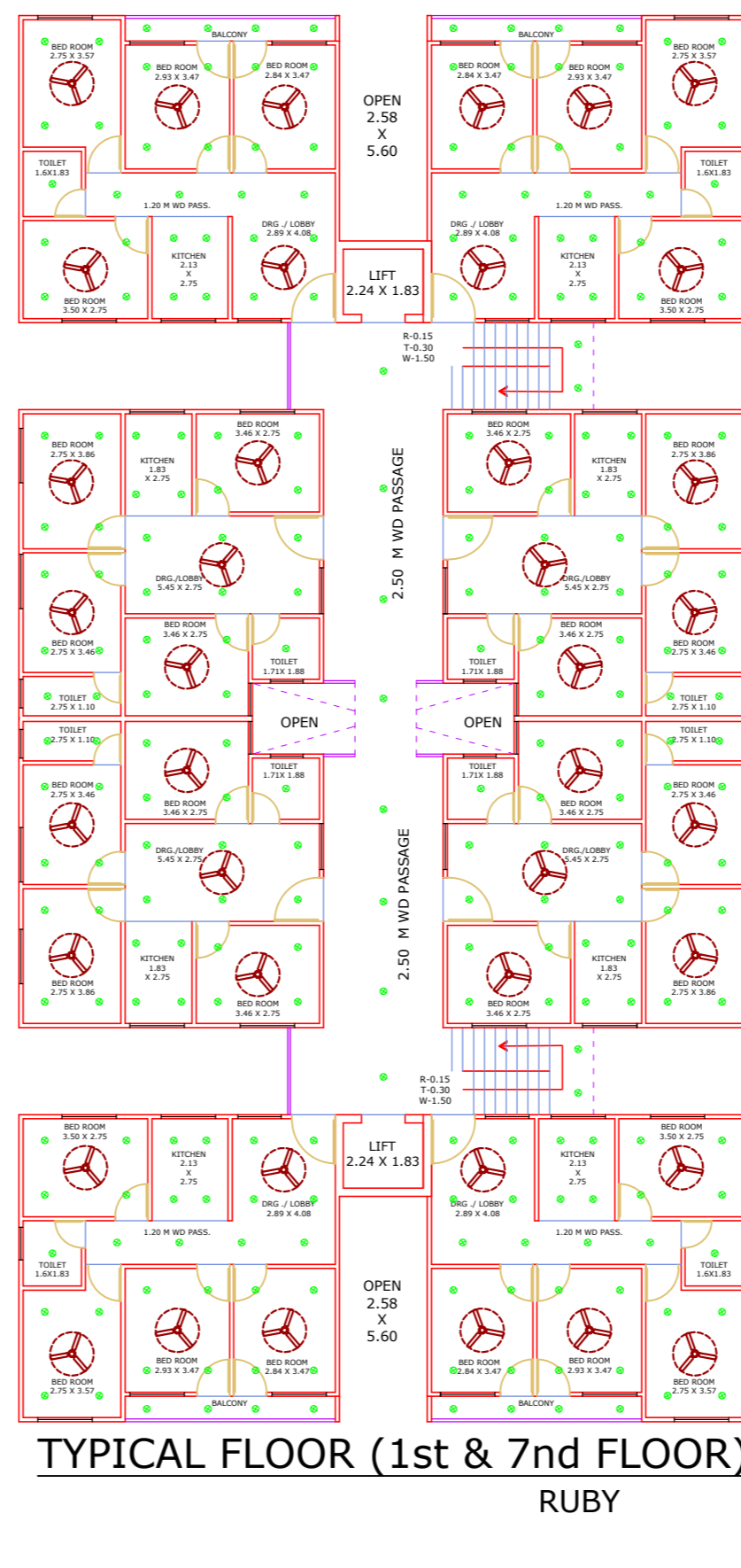
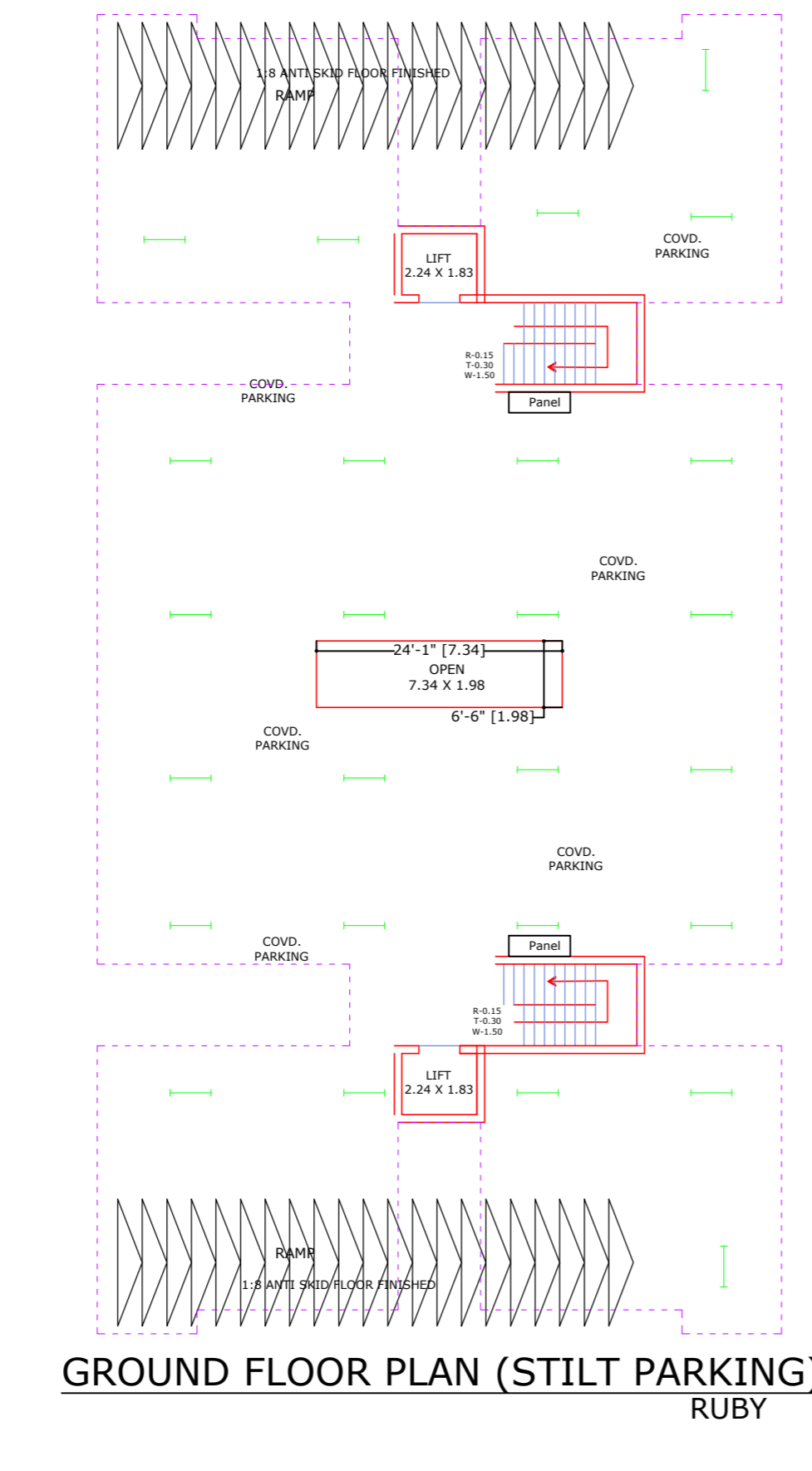
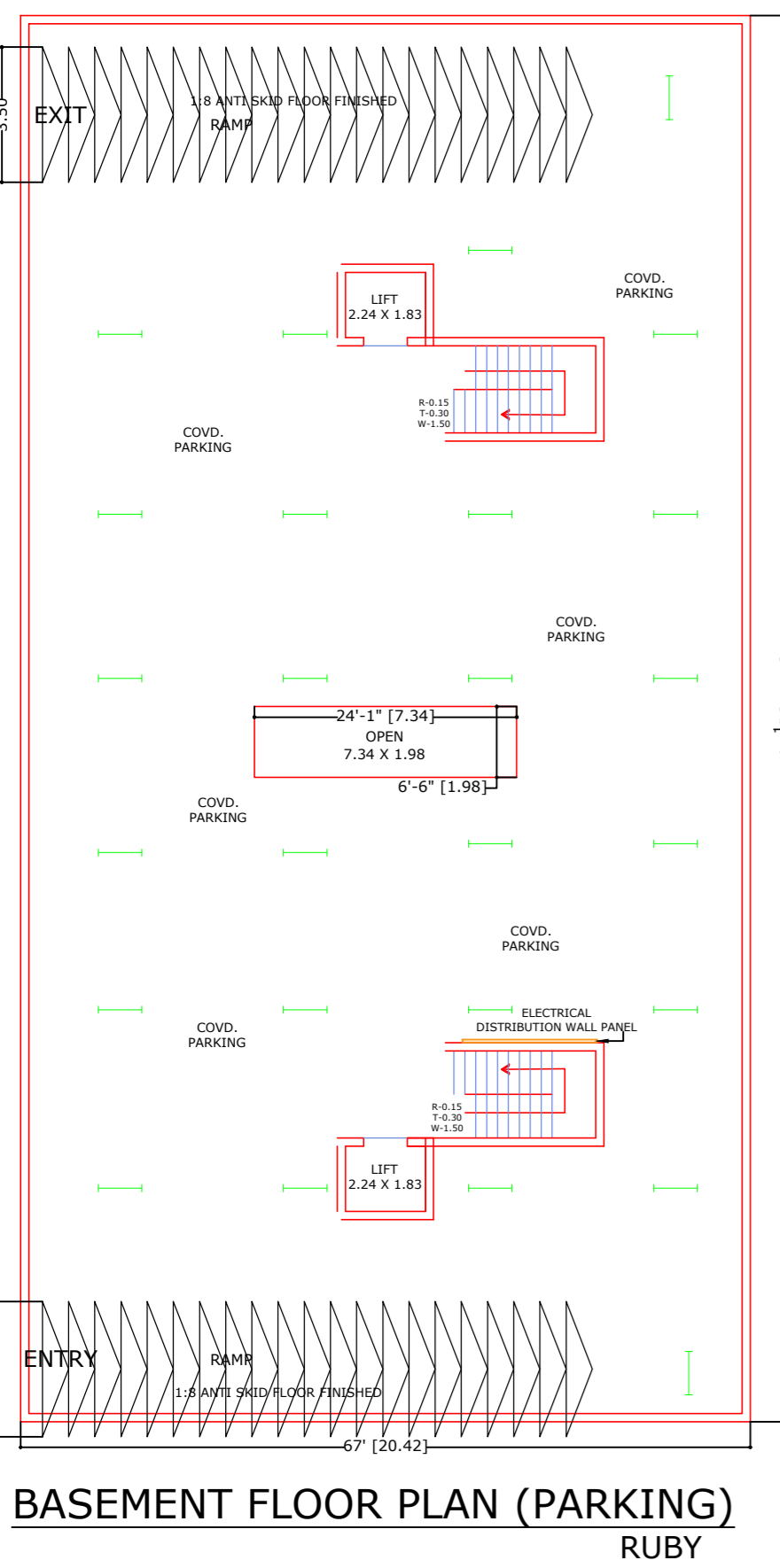
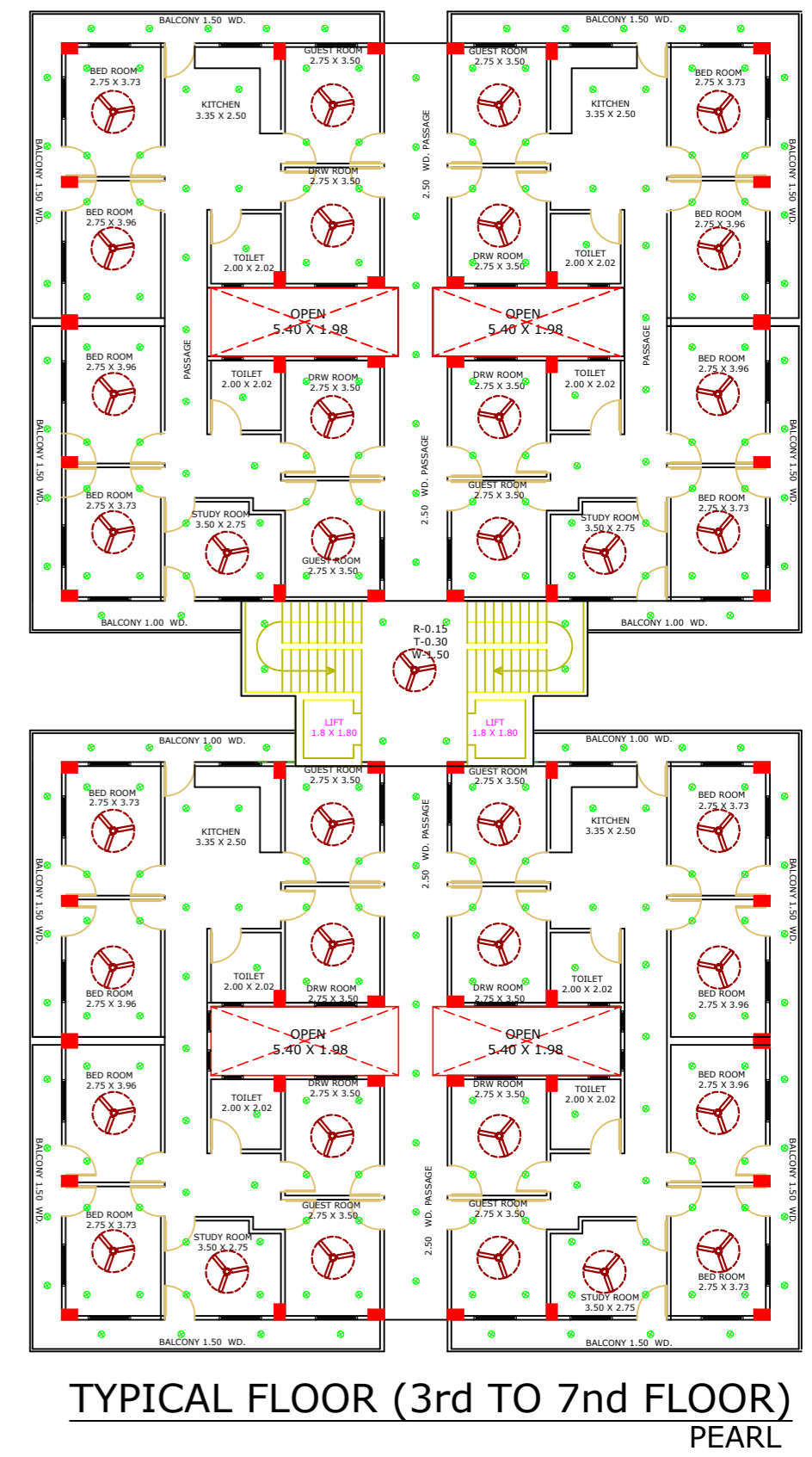
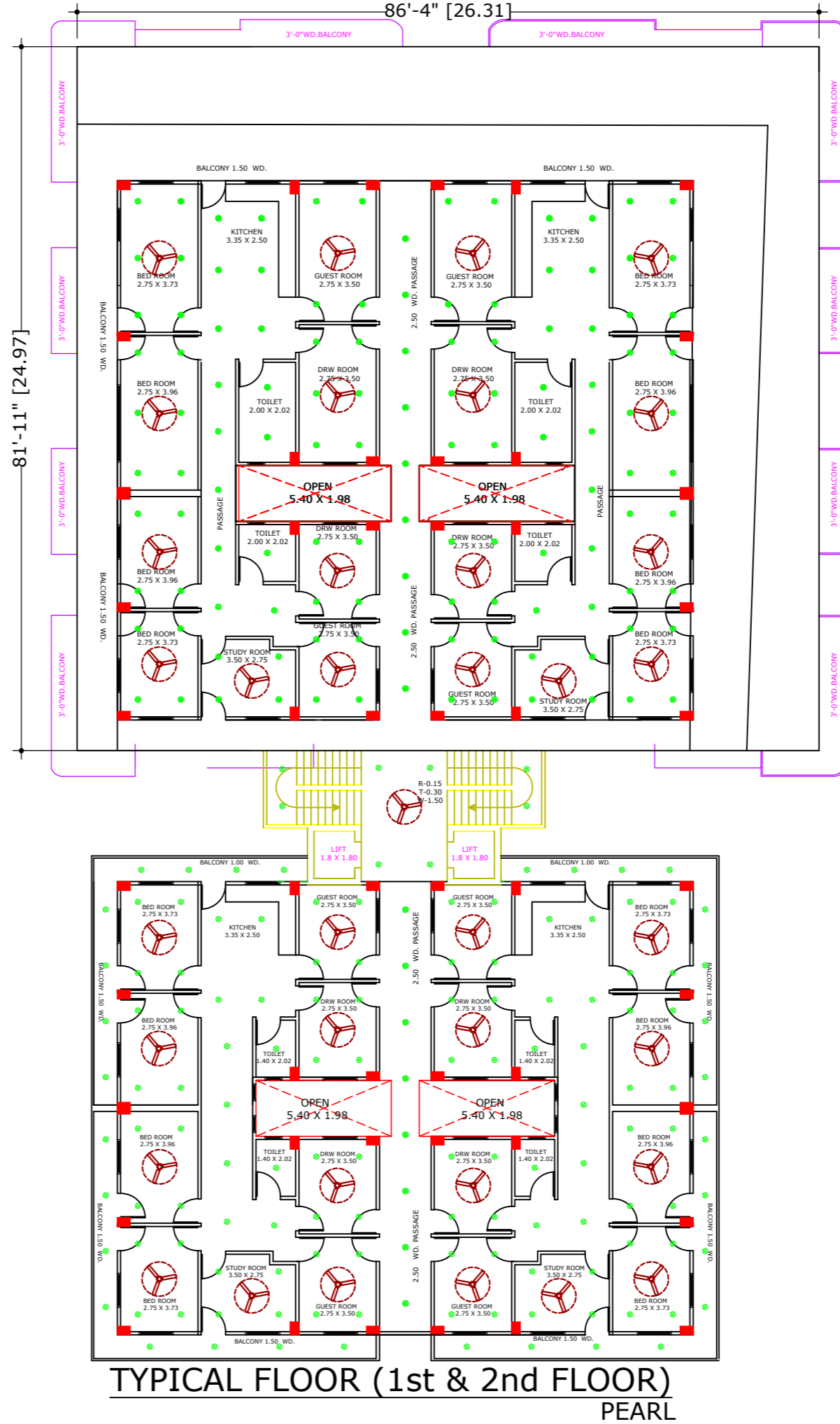
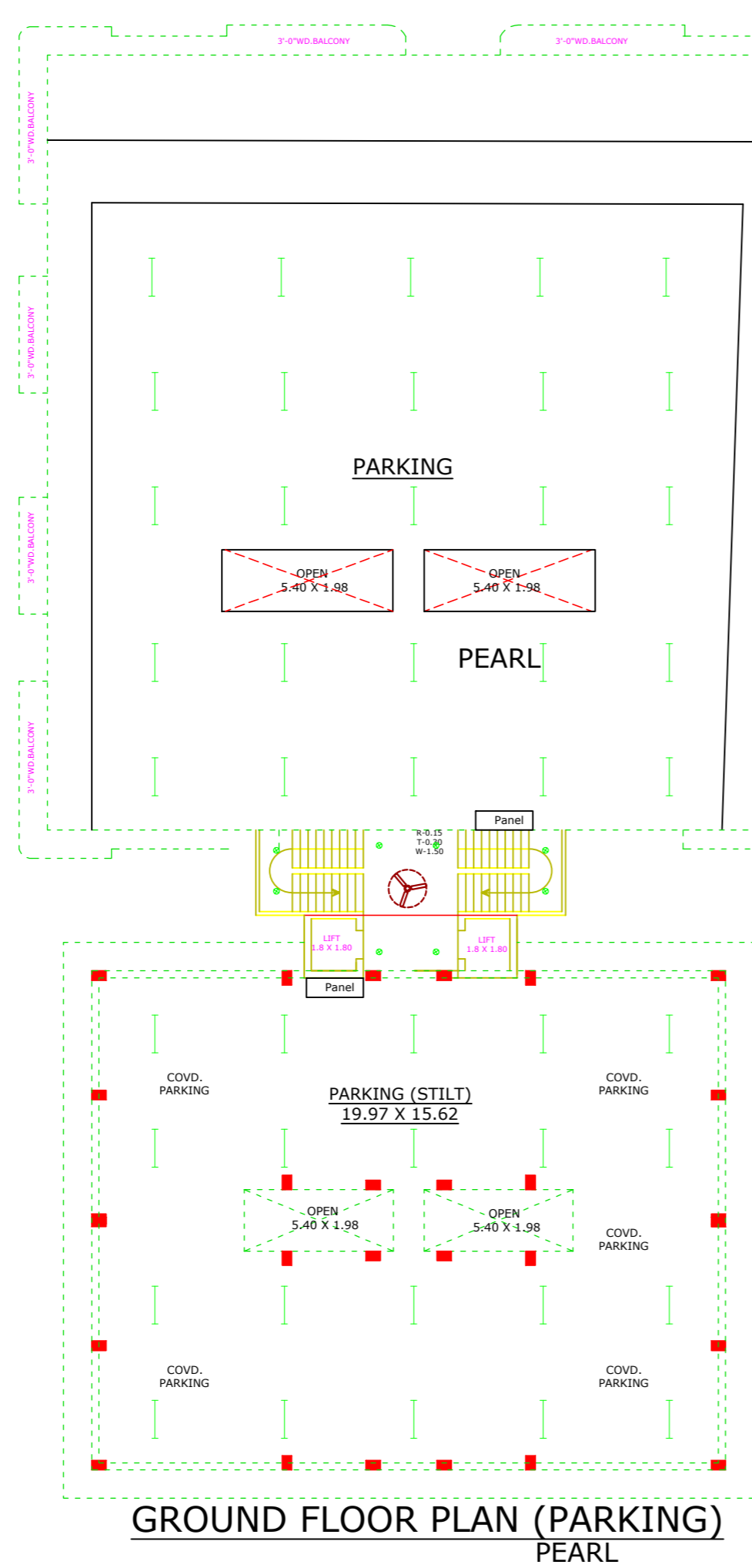
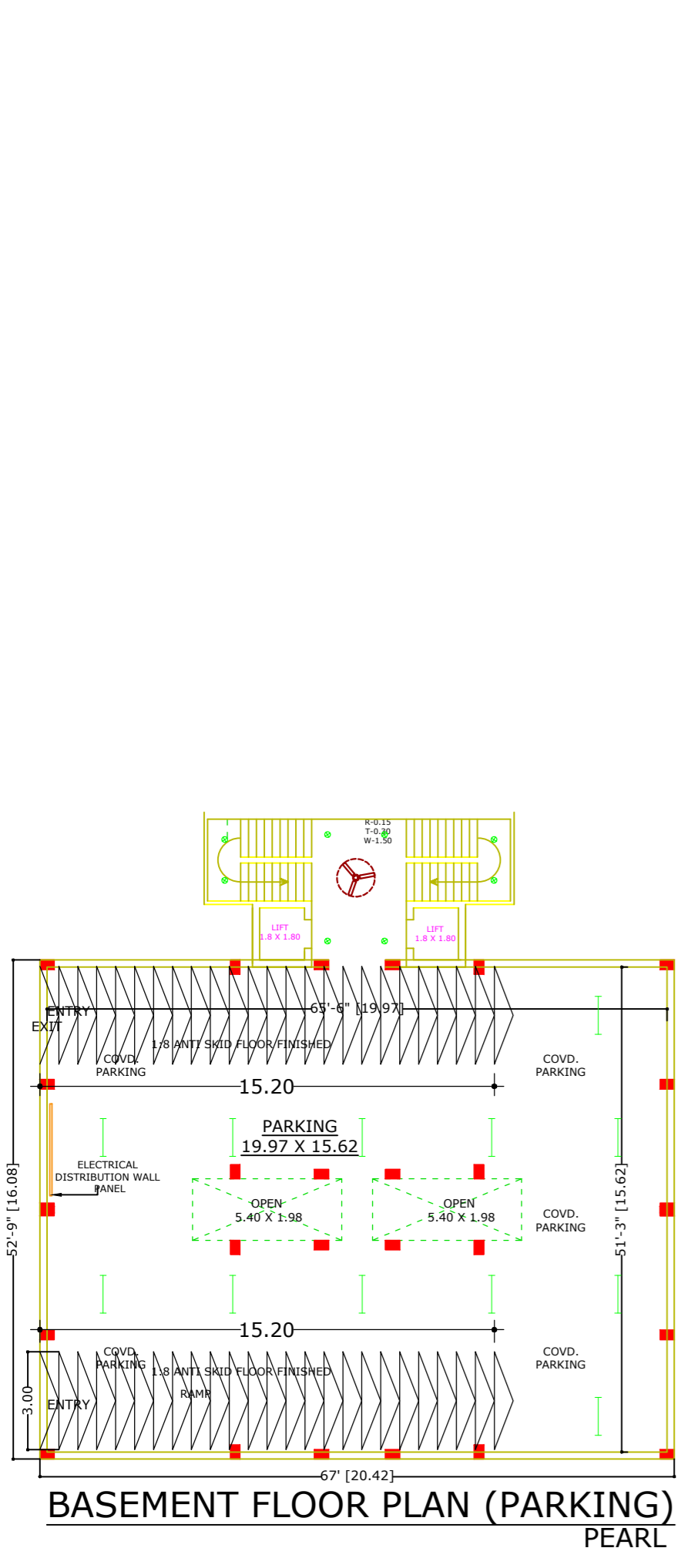

**FILE No- 608/15 (2012-13)  
ELECTRICAL DRAWING**

**EXISTING & PROPOSED REVISED  
GROUP HOUSING PLAN OF  
1.MRS. FAUZIA SHERWANI W/o LATE  
MR. NAIMULLAH KHAN 2.MR. NAJEEB  
SHERWANI 3.MR. NADEEM SHERWANI  
R/o.JAIL ROAD ALIGARH**

**SITE AT- KHASRA NO. 982/1, 978/2  
KASBA KOIL, JAIL ROAD, ALIGARH.**

**LEGEND**

PARTICULARS	SYMBOL	SYMBOL	PARTICULARS
PROPOSED WORK			R.W.H.S. - PLANT
EXISTING WORK			SEWER LINE/SEPTIC TANK
COMPOUND			NALI / DRAIN
TO BE LAWN			WATER HEATING SYSTEM
TREE / LAWN			
R.W. PIPE			

**NOTE -  
THE PROPOSED CONSTRUCTION PLAN IS PREPARED IN ACCORDANCE WITH MASTER PLAN AND  
RULES & BYE LAWS MADE THERE UNDER  
SOLAR WATER HEATING SYSTEM ON TERRACE AS PER BYE LAWS**

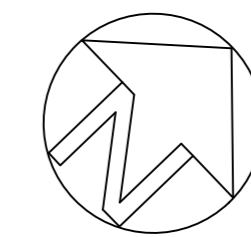

**AUTHORISED SIGNATORY**

- 1.MRS. FAUZIA SHERWANI  
W/o LATE MR. NAIMULLAH KHAN
- 2.MR. NAJEEB SHERWANI
- 3.MR. NADEEM SHERWANI  
R/o.JAIL ROAD ALIGARH

**ENG./ARCH. SIGN.**