

CLIENT

PROJECT  
**ELDECO LIVE BY THE GREENS  
 SC02/A9, SPORTS CITY,  
 SEC.150, NOIDA**

KEY PLAN

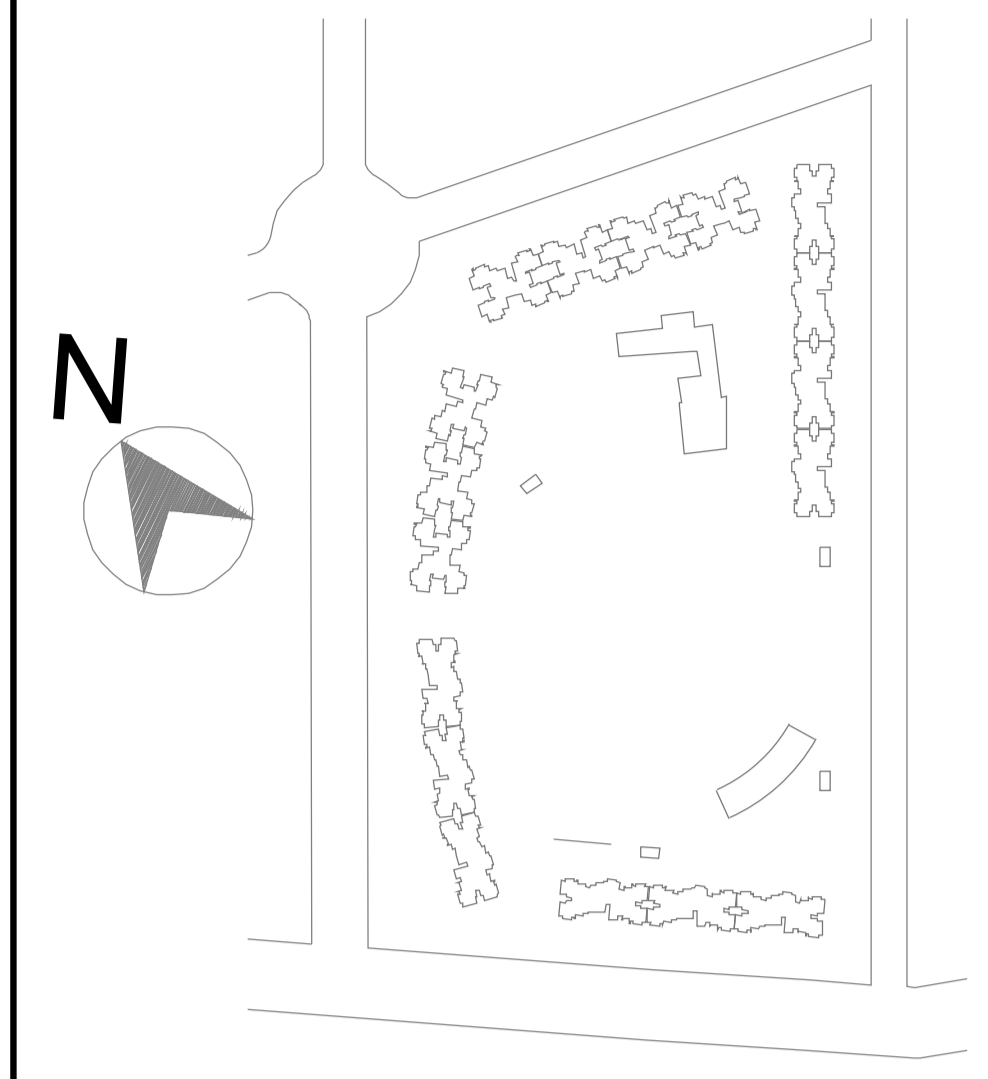

**PHASE - I  
 TOTAL PLOT AREA  
 = 24111.93 SQM**



**PHASE - II  
 TOTAL PLOT AREA  
 = 15572.26 SQM**

ELECTRICAL CONSULTANTS  
**AMPOWER CONSULTANCY SERVICES**  
 B-222, Second Floor, Naraina Industrial  
 Area Phase-I, New Delhi - 28, Phone - +91-11-2585772, +91-11-41414735

STRUCTURAL CONSULTANT  
**CE CON ENGG**  
 HS-25, Second Floor, Kalkaji Colony Market New Delhi-110048,  
 Phone - +91-11-41631766 Email: sssaaabb@gmail.com

PLUMBING & FIRE FIGHTING  
**C P Vidya and Associates** 312A, Unitech Arcadia, South City - II,  
 Sector 49, Gurgaon, Haryana - 122018 Phone - +91 124 4079336  
 e-mail: cpvidyaassociates@gmail.com

MEP CONSULTANTS  
**UDAYAN CHAUDHARI & ASSOCIATES PVT. LTD.**  
 40/60, 2nd floor Chittaranjan Park, New Delhi-110 019  
 Phone : 011-26471312, 26418363, 40529512  
 e-mail: udayanchaudhari@gmail.com

DRAWING NAME  
**WATER SUPPLY PLAN  
 BASEMENT FLOOR**

REVISION	SCALE	DATE
	NTS	09.04.2021

DRAWING NO.  
**ST-02**

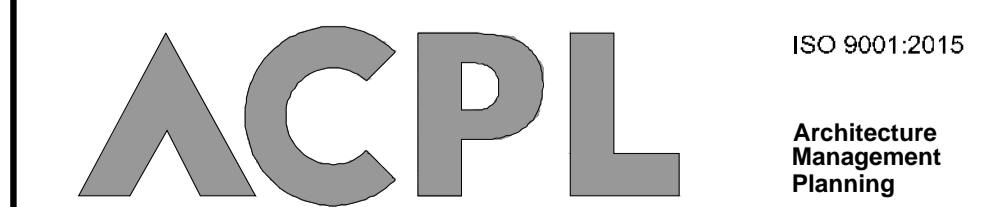

ACPL Design Ltd  
 E-24 South Extension - I T-91 11 2662195  
 New Delhi 110009, India +91 11 26467009  
 www.acplindia.com E:cosav@acplindia.com F:+91 11 26534000

**ELDECO LIVE BY THE GREENS-PHASE-2**