



FILE NO.		SHEET	<b>01</b>
SUBMISSION DATE		SCALE	1:200

**Phase - 1 Residential Apartment Applied for UP RERA Registration Land Area 7087 sqm approx**

**Phase - 2 Commercial Complex cum Hotel (Future Development) Land Area 3421 sqm approx**

**Limited Common Area for Fire tender movement in case of Fire Emergencies**

**Purvanchal Royal Atlantis Phase - 1 Residential Apartment Applied for UP RERA Registration Land Area 7087 sqm approx.**

**Limited Common Area or Fire tender movement in case of Fire Emergencies**

**Phase - 2 Commercial Complex cum Hotel (Future Development) Land Area 3421 sqm approx.**

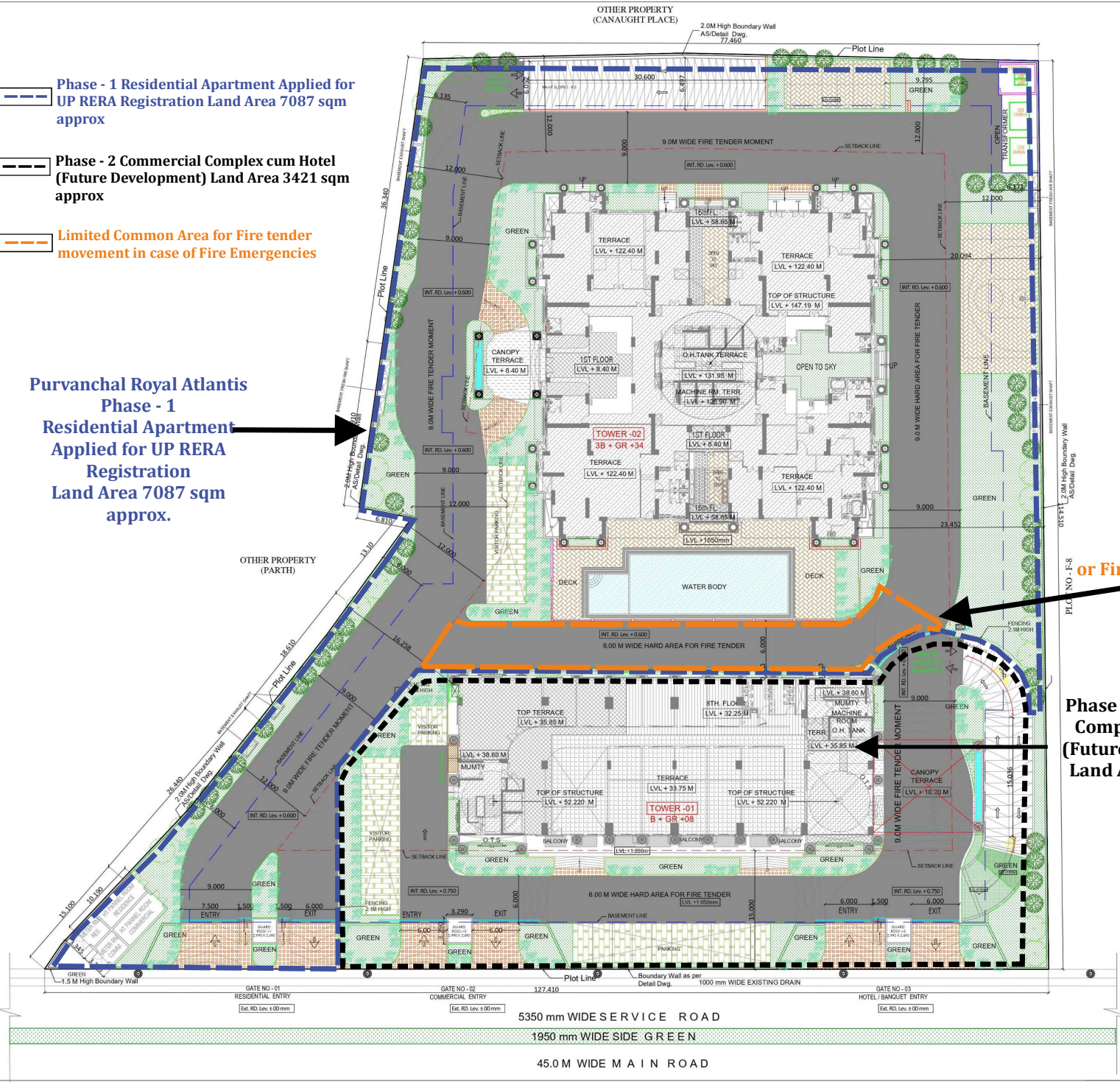

CLIENT :- M/S PURVANCHAL PROJECTS PVT.LTD.	
PROJECT :- PROPOSED COMMERCIAL/ RESIDENTIAL "PURVANCHAL ROYAL ATLANTIS" AT PLOT NO-F-7, C.G. CITY, CHAK GANAJIARIA, SULTANPUR ROAD, LUCKNOW, U.P	
TITLE :- <b>LANDSCAPE LAYOUT PLAN</b>	
OWNER'S SIGN  For PURVANCHAL PROJECTS PVT.LTD. D. J. S. Singh (Planning & Business Promoter)	ARCHITECT SIGN  A. PARTHA & L.L. CAVALRY 11713 209-C, Mayapuri, South Delhi New Delhi 110049
Building Plan Application Number	
Sanctioned On	
Valid Till	
Approved By	
Examined By	

ARCHITECT :-  
**DEVELOPMENTS CONSULTANT**  
(Architects, Engineers, Urban Designers)  
209-C, Mayapuri, (Opp. R-Block, South Extn-I),  
New Delhi - 110 049  
Ph:- +91 - 11 - 2629 4880 / 49408894