

OTHER'S PLOT

OTHER'S PLOT

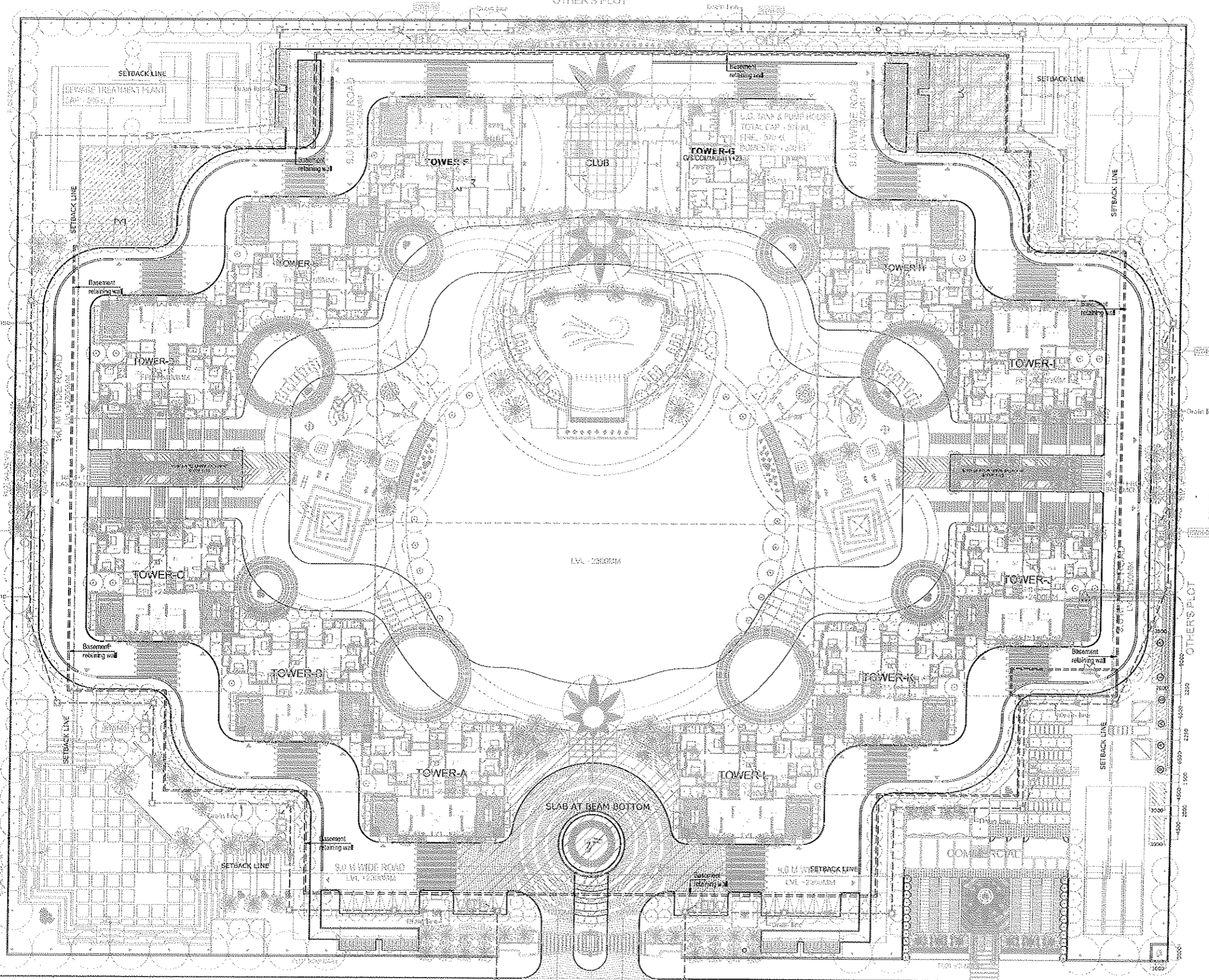

LEGEND :

S. No.	SYMBOL	DESCRIPTION
1.	CA	CATCHPIE
2.	---	UNDER GROUND PPF DRAIN
3.	---	RAIN WATER HARVESTING
4.	---	BASEMENT RETAINING WALL
5.		

Rev. No.	Date	Revision

Project :
PROPOSED GROUP HOUSING
 At Plot No. SC-02D, Sector - 150, NOIDA.
 FOR - SAMRIDHI LUXIRIYA

Title :
LAYOUT PLAN

Subtitle :
EXTERNAL DRAINAGE SYSTEM

Drawing Released For :

<input type="checkbox"/> APPROVAL	<input checked="" type="checkbox"/> RERA SUBMISSION
<input type="checkbox"/> ADVANCE COPY	<input type="checkbox"/> CONSTRUCTION

Drg. No : **SAMRIDHI LUXIRIYA - ES-02**

Scale : 1:400 Drawn By : Baldev

Date : July 2018 Design By : Sanjay Goyal

Ckd By : Anand Havella

Architects :
DEEPAK MEHTA & ASSOCIATES
 ARCHITECTS, PLANNERS, VALUERS, LANDSCAPE & INTERIORS
 114, 2nd FLOOR, PLOT NO. 14, AMBUSHKHA PLAZA, I.S.C. MAYAPUR VILLAGE PH - I,
 DELHI - 110051, INDIA, TEL (011) 431-2277/2440, 91-9999241713,
 Email : deepakmehta1962@gmail.com, Website : www.dmeaarchitects.co.in

Services Consultant :
Consummate Engineering Services (P) Ltd.
 B-17, Sector-61, Noida - 201305
 Tel: 0120 8113300
 E-mail : es@cespln.in, Website : www.cespln.in