

part thereof may not be used or reproduced without the permission of the Architect

| NO. OF PRINT | DATE | ISSUED TO | REMARKS |
|--------------|------|-------------|---------|
| | | | |
| REVISION | DATE | DESCRIPTION | BY |
| | | | |

GENERAL NOTES:
 1. ANY HABITABLE ROOM, TOILET, KITCHEN ETC. IF IT IS NOT NATURALLY VENTILATED WILL BE MECHANICALLY VENTILATED.
 2. FIRE STAIRCASE IS OF PRESSURISED TYPE AS PER N.B.C.
 3. BASEMENT WILL BE MECHANICALLY VENTILATED

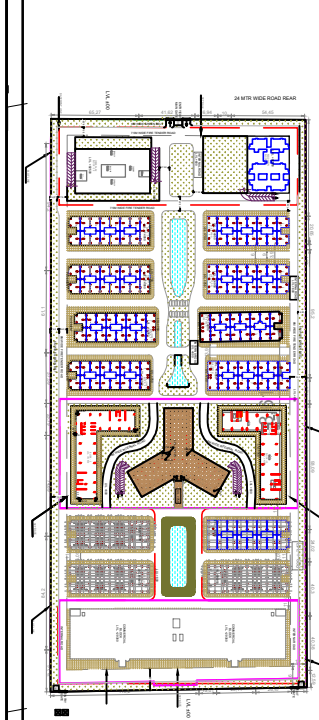

- COMMERCIAL F.A.R
- I.T F.A.R
- INSITUTIONAL F.A.R
- SERVICE F.A.R
- RESIDENTIAL F.A.R

REVISED DRAWING

CLIENT
 ELEGANT IT SOLUTIONS PRIVATE LIMITED

PROJECT
 PROPOSED IT PARK FOR M/s ELEGANT IT SOLUTIONS PRIVATE LIMITED
 Plot no. - 4, Sector-K.P.- 5, Greater Noida U.P.

| | | |
|--------------|--------------------------|---------------------------|
| DATE | PROJECT INCHARGE | CHECKED BY |
| NOT TO SCALE | DEALT BY TUSHAR SINGH | APPROVED BY B.K. SINGH |

DRAWING TITLE
SITE PLAN

OWNER SIGN
 ARCHITECT SIGN

ARCHITECTS

Devshilpi Architects LLP.
 110 The Park, Sector-4, Greater Noida, U.P.

DRAWING NO. **SD-03** REVISION

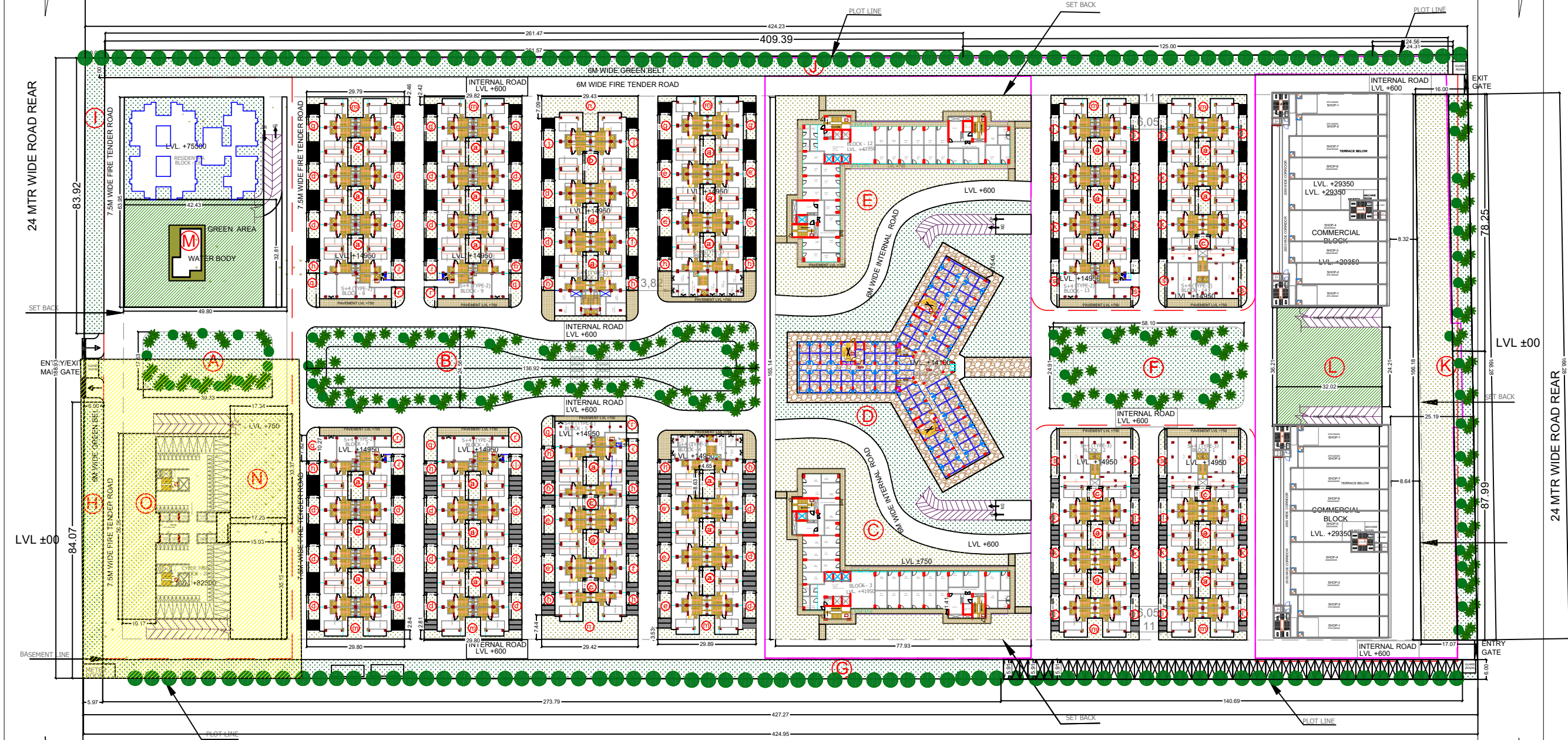

| | |
|-------------------------------------|------|
| EXTERNAL ROAD LEVEL | ±00 |
| INTERNAL ROAD LEVEL | +600 |
| PAVEMENT ROAD LEVEL | +750 |
| PLINTH LEVEL (EXCEPT COMMERCIAL) | +900 |

| NO. | REVISIONS | DATE | BY |
|-----|-------------------|------------|-----|
| 1 | ISSUED FOR PERMIT | 2024-08-01 | AKS |
| 2 | REVISED AS PER | 2024-08-05 | AKS |
| 3 | REVISED AS PER | 2024-08-10 | AKS |
| 4 | REVISED AS PER | 2024-08-15 | AKS |
| 5 | REVISED AS PER | 2024-08-20 | AKS |
| 6 | REVISED AS PER | 2024-08-25 | AKS |
| 7 | REVISED AS PER | 2024-09-01 | AKS |
| 8 | REVISED AS PER | 2024-09-05 | AKS |
| 9 | REVISED AS PER | 2024-09-10 | AKS |
| 10 | REVISED AS PER | 2024-09-15 | AKS |
| 11 | REVISED AS PER | 2024-09-20 | AKS |
| 12 | REVISED AS PER | 2024-09-25 | AKS |
| 13 | REVISED AS PER | 2024-10-01 | AKS |
| 14 | REVISED AS PER | 2024-10-05 | AKS |
| 15 | REVISED AS PER | 2024-10-10 | AKS |
| 16 | REVISED AS PER | 2024-10-15 | AKS |
| 17 | REVISED AS PER | 2024-10-20 | AKS |
| 18 | REVISED AS PER | 2024-10-25 | AKS |
| 19 | REVISED AS PER | 2024-11-01 | AKS |
| 20 | REVISED AS PER | 2024-11-05 | AKS |
| 21 | REVISED AS PER | 2024-11-10 | AKS |
| 22 | REVISED AS PER | 2024-11-15 | AKS |
| 23 | REVISED AS PER | 2024-11-20 | AKS |
| 24 | REVISED AS PER | 2024-11-25 | AKS |
| 25 | REVISED AS PER | 2024-12-01 | AKS |
| 26 | REVISED AS PER | 2024-12-05 | AKS |
| 27 | REVISED AS PER | 2024-12-10 | AKS |
| 28 | REVISED AS PER | 2024-12-15 | AKS |
| 29 | REVISED AS PER | 2024-12-20 | AKS |
| 30 | REVISED AS PER | 2024-12-25 | AKS |

