

File No	AFDALDGA-25053	Sheet	1/4
Submission Date	2025-03-25	Scale	1:100
Version No.	1/01	Version Date	27/02/2025
<b>AREA STATEMENT</b>			
PROJECT DETAIL			
Authority	Ayodhya Faizabad Development Authority	Plot User	Residential
Authority Class	Category D	Plot Sub-Use	Plotted Area Development / Plotted Housing
Authority Grade	Development Authority (DA)	Development Plan	Master Plan
Case Track	Regular	Land Use Zone	Residential Use Zone
Project Type	Layout Development	Land Sub-Use Zone	Residential Zone
Name of Development	NSR	Layout Type	NSR
Development Area	Undeveloped Area		
Sub-Development Area	Village Area		
Special Project	NA		
Site Address	Kansal Ayodhya, Tehsil Sohawal, Village Haripur Jalalabad		
<b>AREA DETAILS</b>			
Area of Plot As per record	56.16		
Document Area	19616.16		
As per site condition	19616.16		
Area of Plot Considered	19429.08		
<b>2. Deduction for</b>			
(a) Proposed roads	187.08		
(b) Road Widening Area	187.08		
(c) Any reservations	0.00		
Total (a + b + c)	374.16		
Net Area of plot (1 - 2) AREA OF PLOT	19429.08		
Road Widening Area	187.08		
Green and open space	3052.77		
<b>3. Proposed FAR</b>			
Proposed Built up	Proposed FAR	Existing FAR	Existing FAR
Total Area	0.00	0.00	0.00
Total FAR Area	0.00	0.00	0.00
Total Built-up Area	0.00	0.00	0.00
Proposed FAR consumed	0.00	0.00	0.00
<b>C. Tenement Statement</b>			
4. Tenement Proposed At:			

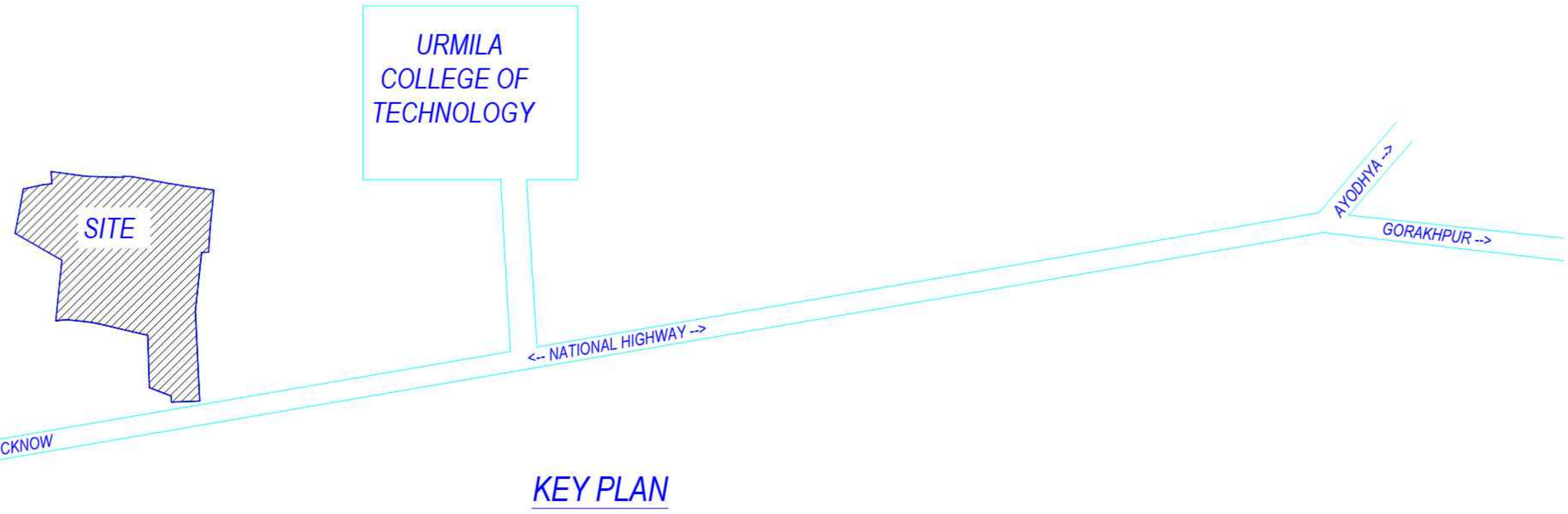
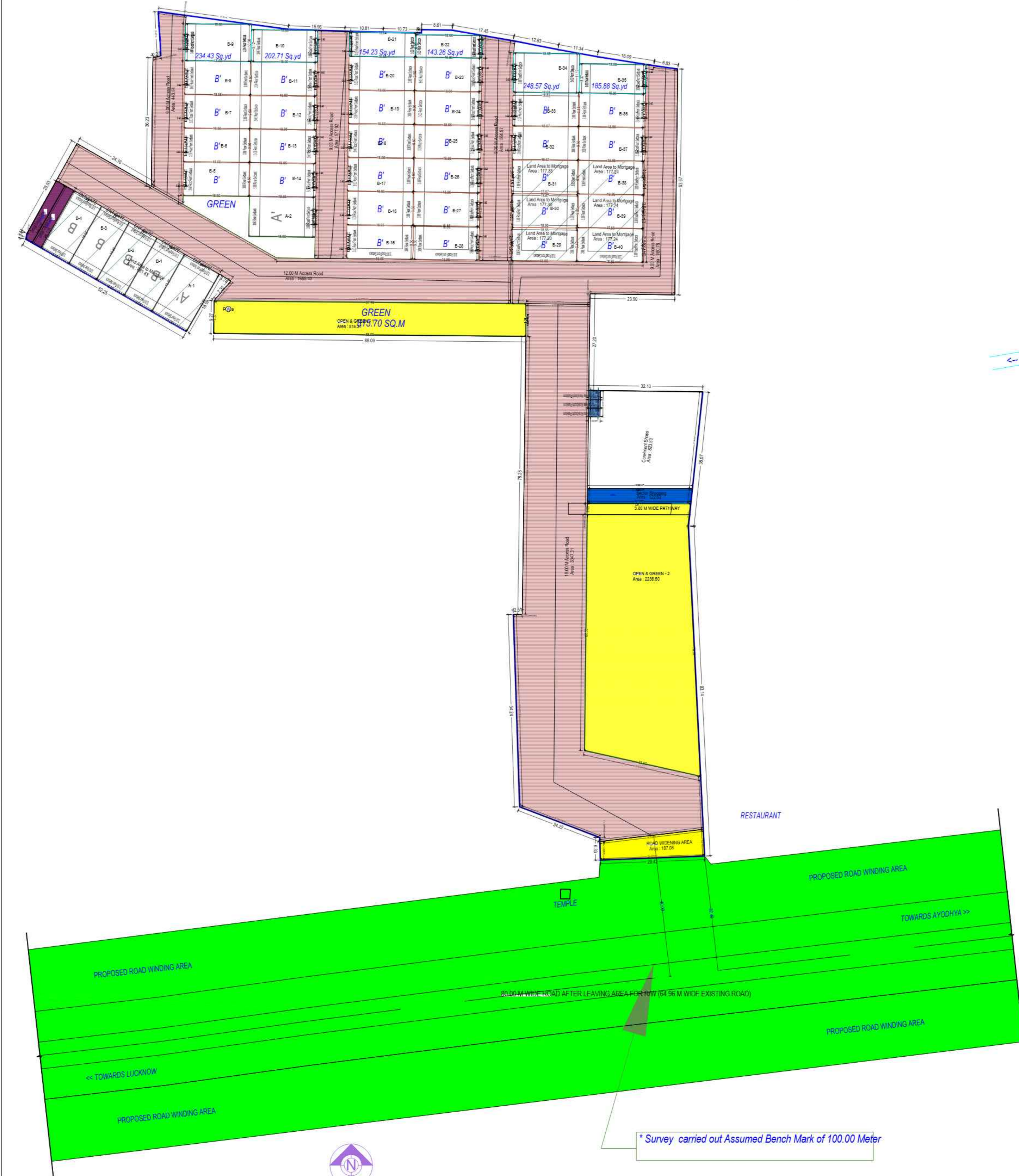

<b>COLOR INDEX</b>	
FLIGHT BOUNDARY	Red
ADJUTING ROAD	Green
PROPOSED CONSTRUCTION	Yellow
COMMON PLOT	Blue
ROAD ALIGNMENT (ROAD WIDENING AREA)	Orange
FUTURE T.P. SCHEME DEDUCTION AREA	Purple
EXISTING (To be retained)	Light Blue
EXISTING (To be demolished)	Dark Blue

<b>Number of EWS/LIG unit required</b>					
Sl. No.	Plot Type	No. of Plot	No. of unit in one plot	Total Number of unit	Proposed LIG/ EWS Unit
1.	Single Dwelling Unit	42	1	42	-
Total:		42		42	-
Number of EWS/LIG unit required (10% LIG)					
				5.00	0
Number of EWS/LIG unit required (10% EWS)					
				5.00	0
Total:		42		52	0

<b>Temenents Density Check</b>					
Net housing density	No. Of Temenents		No. Of Persons		
	Repl	Prop	Repl	Prop	Prop
750/Hec	-	292	164	-	1458
Green and open space Area					
				Repl	Prop
				616.27	2236.50

<b>Land use analysis/Area distribution (Table 2c)</b>		
Area covered under	Proposed Area in sq. mt	Percentage(%)
Plotted Area	7952.57	38.85
Road Area	7956.61	38.54
Garbage Collection Center	51.06	0.26
Garbage Collection Center	53.88	0.28
For informal Area	8.15	0.04
Kiosk/booth/Platform	8.16	0.04
For informal Area	8.16	0.04
Kiosk/booth/Platform	122.83	0.63
Convenient Shops	823.80	4.04
Public Open Space	3062.77	12.17
Other Area	341.29	1.76
Total net layout	19429.08	100.00

<b>Individual Amenity Check (b)</b>					
Name	Repl	Prop	Repl	Prop	Prop
Convenient Shops	20.00	823.80	-	-	1.00
Sector Shopping	100.00	122.83	-	-	1.00
For informal Area	15.00	24.46	-	-	3.00
Garbage Collection Center	15.00	104.53	1.00	2.00	

<b>Individual Plot Area</b>										
Plot No.	Abutting Road	Plot Area	Frontage	Coverage	FAR Area					
B-4	12.00 M Access Road	40.00	167.93	3.50	9.00	0.00	0.00	0.00	0.00	0.00
B-3	12.00 M Access Road	40.00	167.92	3.50	9.00	0.00	0.00	0.00	0.00	0.00
B-2	12.00 M Access Road	40.00	167.93	3.50	9.00	0.00	0.00	0.00	0.00	0.00
B-1	12.00 M Access Road	40.00	167.97	3.50	9.00	0.00	0.00	0.00	0.00	0.00
A-1	12.00 M Access Road	40.00	209.92	3.50	11.25	0.00	0.00	0.00	0.00	0.00
B-5	9.00 M Access Road	40.00	197.00	3.50	10.55	0.00	0.00	0.00	0.00	0.00
B-8	9.00 M Access Road	40.00	177.27	3.50	9.50	0.00	0.00	0.00	0.00	0.00
B-7	9.00 M Access Road	40.00	177.27	3.50	9.50	0.00	0.00	0.00	0.00	0.00
B-6	9.00 M Access Road	40.00	177.27	3.50	9.50	0.00	0.00	0.00	0.00	0.00
B-5	9.00 M Access Road	40.00	177.27	3.50	9.50	0.00	0.00	0.00	0.00	0.00
A-2	9.00 M Access Road	40.00	209.93	3.50	11.25	0.00	0.00	0.00	0.00	0.00
B-14	9.00 M Access Road	40.00	177.27	3.50	9.50	0.00	0.00	0.00	0.00	0.00
B-13	9.00 M Access Road	40.00	177.27	3.50	9.50	0.00	0.00	0.00	0.00	0.00
B-10	9.00 M Access Road	40.00	177.27	3.50	9.50	0.00	0.00	0.00	0.00	0.00
B-11	9.00 M Access Road	40.00	177.27	3.50	9.50	0.00	0.00	0.00	0.00	0.00
B-12	9.00 M Access Road	40.00	177.27	3.50	9.50	0.00	0.00	0.00	0.00	0.00
B-13	9.00 M Access Road	40.00	177.27	3.50	9.50	0.00	0.00	0.00	0.00	0.00
B-10	9.00 M Access Road	40.00	170.30	3.50	9.12	0.00	0.00	0.00	0.00	0.00
B-11	9.00 M Access Road	40.00	177.27	3.50	9.50	0.00	0.00	0.00	0.00	0.00
B-12	9.00 M Access Road	40.00	177.27	3.50	9.50	0.00	0.00	0.00	0.00	0.00
B-21	9.00 M Access Road	40.00	129.62	3.50	6.95	0.00	0.00	0.00	0.00	0.00
B-20	9.00 M Access Road	40.00	177.27	3.50	9.50	0.00	0.00	0.00	0.00	0.00
B-19	9.00 M Access Road	40.00	177.27	3.50	9.50	0.00	0.00	0.00	0.00	0.00
B-18	9.00 M Access Road	40.00	177.27	3.50	9.50	0.00	0.00	0.00	0.00	0.00
B-17	9.00 M Access Road	40.00	177.27	3.50	9.50	0.00	0.00	0.00	0.00	0.00
B-16	9.00 M Access Road	40.00	177.27	3.50	9.50	0.00	0.00	0.00	0.00	0.00
B-15	9.00 M Access Road	40.00	177.27	3.50	9.50	0.00	0.00	0.00	0.00	0.00
B-14	9.00 M Access Road	40.00	177.27	3.50	9.50	0.00	0.00	0.00	0.00	0.00
B-13	9.00 M Access Road	40.00	177.27	3.50	9.50	0.00	0.00	0.00	0.00	0.00
B-12	9.00 M Access Road	40.00	177.27	3.50	9.50	0.00	0.00	0.00	0.00	0.00
B-11	9.00 M Access Road	40.00	177.27	3.50	9.50	0.00	0.00	0.00	0.00	0.00
B-10	9.00 M Access Road	40.00	177.27	3.50	9.50	0.00	0.00	0.00	0.00	0.00
B-9	9.00 M Access Road	40.00	177.27	3.50	9.50	0.00	0.00	0.00	0.00	0.00
B-8	9.00 M Access Road	40.00	177.27	3.50	9.50	0.00	0.00	0.00	0.00	0.00
B-7	9.00 M Access Road	40.00	177.27	3.50	9.50	0.00	0.00	0.00	0.00	0.00
B-6	9.00 M Access Road	40.00	177.27	3.50	9.50	0.00	0.00	0.00	0.00	0.00
B-5	9.00 M Access Road	40.00	177.27	3.50	9.50	0.00	0.00	0.00	0.00	0.00
B-4	9.00 M Access Road	40.00	177.27	3.50	9.50	0.00	0.00	0.00	0.00	0.00
B-3	9.00 M Access Road	40.00	177.27	3.50	9.50	0.00	0.00	0.00	0.00	0.00
B-2	9.00 M Access Road	40.00	177.27	3.50	9.50	0.00	0.00	0.00	0.00	0.00
B-1	9.00 M Access Road	40.00	177.27	3.50	9.50	0.00	0.00	0.00	0.00	0.00
A-1	9.00 M Access Road	40.00	209.92	3.50	11.25	0.00	0.00	0.00	0.00	0.00
B-21	9.00 M Access Road	40.00	130.39	3.50	6.46	0.00	0.00	0.00	0.00	0.00
B-20	9.00 M Access Road	40.00	177.27	3.50	9.50	0.00	0.00	0.00	0.00	0.00
B-19	9.00 M Access Road	40.00	177.27	3.50	9.50	0.00	0.00	0.00	0.00	0.00
B-18	9.00 M Access Road	40.00	177.27	3.50	9.50	0.00	0.00	0.00	0.00	0.00
B-17	9.00 M Access Road	40.00	177.27	3.50	9.50	0.00	0.00	0.00	0.00	0.00
B-16	9.00 M Access Road	40.00	177.27	3.50	9.50	0.00	0.00	0.00	0.00	0.00
B-15	9.00 M Access Road	40.00	177.27	3.50	9.50	0.00	0.00	0.00	0.00	0.00
B-14	9.00 M Access Road	40.00	177.27	3.50	9.50	0.00	0.00	0.00	0.00	0.00
B-13	9.00 M Access Road	40.00	177.27	3.50	9.50	0.00	0.00	0.00	0.00	0.00
B-12	9.00 M Access Road	40.00	177.27	3.50	9.50	0.00	0.00	0.00	0.00	0.00
B-11	9.00 M Access Road	40.00	177.27	3.50	9.50	0.00	0.00	0.00	0.00	0.00
B-10	9.00 M Access Road	40.00	177.27	3.50	9.50	0.00	0.00	0.00	0.00	0.00
B-9	9.00 M Access Road	40.00	177.27	3.50	9.50	0.00	0.00	0.00	0.00	0.00
B-8	9.00 M Access Road	40.00	177.27	3.50	9.50	0.00	0.00	0.00	0.00	0.00
B-7	9.00 M Access Road	40.00	177.27	3.50	9.50	0.00	0.00	0.00	0.00	0.00
B-6	9.00 M Access Road	40.00	177.27	3.50	9.50	0.00	0.00	0.00	0.00	0.00
B-5	9.00 M Access Road	40.00	177.27	3.50	9.50	0.00	0.00	0.00	0.00	0.00
B-4	9.00 M Access Road	40.00	177.27	3.50	9.50	0.00	0.00	0.00	0.00	0.00
B-3	9.00 M Access Road	40.00	177.27	3.50	9.50	0.00	0.00	0.00	0.00	0.00
B-2	9.00 M Access Road	40.00	177.27	3.50	9.50	0.00	0.00	0.00	0.00	0.00
B-1	9.00 M Access Road	40.00	177.27	3.50	9.50	0.00	0.00	0.00	0.00	0.00
A-1	9.00 M Access Road	40.00	209.92	3.50	11.25	0.00	0.00	0.00	0.00	0.00
B-21	9.00 M Access Road	40.00	130.39	3.50	6.46	0.00	0.00	0.00	0.00	0.00
B-20	9.00 M Access Road	40.00	177.27	3.50	9.50	0.00	0.00	0.00	0.00	0.00
B-19	9.00 M Access Road	40.00	177.27	3.50	9.50	0.00	0.00	0.00	0.00	0.00
B-18	9.00 M Access Road	40.00	177.27	3.50	9.50	0.00	0.00	0.00	0.00	0.00
B-17	9.00 M Access Road	40.00	177.27	3.50	9.50	0.00	0.00	0.00	0.00	