

PLUMBING & FIRE SERVICES LEGEND :

	SEWER MANHOLE WITH 600 MM DIA FRP MANHOLE COVER
	STORM WATER MANHOLE WITH 600 MM DIA FRP MANHOLE COVER
	STORM WATER MANHOLE 1500 x 1000 MM WITH 600 MM DIA FRP MANHOLE COVER
	EXTERNAL SEWER LINE
	EXTERNAL STORM WATER LINE
	DOMESTIC WATER SUPPLY LINE
	FLUSHING WATER SUPPLY LINE
	MUNICIPAL WATER SUPPLY LINE
	GARDEN IRRIGATION LINE
	VALVE WITH CHAMBER
	NON RETURN VALVE (NRV) WITH CHAMBER
	WATER METER
	GARDEN HYDRANT
	R.P. RECHARGE PIT, 5000 x 2500 MM WITH 600MM DIA FRP MANHOLE COVER
	D.C. DESILTING CHAMBER (2000 x 2500) MM WITH 600 MM DIA FRP MANHOLE COVER
	EXTERNAL FIRE HYDRANT LINE
	EXTERNAL FIRE HYDRANT, SIZE : (750 x 600 x 250) MM

- SPECIAL NOTES :**
- ALL DIMENSIONS ON THIS DRAWING ARE IN MM.
 - ONLY WRITTEN DIMENSIONS ARE TO BE FOLLOWED. DRAWINGS SHOULD NOT BE SCALED UNDER ANY CIRCUMSTANCES.
 - ALL MEASUREMENTS MUST BE CHECKED AND VERIFIED BY THE CONTRACTORS PRIOR TO EXECUTION OF WORK AT THE SITE.
 - THIS DRAWING IS TO BE READ IN CONJUNCTION WITH ALL RELEVANT STRUCTURAL, SERVICES & FACILITY PLANNING DRAWINGS.
 - ARCHITECTURAL DRAWINGS ARE TO BE FOLLOWED FOR THE LOCATION OF ALL STRUCTURAL MEMBERS & MASONRY WALLS FOR SIZES & REINFORCEMENT DETAILS OF STRUCTURAL MEMBERS RELEVANT STRUCTURAL DRAWINGS ARE TO BE REFERRED.
 - ANY DISCREPANCIES BETWEEN ARCHITECTURAL, STRUCTURAL AND SERVICES DRAWINGS MUST BE BROUGHT TO THE NOTICE OF THE ARCHITECTS IMMEDIATELY & PRIOR TO EXECUTION AT SITE.
 - CO-ORDINATION WITH MEP SERVICES SUCH AS HVAC, PLUMBING, RRE & ELECTRICAL ETC. IS THE RESPONSIBILITY OF THE CONTRACTORS.
 - ALL MASONRY WALLS SHOULD BE ALIGNED WITH THE COLUMNING AS INDICATED ON THE PLAN IRRESPECTIVE OF THE POSITION AS CALCULATED WITH THE DIMENSIONING.
 - CONTRACTOR WILL BE TAKEN THE APPROVAL OF SHOP DRAWING & ALL THE NECESSARY DOCUMENT FROM THE CONSULTANT.
 - CONTRACTOR WILL BE WORKOUT THE QUANTITY AS APPROVED DRAWING & WILL TAKE THE NECESSARY APPROVAL BEFORE ORDER THE MATERIAL IF ANY EXTRA ITEM COMES.
 - FOR DETAILS, REFER RELEVANT LARGE SCALE DETAIL DRGS. AS INDICATED.

ISSUES

NO.	DATE	BY	DESCRIPTION	PRINTS

REVISIONS

NO.	DATE	DESCRIPTION

DRAWING STATUS
SUBMISSION DRAWING

PROJECT
PROPOSED GROUP HOUSING PROJECT "ROSEMONT RESIDENCY" (PHASE-01) AT PLOT NO. GH-3/2 PARK TOWN INTEGRATED TOWNSHIP, VILLAGE SHAHPUR BAHMETA & MEHRALI PARGANA DASHA, TEHLI & DISTRICT SHADABAD

CLIENT
M/S PARK TOWN COMPLEX PRIVATE LIMITED THROUGH AUTHORIZED SIGNATORY MR. BIR SINGH PUNDIR

ARCHITECT :
ARCOP ASSOCIATES PVT.LTD
PLOT NO 36B, SECTOR 32, INSTITUTIONAL AREA GURGAON, 122001 HARYANA INDIA.
TEL. +91 124 4596500 FAX. +91 124 4596550

SERVICES CONSULTANT:
PARADISE (MEP) CONSULTANTS
PLOT NO. 129, POCKET-2, BASEMENT JASOLA VIHAR, NEW DELHI-110025
PH : 011- 46132800, 41030619
E-mail: mep@paradiseconsultants.com

DRAWING TITLE :
EXTERNAL SITE PLAN (IRRIGATION LAYOUT)

Scale : 1:400 (A1) Drawn by : KULDEEP
Date : 06/03/2026 Checked by : ANIL
Project no : ----- Approved by : NAPEES
Drawing no :

PL-PC-PT-IRRI-104
REVISION []

BIRSING H PUNDIR Digitally signed by BIRSING H PUNDIR Date: 2026.04.08 18:56:50 +05'30'

AR.PANKAJ SINGH CA-2001/28681

ET STADIUM

30M WIDE MASTER PLAN ROAD

GREEN BELT

GREEN BELT

100.141
← TO NH-09

45.60

1.20

97.42

Green Park

23.50

94.13

93.56

7.50

OTHER'S LAND

STADIUM

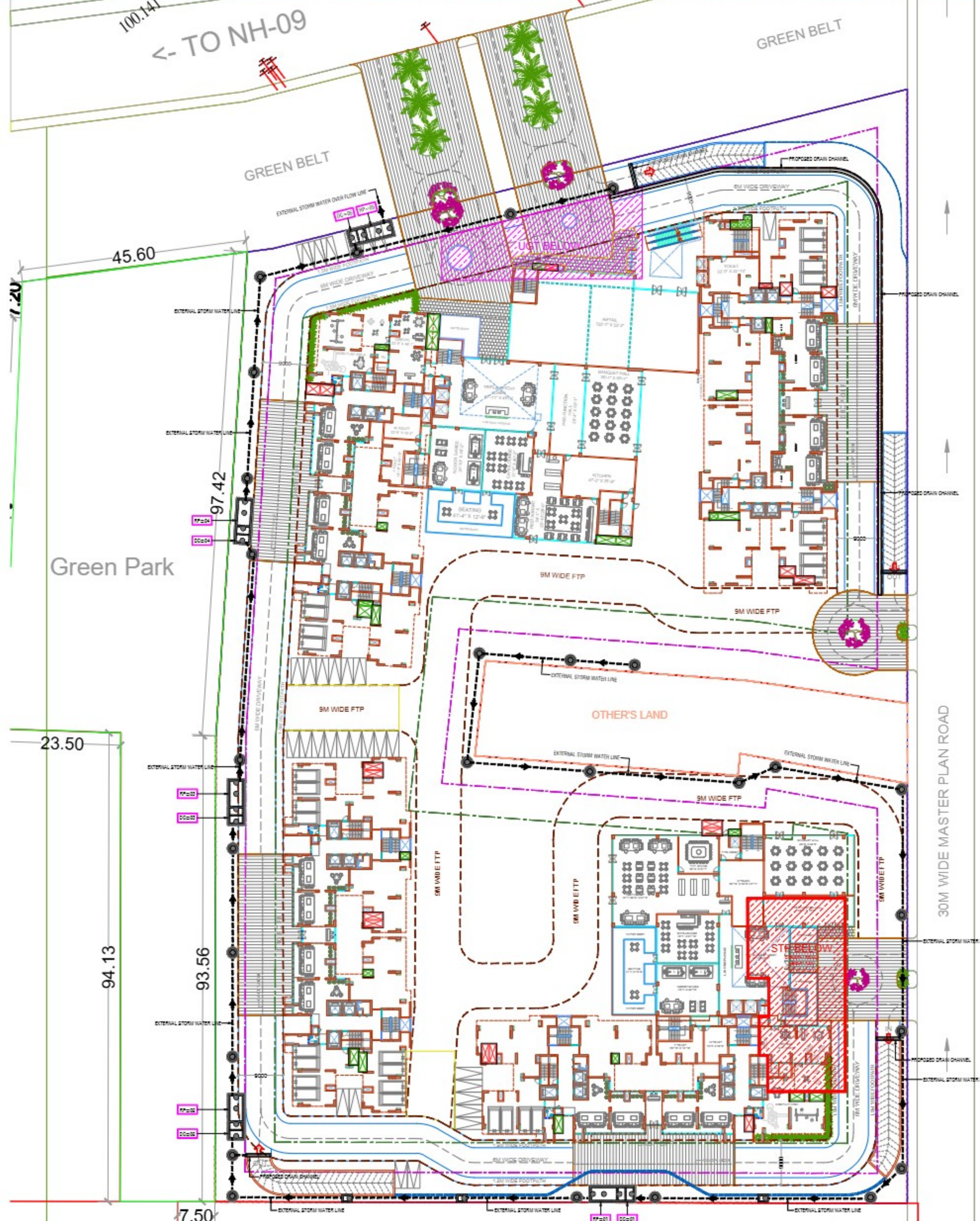

PLUMBING & FIRE SERVICES LEGEND :

	SEWER MANHOLE WITH 600 MM DIA FRP MANHOLE COVER
	STORM WATER MANHOLE WITH 600 MM DIA FRP MANHOLE COVER
	STORM WATER MANHOLE 1500 x 1000 MM WITH 600 MM DIA FRP MANHOLE COVER
	EXTERNAL SEWER LINE
	EXTERNAL STORM WATER LINE
	DOMESTIC WATER SUPPLY LINE
	FLUSHING WATER SUPPLY LINE
	MUNICIPAL WATER SUPPLY LINE
	GARDEN IRRIGATION LINE
	VALVE WITH CHAMBER
	NON RETURN VALVE (NRV) WITH CHAMBER
	WATER METER
	GARDEN HYDRANT
	R.P. RECHARGE PIT, 5000 x 2500 MM WITH 600MM DIA FRP MANHOLE COVER
	D.C. DESILTING CHAMBER (2000 x 2500) MM WITH 600 MM DIA FRP MANHOLE COVER
	EXTERNAL FIRE HYDRANT LINE
	EXTERNAL FIRE HYDRANT, SIZE : (750 x 600 x 250) MM

- SPECIAL NOTES :**
1. ALL DIMENSIONS ON THIS DRAWING ARE IN MM.
 2. ONLY WRITTEN DIMENSIONS ARE TO BE FOLLOWED. DRAWINGS SHOULD NOT BE SCALED UNDER ANY CIRCUMSTANCES.
 3. ALL MEASUREMENTS MUST BE CHECKED AND VERIFIED BY THE CONTRACTORS PRIOR TO EXECUTION OF WORK AT THE SITE.
 4. THIS DRAWING IS TO BE READ IN CONJUNCTION WITH ALL RELEVANT STRUCTURAL, SERVICES & FACILITY PLANNING DRAWINGS.
 5. ARCHITECTURAL DRAWINGS ARE TO BE FOLLOWED FOR THE LOCATION OF ALL STRUCTURAL MEMBERS & MASONRY WALLS FOR SIZES & REINFORCEMENT DETAILS OF STRUCTURAL MEMBERS RELEVANT STRUCTURAL DRAWINGS ARE TO BE REFERRED.
 6. ANY DISCREPANCIES BETWEEN ARCHITECTURAL, STRUCTURAL AND SERVICES DRAWINGS MUST BE BROUGHT TO THE NOTICE OF THE ARCHITECTS IMMEDIATELY & PRIOR TO EXECUTION AT SITE.
 7. CO-ORDINATION WITH MEP SERVICES SUCH AS HVAC, PLUMBING, RRE & ELECTRICAL ETC. IS THE RESPONSIBILITY OF THE CONTRACTORS.
 8. ALL MASONRY WALLS SHOULD BE ALIGNED WITH THE COLUMNING AS INDICATED ON THE PLAN IRRESPECTIVE OF THE POSITION AS CALCULATED WITH THE DIMENSIONING.
 9. CONTRACTOR WILL BE TAKEN THE APPROVAL OF SHOP DRAWING & ALL THE NECESSARY DOCUMENT FROM THE CONSULTANT.
 10. CONTRACTOR WILL BE WORKOUT THE QUANTITY AS APPROVED DRAWING & WILL BE TAKE THE NECESSARY APPROVAL BEFORE ORDER THE MATERIAL IF ANY EXTRA ITEM COMES.
 11. FOR DETAILS, REFER RELEVANT LARGE SCALE DETAIL DRGS. AS INDICATED.

ISSUES

NO.	DATE	BY	DESCRIPTION	PRINTS

REVISIONS

NO.	DATE	DESCRIPTION

DRAWING STATUS
SUBMISSION DRAWING

PROJECT
 PROPOSED GROUP HOUSING PROJECT "ROSEMONT RESIDENCY" (PHASE-01) AT PLOT NO. 36B-3/2 PARK TOWN INTEGRATED TOWNSHIP, VILLAGE SHAHPUR BAMBETA & MEHRALI PARGANA DASHA, TEHLI & DISTRICT SHADABAD

CLIENT
 M/S PARK TOWN COMPLEX PRIVATE LIMITED THROUGH AUTHORIZED SIGNATORY MR. BIR SINGH PUNDIR

Digitally signed by **BIRSINGH PUNDIR**
 Date: 2026.04.08 19:00:10 +05'30'

ARCHITECT :
ARCOP ASSOCIATES PVT.LTD
 PLOT NO 36B, SECTOR 32, INSTITUTIONAL AREA GURGAON, 122001 HARYANA INDIA.
 TEL. +91 124 4596500 FAX. +91 124 4596550

SERVICES CONSULTANT:
PARADISE (MEP) CONSULTANTS
 PLOT NO. 129, POCKET-2, BASEMENT JASOLA VIHAR, NEW DELHI-110025
 PH : 011-46132800, 41030619
 E-mail: mep@paradiseconsultants.com

DRAWING TITLE :
EXTERNAL SITE PLAN (STORM LAYOUT)

Scale : 1:400 (A1) Drawn by : KULDEEP
 Date : 06/03/2026 Checked by : ANIL
 Project no : Approved by : NAPEEG
 Drawing no :

PL-PC-PT-STORM-102

REVISION **RO**

AR.PANKAJ SAINI
 CA-2001/28481

ET STADIUM