

UPHDB ARCHITECTURAL AND PLANNING SECTION NEELGIRI COMPLEX, INDIRA NAGAR LUCKNOW-226016 E-MAIL: uphdb@sanchamet.in

DATE: 26-07-2016 REVISED PART L.O.P. & NUMBERING PLAN (200 SQM. & 112.5 SQM. PLOTS CONVERTED INTO HOUSE TYPE 75/200 & HOUSE TYPE 57/128) FOR SECTOR - 12 BAUDDH VIHAR YOJNA NO.-4 PART-II (MAJHOLA) MORADABAD. FILE NO. - APD/UN-2/MBD/Y-4/SEC-12/10/48 DRG. NO. - APD/UN-2/MBD/Y-4/SEC-12/10/48

NOTE 1. ALL DIMENSIONS ARE IN METER. 2. FIGURED DIMENSIONS SHALL BE FOLLOWED. 3. ANY DISCREPANCY, IF FOUND IN THE DRAWING SHALL BE BROUGHT TO THE NOTICE OF A.P. UNIT-2, BEFORE EXECUTION OF WORK. 4. THIS REVISED PART L.O.P. & NUMBERING PLAN HAS BEEN PREPARED ON THE BASIS OF INFORMATION RECEIVED BY E.E. CD-24 MORADABAD, VIDE HIS LETTER NO.-705/M-4/57, DATED-01.06.2016, AND LETTER NO.-861/M-4/92, DATED-02.07.2016 & S.E. V. MORADABAD, VIDE HIS LETTER NO.-954/M-23/16, DATED-02-06-2016 & 1005/M-28 MBD/34, DATED-15.06.2016. 5. THIS REVISED PART L.O.P. & NUMBERING PLAN HAS BEEN PREPARED ON THE BASIS OF FEASIBILITY GIVEN BY E.E. CD-24 MORADABAD, VIDE HIS LETTER NO.-1005/M-4/108, DATED-25.07.2016. 6. THIS REVISED PART L.O.P. & NUMBERING PLAN HAS BEEN PREPARED ON THE BASIS OF INSTRUCTION GIVEN BY H.C. ON DATED-14.06.2016.

REVISION NOTE (1):-26-07-2016

A. HOUSE TYPE 75/200, SIZE - 10.0 X 20.0 M.

1. 41 NOS. 10.00X20.00 M. HIG PLOTS CONVERTED IN TO 38 NOS. 10.00X20.00 M. HOUSE TYPE 75/200 AS SUGGESTED BY S.E. - V. MORADABAD, AND 03 NOS. OF RESIDENTIAL PLOTS. (PLOT NOS ARE 12/25, 12/389 & 12/400.)

B. HOUSE TYPE 57/128, SIZE - 8.50 X 15.0 M.

1. 44 NOS 7.50X 15.0 M. MIG PLOTS CONVERTED IN TO 36 NOS 8.50X 15.0 M. HOUSE TYPE 57/128 AS SUGGESTED BY S.E. - V. MORADABAD, AND 04 NOS. OF RESIDENTIAL PLOTS. (PLOT NOS ARE 12/26, 12/320, 12/363 & 12/375) 2. AS APPROVED NUMBERING PLAN DATED -03-04-2008, PLOT NO.-1/42, 12/43, 12/376 & 12/321 (TOTAL PLOT-04 NOS) ELIMINATED IN REVISED LOP/NUMBERING PLAN.

Controlled Copy No. 1

NOTE 1. DISPUTED LAND UNDER COURT STAY 2. PUMP HOUSE / O.H.T.

REVISED PART L.O.P. AND NUMBERING PLAN (200 SQM. & 112.5 SQM. PLOTS CONVERTED INTO HOUSE TYPE 75/200 & HOUSE TYPE 57/128) FOR SECTOR - 12, BAUDDH VIHAR YOJNA NO.-4 PART-II (MAJHOLA) MORADABAD.

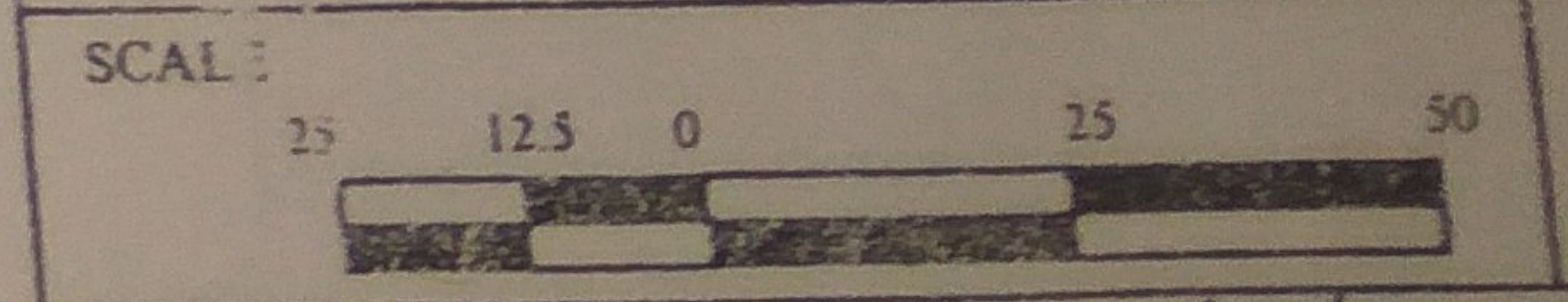
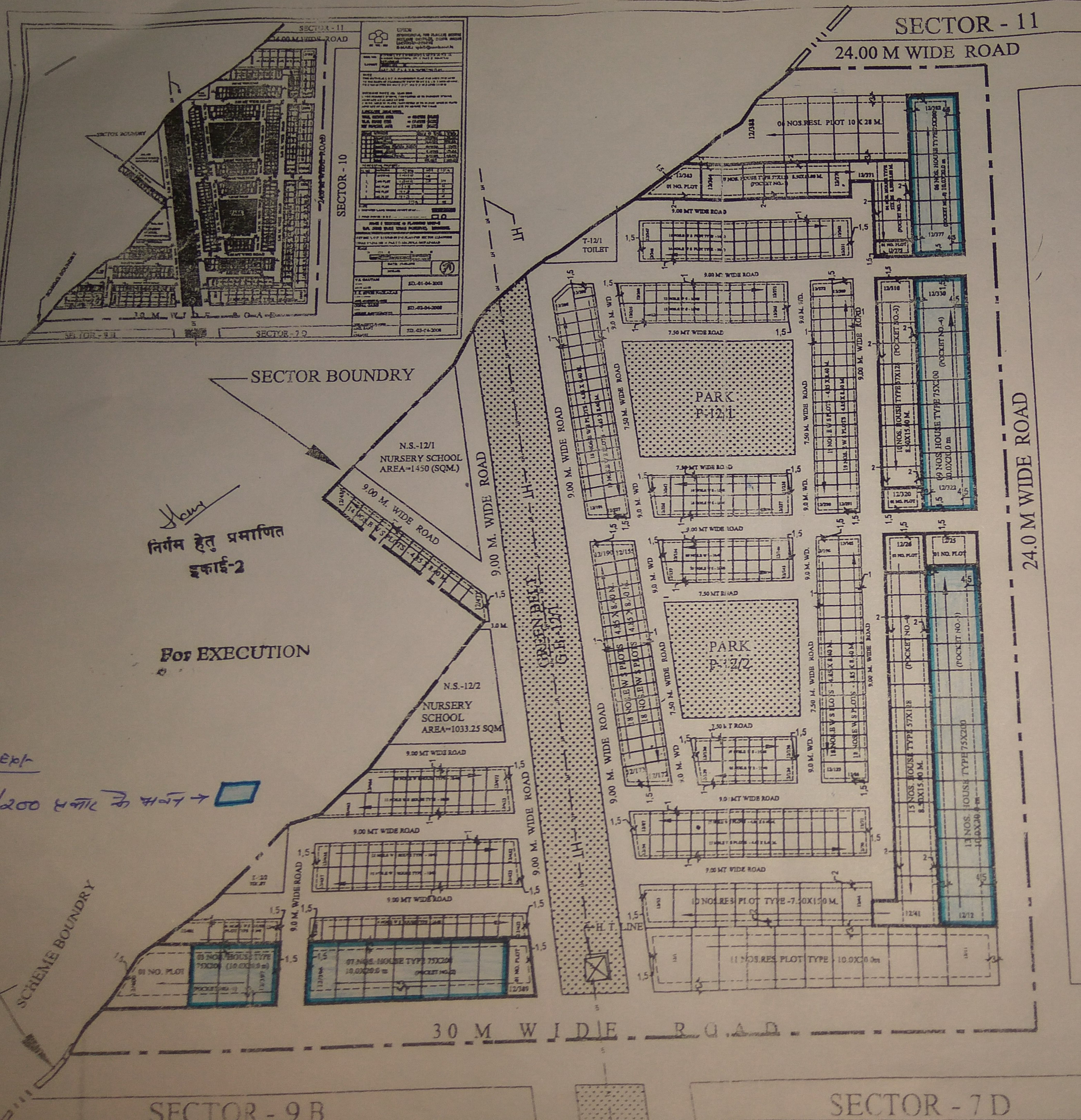

Table with 2 columns: Name/Designation and Signature/Date. Includes V.S. CAUTAM (Arch. Asst.), HEMA SHAH (Asstt. Architect Planner), GOPAL GARG (Architect Planner), and R. P. SINGH (Chief Architect Planner).



निर्गम हेतु प्रमाणित इकाई-2

For EXECUTION

75/200 प्रकार के सबत

SECTOR - 9 B

SECTOR - 7 D