

**PROJECT:**  
M/s. VALUE INFRACON.INDIA (P.) LTD.  
Meadows vista

**DRG/ NO.** ELECTRICAL SITE SUBSTATION LAYOUT

**LEGENDS :**

SR.NO	SYMBOL	DESCRIPTION
1.		40-45W LED STREET LIGHT
2.		GATE LIGHT
3.		FEEDER PILLAR
4.		10-12W LED BOLLARD LIGHT
5.		25-30W POST TOP LIGHT
6.		20-25W LED STREET LIGHT
7.		MAINHOLE

Note:- Pole Height for 45W Street Light will be 6 Mtr Octagonal, 4 Mtr height for Post Top & 27W street Light and 0.8 to 1.0 Mtr Bollard

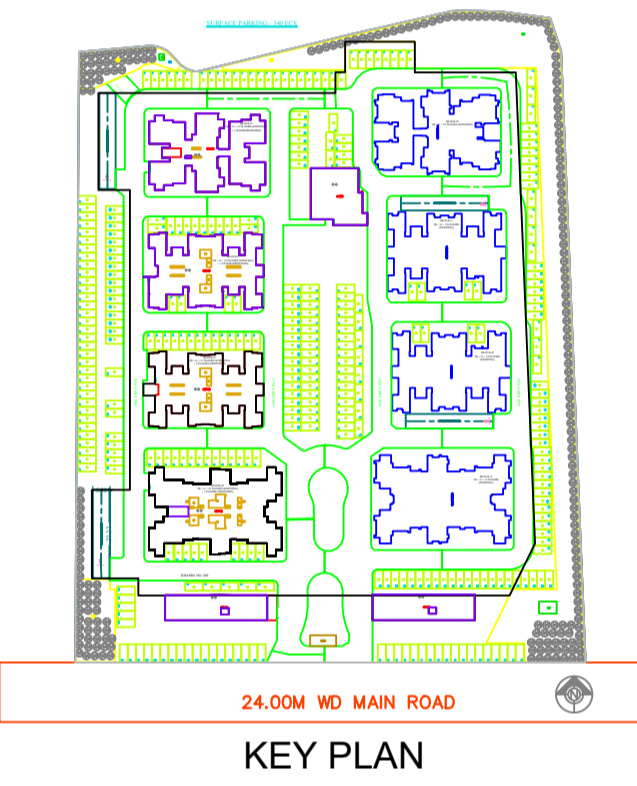

- NOTE:-**
1. ASSUMING THE EXISTING ROAD WHEN WIDEN INTO 24.00 MT. WIDE ROAD WILL RAISED TO 600 MM, SO ASSUMING PROPOSED 24.00 MT. ROAD LEVEL AS +750 MM. ABOVE FROM EXISTING METAL ROAD LVL.
  2. SIZE OF COLUMN ARE SUBJECT TO FINALIZE OF STRUCTURE DRAWING BY STRUCTURE CONSULTANT.
  3. ANY AMBIGUITY IN ARCHITECTURAL DRAWINGS SHOULD BE BROUGHT TO THE NOTICE OF THE ARCHITECT BEFORE EXECUTION OTHERWISE WE WILL NOT RESPONSIBLE FOR ANY MISTAKE.
  4. GRID LINES ARE GENERALLY PASSING THROUGH THE COLUMN IN LONGER DIRECTION AND SHORTER DIRECTION IS 115 MM FROM THE ONE END OF COLUMN OR OTHER WISE MENTIONED IN DRAWING

**drawing released for**

APPROVAL  G.F.C.

ADVANCE COPY  CONSTRUCTION

**date** 06.01.2026

**drawn by** ARJUN **ckd by** ANIL

**OWNER (CLIENT) SIGNATURE**

For Valuo Infracon India Private Limited

*[Signature]*  
Authorized Signatory

**ARCHITECT SIGNATURE**

*[Signature]*  
JITENDRA KUMAR DAS  
Architect  
C.O.A. No. CA/2012/55518

**CONSULTANT**

**CREATIVE DESIGN CONSULTANTS & ENGINEERS PVT. LTD.**  
408, SG ALPHA TOWER-1, SECTOR 9  
VASUNDHARA, GHAZIABAD - 201012  
E-mail: ccept.design@gmail.com, website: www.ccept.co.in

**PMC:-**  
CREATIVE DESING CONSULTANTS & ENGINEERS PVT. LTD.

**MEP CONSULTANT :-**

**eIMech India Engineers**  
HD-104, Sec-135 Noida-201301(India)  
Mob:-91-8826155004  
Email: anil.almech@gmail.com  
Web: www.almech.live

**SITE PLAN ELECTRICAL SITE SUBSTATION LAYOUT**