

ELECTRICAL LAYOUT PLAN

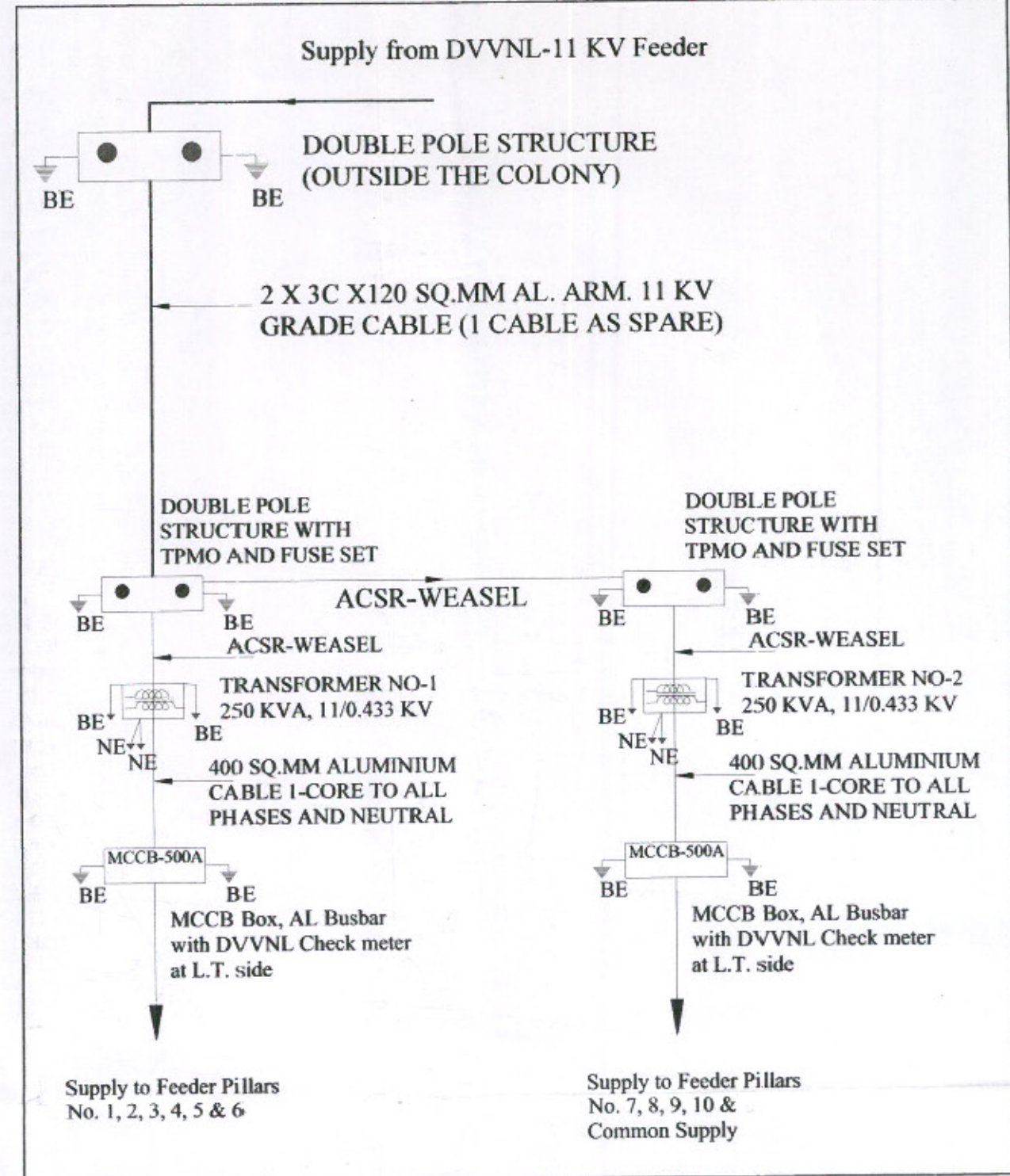
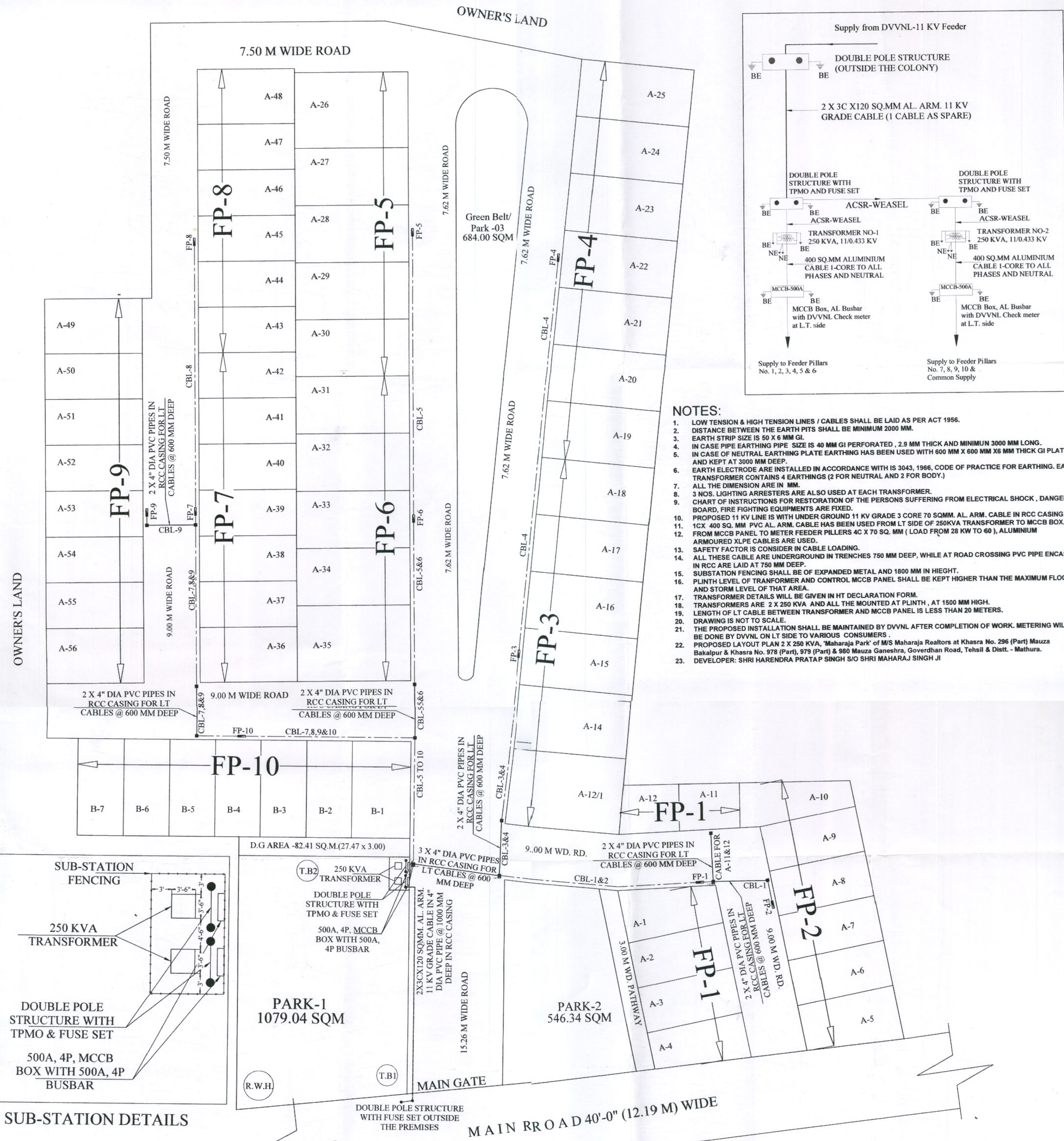

- NOTES:**
1. LOW TENSION & HIGH TENSION LINES / CABLES SHALL BE LAID AS PER ACT 1956.
 2. DISTANCE BETWEEN THE EARTH PITS SHALL BE MINIMUM 2000 MM.
 3. EARTH STRIP SIZE IS 50 X 6 MM GI.
 4. IN CASE PIPE EARTHING PIPE SIZE IS 40 MM GI PERFORATED, 2.9 MM THICK AND MINIMUM 3000 MM LONG.
 5. IN CASE OF NEUTRAL EARTHING PLATE EARTHING HAS BEEN USED WITH 600 MM X 600 MM X 6 MM THICK GI PLATE AND KEPT AT 3000 MM DEEP.
 6. EARTH ELECTRODE ARE INSTALLED IN ACCORDANCE WITH IS 3043, 1966, CODE OF PRACTICE FOR EARTHING. EACH TRANSFORMER CONTAINS 4 EARTHINGS (2 FOR NEUTRAL AND 2 FOR BODY.)
 7. ALL THE DIMENSION ARE IN MM.
 8. 3 NOS. LIGHTING ARRESTERS ARE ALSO USED AT EACH TRANSFORMER.
 9. CHART OF INSTRUCTIONS FOR RESTORATION OF THE PERSONS SUFFERING FROM ELECTRICAL SHOCK, DANGER BOARD, FIRE FIGHTING EQUIPMENTS ARE FIXED.
 10. PROPOSED 11 KV LINE IS WITH UNDER GROUND 11 KV GRADE 3 CORE 70 SQ.MM. AL. ARM. CABLE IN RCC CASING.
 11. 1CX 400 SQ. MM PVC AL. ARM. CABLE HAS BEEN USED FROM LT SIDE OF 250KVA TRANSFORMER TO MCCB BOX.
 12. FROM MCCB PANEL TO METER FEEDER PILLERS 4C X 70 SQ. MM (LOAD FROM 28 KW TO 60), ALUMINIUM ARMOURD XLPE CABLES ARE USED.
 13. SAFETY FACTOR IS CONSIDER IN CABLE LOADING.
 14. ALL THESE CABLE ARE UNDERGROUND IN TRENCHES 750 MM DEEP, WHILE AT ROAD CROSSING PVC PIPE ENCASED IN RCC ARE LAID AT 750 MM DEEP.
 15. SUBSTATION FENCING SHALL BE OF EXPANDED METAL, AND 1800 MM IN HEIGHT.
 16. PLINTH LEVEL OF TRANSFORMER AND CONTROL MCCB PANEL SHALL BE KEPT HIGHER THAN THE MAXIMUM FLOOD AND STORM LEVEL OF THAT AREA.
 17. TRANSFORMER DETAILS WILL BE GIVEN IN HT DECLARATION FORM.
 18. TRANSFORMERS ARE 2 X 250 KVA AND ALL THE MOUNTED AT PLINTH, AT 1500 MM HIGH.
 19. LENGTH OF LT CABLE BETWEEN TRANSFORMER AND MCCB PANEL IS LESS THAN 20 METERS.
 20. DRAWING IS NOT TO SCALE.
 21. THE PROPOSED INSTALLATION SHALL BE MAINTAINED BY DVVNL AFTER COMPLETION OF WORK. METERING WILL BE DONE BY DVVNL ON LT SIDE TO VARIOUS CONSUMERS.
 22. PROPOSED LAYOUT PLAN 2 X 250 KVA, 'Maharaja Park' of M/S Maharaja Realtors at Khasra No. 296 (Part) Mauza Bakalpur & Khasra No. 978 (Part), 979 (Part) & 980 Mauza Ganeshra, Goverdhan Road, Tehsil & Distt. - Mathura.
 23. DEVELOPER: SHRI HARENDRA PRATAP SINGH S/O SHRI MAHARAJ SINGH JI

PLOT AREA DETAIL

PLOT NO.	NO. OF PLOTS	PLOT SIZE	PLOT AREA	TOTAL AREA
A1	1	Odd Size	104.58 Sq.M.	0104.58 Sq.M.
A2 & A3	2	7.32 X 15.54	113.75 Sq.M.	0227.50 Sq.M.
A-4	1	Odd Size	102.80 Sq.M.	0102.80 Sq.M.
A5	1	Odd Size	124.63 Sq.M.	0124.63 Sq.M.
A6 TO A9	4	7.32 X 15.54	113.75 Sq.M.	0455.00 Sq.M.
A10	1	Odd Size	107.23 Sq.M.	0107.23 Sq.M.
A11	1	Odd Size	071.64 Sq.M.	0071.64 Sq.M.
A12	1	Odd Size	071.51 Sq.M.	0071.51 Sq.M.
A12/1	1	12.14 X 18.29	222.04 Sq.M.	0222.04 Sq.M.
A14 TO A25	12	9.14 X 18.29	167.17 Sq.M.	2006.04 Sq.M.
A26	1	12.14 X 18.29	222.04 Sq.M.	0222.04 Sq.M.
A27 TO A34	8	9.14 X 18.29	167.17 Sq.M.	1337.36 Sq.M.
A35	1	12.14 X 18.29	222.04 Sq.M.	0222.04 Sq.M.
A36	1	8.81 X 15.54	136.91 Sq.M.	0136.91 Sq.M.
A37 TO A47	11	7.32 X 15.54	113.75 Sq.M.	1251.25 Sq.M.
A48	1	8.81 X 15.54	136.91 Sq.M.	0136.91 Sq.M.
A49	1	8.81 X 15.54	136.91 Sq.M.	0136.91 Sq.M.
A50 TO A55	6	7.32 X 15.54	113.75 Sq.M.	0682.50 Sq.M.
A56	1	8.81 X 15.54	136.91 Sq.M.	0136.91 Sq.M.
B1	1	9.46 X 15.54	147.01 Sq.M.	0147.01 Sq.M.
B2 TO B7	6	7.32 X 15.54	113.75 Sq.M.	0682.50 Sq.M.
GRAND TOTAL				8585.31 Sq.M.

LEGEND:

ELECTRICAL MARKETION	SYMBLE
MAN-HOLE OF SIZE 600MM X 600MM	■
LT FEEDER PILLAR WITH ENERGY METERS	▬
500A MCCB BOX NEAR TRANSFORMER	□
250 KVA TRANSFORMER AT PLINTH	□
11 KV H.T. UNDER GROUND LINE	—
1100 V L.T. UNDER GROUND LINE	- - -
DOUBLE POLE STRUCTURE 11 M, STP WITH TPMO & FUSE SET- 1 NO.	●

OWNER'S NAME: M/S MAHARAJA REALTORS
BY PARTNER: Shri Harendra Pratap Singh S/o Shri Maharaj Singh Ji
 Present R/o- Maharaja House 106,107 & 108 Anandlok Goverdhan Road Mathura

OWNERS Name :-

Khasra no.	Area (SqM)	Land in prop. Map Area (SqM)	Balance Land for future Development (SqM)
978	16320.00	850.00	15470.00
979	15450.00	856.00	6894.00
980	2140.00	2140.00	00.00
296	3841.00	3841.00	00.00
TOTAL	37751.00	15391.00	22360.00

NOTE :- SAPERATE SEPTIC TANKS ARRANGED BY SELF INDIVIDUAL PLOT/ HOUSE HOLDERS

LEGENDS - :

RESIDENTIAL PLOTS	TYPE	AREA	%
TOTAL LAND AREA		15391.00 Sqm	100.00
AREA UNDER RESIDENTIAL PLOTS		8585.31 Sqm	55.78
PARK/GREENBELT AREA		2309.38 Sqm	15.00
AREA UNDER DALAB GHAR ROAD		82.41 Sqm	00.54
AREA UNDER ROADS & PATHWAY		4413.90 Sqm	28.68

OWNER:- M/S MAHARAJA REALTORS
ARCHITECT - : KONARK ARCHITECTS, C-45, C-46 & C-47 ANAND VIHAR, MAHOLI ROAD, MATHURA. Ph. 941273819 (M). Email:- konarkassociates23@gmail.com

REVISION NOTES:

R1	21.3.17	Drawing Revised as per Layout Revision
----	---------	--

SHEET NO. : 1
 DATE: 17.02.2017
 DRG. NO.: -MP/ELEC/1

REVISION NO. : (R1)

DRAWN BY: Nishant Singh
 CHECKED BY: A.K. Goyal

ELECTRICAL CONSULTANT
ANIL K. GOYAL
 B.TECH (ELECT.), M.E. (FIE), MIPHE, MICA, MEHRAE, ELECTRICAL CONSULTANT
 Certified Energy Analyst
 (Regd. No. EA-3914)

CONSULTANTS:
C. E. M. G.
 ENGINEERS & CONSULTANTS
 PVT. LIMITED
 1, Elora Complex, Khandari Crossing
 Surya Nagar, Agra
 E-mail: ansh13579@gmail.com.

PROJECT:
MAHARAJA PARK, MATHURA

DRG. TITLE:
ELECTRICAL LAYOUT OF COLONY