

# Shanvi Park City

Plot no. 328 & 348,

Gujjainiy, Taty tope nagar phase-II

Behind ITBP, barra by pass

## Boundary wall work:

Site will be totally bound with boundary wall it is 2025mm height with 115mm thick as shown in fig.



## Plot demarcation work:

Site plots will be totally bound with curve stone bricks with black & yellow color it is 300 mm height with 115mm thick as shown in fig.

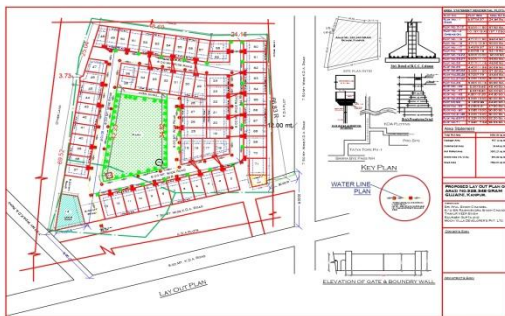

## Road work:

Road will be made with interlocking tile with rain water drain. The dimension of road is 6000mm in wide as shown in fig.



# Sewer line & rain water drain work:

Sewer line is situated on the center of road with connecting line and chamber. The dimension of main sewer line is 450mm dia. & connecting line is 160mm dia. The main chamber dimension is 1200mm X 1200mm & connecting chamber is 450mmX450mm with rain water harvesting as shown in fig.

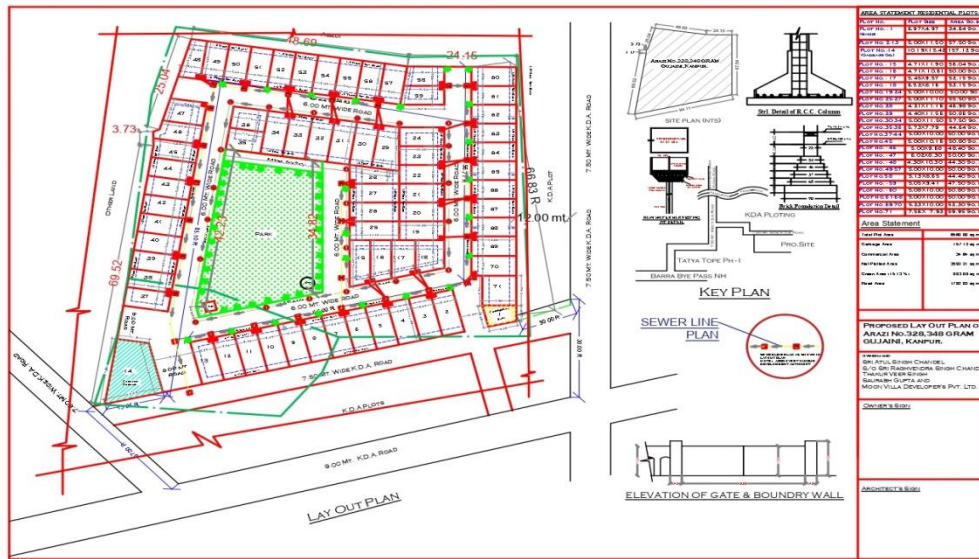

## Park work:

Park is situated in the center of project with green grass and bottle palm tree with path way (1800mm Wide) and boundary wall with four side gate (1200mm Wide) height of boundary wall on park area is 1800mm & thickness is 115mm as shown in fig.



# Solide waste disposable plan work:

It is situated in the corner of project with green grass and covered with shade & boundary wall as shown in fig.

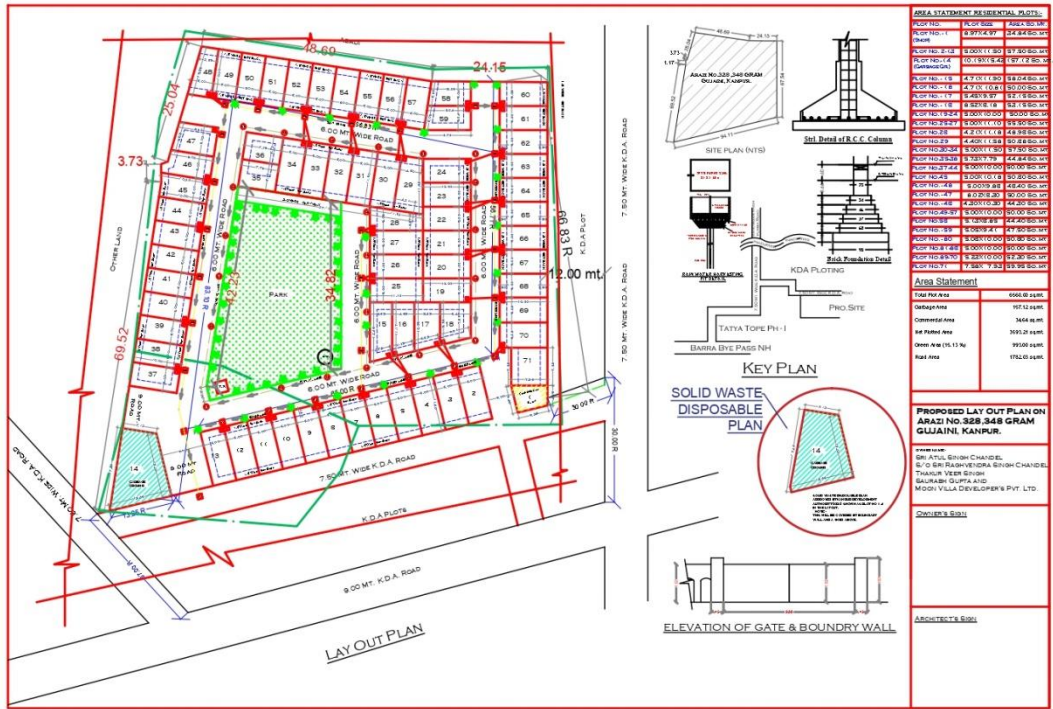

AREA STATISTICS RESIDENTIAL PLOTS			
Plot No.	Plot Size	Area Sq.Mt.	Remarks
1	10.00 x 10.00	100.00	Plot 1
2	10.00 x 10.00	100.00	Plot 2
3	10.00 x 10.00	100.00	Plot 3
4	10.00 x 10.00	100.00	Plot 4
5	10.00 x 10.00	100.00	Plot 5
6	10.00 x 10.00	100.00	Plot 6
7	10.00 x 10.00	100.00	Plot 7
8	10.00 x 10.00	100.00	Plot 8
9	10.00 x 10.00	100.00	Plot 9
10	10.00 x 10.00	100.00	Plot 10
11	10.00 x 10.00	100.00	Plot 11
12	10.00 x 10.00	100.00	Plot 12
13	10.00 x 10.00	100.00	Plot 13
14	10.00 x 10.00	100.00	Plot 14
15	10.00 x 10.00	100.00	Plot 15
16	10.00 x 10.00	100.00	Plot 16
17	10.00 x 10.00	100.00	Plot 17
18	10.00 x 10.00	100.00	Plot 18
19	10.00 x 10.00	100.00	Plot 19
20	10.00 x 10.00	100.00	Plot 20
21	10.00 x 10.00	100.00	Plot 21
22	10.00 x 10.00	100.00	Plot 22
23	10.00 x 10.00	100.00	Plot 23
24	10.00 x 10.00	100.00	Plot 24
25	10.00 x 10.00	100.00	Plot 25
26	10.00 x 10.00	100.00	Plot 26
27	10.00 x 10.00	100.00	Plot 27
28	10.00 x 10.00	100.00	Plot 28
29	10.00 x 10.00	100.00	Plot 29
30	10.00 x 10.00	100.00	Plot 30
31	10.00 x 10.00	100.00	Plot 31
32	10.00 x 10.00	100.00	Plot 32
33	10.00 x 10.00	100.00	Plot 33
34	10.00 x 10.00	100.00	Plot 34
35	10.00 x 10.00	100.00	Plot 35
36	10.00 x 10.00	100.00	Plot 36
37	10.00 x 10.00	100.00	Plot 37
38	10.00 x 10.00	100.00	Plot 38
39	10.00 x 10.00	100.00	Plot 39
40	10.00 x 10.00	100.00	Plot 40
41	10.00 x 10.00	100.00	Plot 41
42	10.00 x 10.00	100.00	Plot 42
43	10.00 x 10.00	100.00	Plot 43
44	10.00 x 10.00	100.00	Plot 44
45	10.00 x 10.00	100.00	Plot 45
46	10.00 x 10.00	100.00	Plot 46
47	10.00 x 10.00	100.00	Plot 47
48	10.00 x 10.00	100.00	Plot 48
49	10.00 x 10.00	100.00	Plot 49
50	10.00 x 10.00	100.00	Plot 50
51	10.00 x 10.00	100.00	Plot 51
52	10.00 x 10.00	100.00	Plot 52
53	10.00 x 10.00	100.00	Plot 53
54	10.00 x 10.00	100.00	Plot 54
55	10.00 x 10.00	100.00	Plot 55
56	10.00 x 10.00	100.00	Plot 56
57	10.00 x 10.00	100.00	Plot 57
58	10.00 x 10.00	100.00	Plot 58
59	10.00 x 10.00	100.00	Plot 59
60	10.00 x 10.00	100.00	Plot 60
61	10.00 x 10.00	100.00	Plot 61
62	10.00 x 10.00	100.00	Plot 62
63	10.00 x 10.00	100.00	Plot 63
64	10.00 x 10.00	100.00	Plot 64
65	10.00 x 10.00	100.00	Plot 65
66	10.00 x 10.00	100.00	Plot 66
67	10.00 x 10.00	100.00	Plot 67
68	10.00 x 10.00	100.00	Plot 68
69	10.00 x 10.00	100.00	Plot 69
70	10.00 x 10.00	100.00	Plot 70
71	10.00 x 10.00	100.00	Plot 71
72	10.00 x 10.00	100.00	Plot 72
73	10.00 x 10.00	100.00	Plot 73
74	10.00 x 10.00	100.00	Plot 74
75	10.00 x 10.00	100.00	Plot 75
76	10.00 x 10.00	100.00	Plot 76
77	10.00 x 10.00	100.00	Plot 77
78	10.00 x 10.00	100.00	Plot 78
79	10.00 x 10.00	100.00	Plot 79
80	10.00 x 10.00	100.00	Plot 80

Area Statement	
Total Plot Area	8000.00 sq.mt.
Developed Area	187.50 sq.mt.
Common Area	345.00 sq.mt.
Open Area (15% Nil)	950.00 sq.mt.
Plot Area	6727.50 sq.mt.

  

PROPOSED LAY OUT PLAN ON ARAZI NO. 348 GRAM GUJAINI, KANPUR.	
Prepared by	SH. ATUL KISHOR CHAUHAN, SH. O. SRI RASHMIYENDRA SHYAM CHAUHAN, TANUJA VEER KISHOR, SURABHI GUPTA AID MODI VILLA DEVELOPERS PVT. LTD.
OWNER'S SIGN	
ARCHITECT'S SIGN	

## Electricity work:

It is situated in the road with 20000mm distance between them of project with ABC line (3.5core wire) for connection and project it have transformer for electric supply as shown in fig. in the corner of the park.

- Internal electric line will have pole length 9000mm carrying ABC line for distribution work
- The transformer will be connected with high tension poles with length 11000mm caring aluminum weir for connection with KESCO.
- Electricity will be providing road by KESCO Kanpur.
- Electric transformer capacity will be decided by KESCO kanpur 110KV to 220KV.

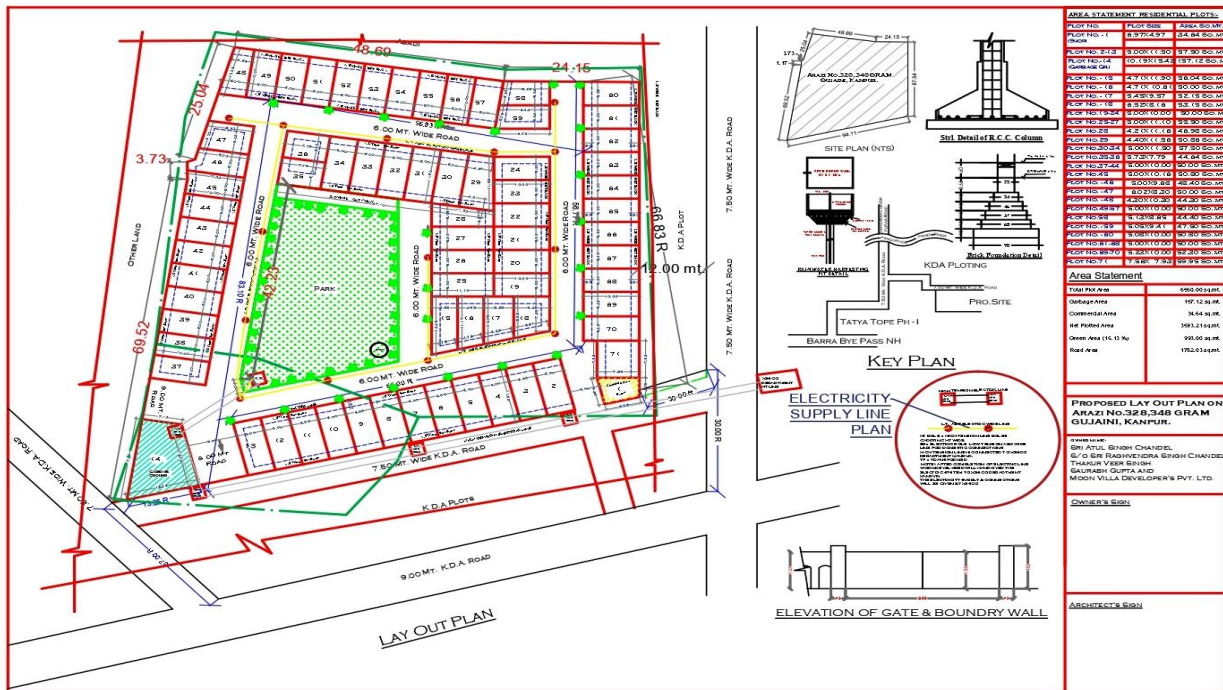

## Main gate work:

Project having to main gate with dimension 9000mm wide & 6000mm wide as shown in fig.

## Water line plan work:

It is situated in the side of road with depth 750mm on the ground. The main water line is 110mm in Dia with distribution line is 50mm on Dia with connect to each and every plot as shown in fig.

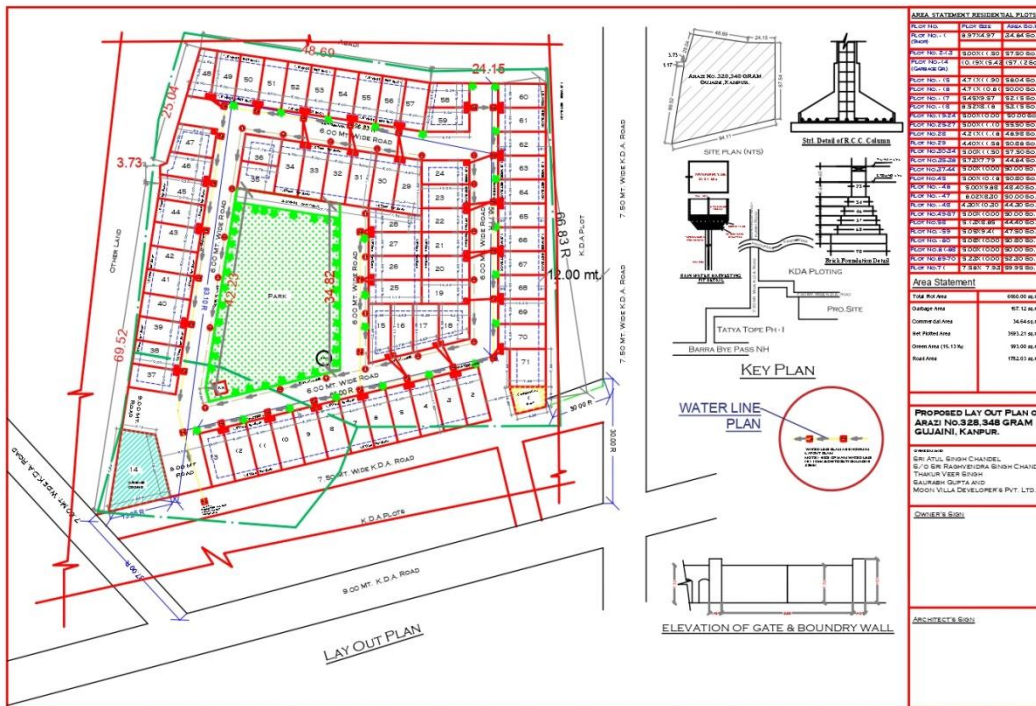

NOTE:- all work specified above are uploaded in high quality PDF fills in upload section of RERA section for better viewing