

UCHDPL – Sector 01 Oakwood Enclave: Project Specification

The project has Gross Land area of 99040.91 SQM /24.46 acres , out of which , Plotted area is 56556.69 SQM (57.11 %) , Green area and Open spaces is 8532.62 SQM (8.61 %) and Road Area is 33951.60 SQM (34.28%). In this project, 437 plots are planned. Out of 437, company has completed works on 379 plots and received completion from Authority. The specifications of development are as follows :

Development Work Name	Description					
Demarcation of Plots	Plots demarcated as per Approved layout with installation of concrete pillar of size 100x100x600mm at four corners of each plot.					
Boundary Wall	Boundary wall shall be made with standard brick with MS Grill with thickness of 230mm and height 1.8m					
Road Work	Width (m)	Width of Carriage way (m)	Width of footpath (m)	GSB (mm)	WMM (mm)	SDBC (mm)
	9 m	5	4	150	100	30
	12 m	6	6	150	100	30
	15 m	7.5	7	150	100	30
	Note: Cross sections are enclosed as Annexure					
Footpaths	Width (m)	Width of footpath (m)		GSB (mm)	Interlocking tiles over sand bed	
	9 m	4		75	60	
	12 m	6		75	60	
	15 m	7		75	60	
Water Supply Including Drinking Water Facilities	The Water supply system planned to provide 24 x 7 water supply. HDPE pipe PN-6, PE-80 for water supply network 1600 KL RCC storage tanks (800KL UGT and 800 KL OHT) 3 tub-wells (with total 45HP pump) used with piped network of HDPE PN-10, PE 100 pipes					
Sewer System	RCC pipe class NP2 has been used Manholes/Chambers made with Brick Masonry in Conical shape ranging from dia 900 to 1500mm					
Drain	RCC pipe class NP2 has been used					

	Manholes/Chambers made with Brick Masonry in Conical shape with dia 900mm
Park	Wire fencing along boundary, Grassing and tree Plantation
Tree Planting	One tree on one side of 9m road Both side trees on 12m and 15m road
Design For Electric Supply Including Street Lighting*	Compact substation 1000 KVA – 2nos and 1600 KVA -1 of make Ambit Switchgear. 5m Cast Iron Pole with GI Ribbed/Grooved extrusion and single arm bracket Street light poles with 75 watt cast iron LED fixture. Feeder panels- 6 way, 8 way and 12way
Community Buildings	There is no community building in this project.
Treatment and Disposal System of Sewage and Sullage water	As per the scheme sewage shall be disposed in trunk sewer line which goes to Township level STP proposed in Sec-4, Wave City. In order to treat sewage till, the township level STP comes up, a modular type 200 KLD STP shall be installed at site before handover.
Solid Waste Management And Disposal System	Collection shall be ensured from each household Segregation waste treatment facility at Sec-6 Organic waste is composted with the help of Automatic organic waste converter machine.
Water Conservation System	RWH recharge structures of approx. 144 cum have been developed Modular type RWH pits have been developed with Rain Max recharge Tanks technology. RCC type NP2 pipe used
Energy Management System Including Use of Renewable Energy	NA
Fire Protection And Fire Safety	NA

System	
Social Infrastructure And Other Public Amenities Including Public Health Services	NA
Emergency Evacuation Services	NA
Other Miscellaneous Work	NA

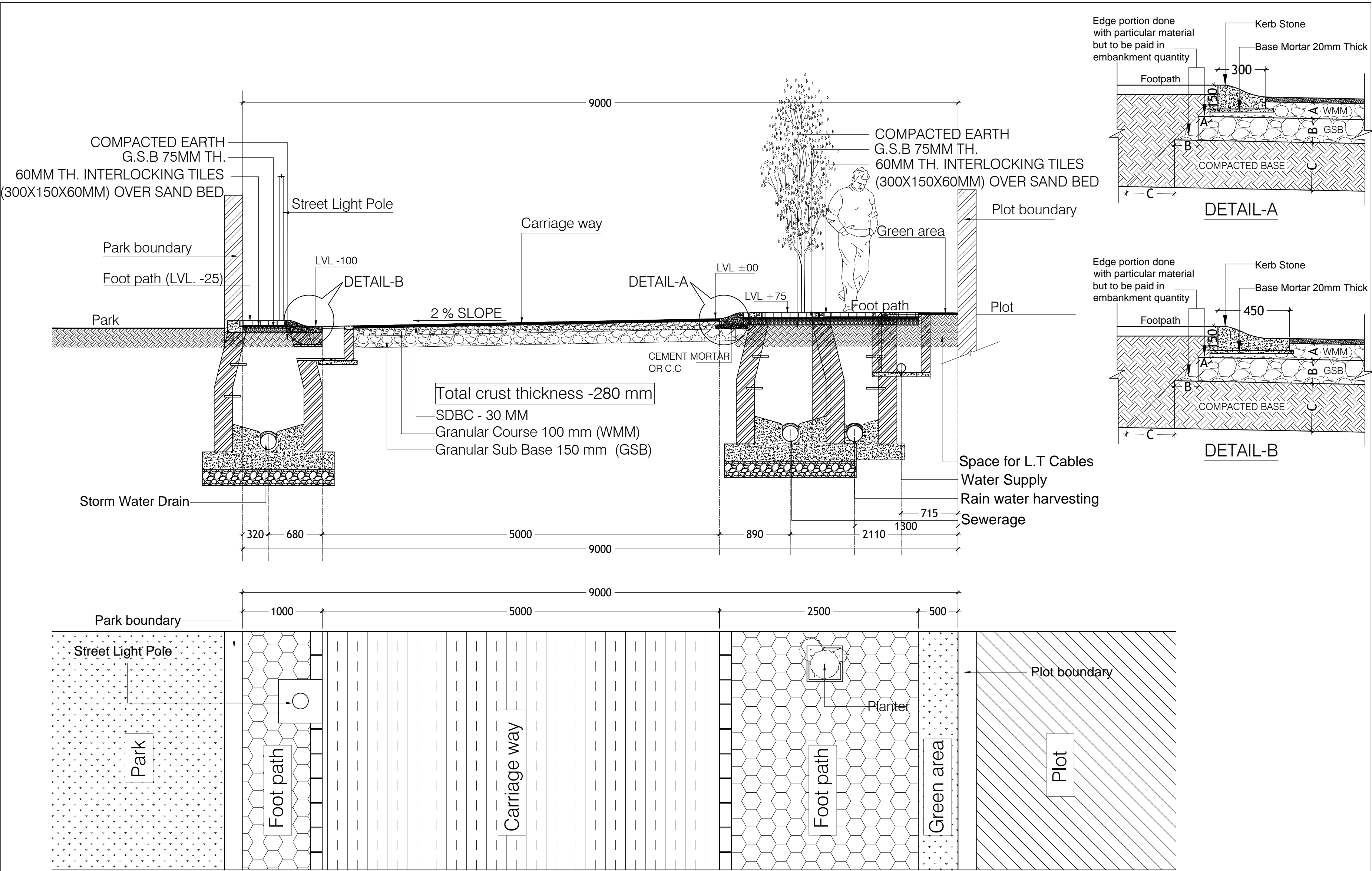

PROJECT NAME: WAVE HI- TECH TOWNSHIP	NOTE:- 1. THE CRUST THICKNESS SHALL BE AS PER DESIGN 2. THE FORMATION LEVELS SHOULD BE CHECKED AS PER SITE GRADING PLAN 3. THE LOCATION AND SIZES OF MANHOLES, CHAMBERS & PIPES FOR DRAINAGE, SEWERAGE, RAIN WATER HARVESTING AND WATER SUPPLY SHALL BE AS PER RESPECTIVE DRAWINGS 4. THE LOCATION OF ELECTRIC POLES AND ELECTRIC TRENCHES TO BE READ FROM ELECTRICAL DRAWING 5. IN CASE OF ANY DISCREPANCY THE ISSUE SHOULD BE BROUGHT TO THE NOTICE OF REPL BEFORE COMMENCEMENT OF EXECUTION	REVISION NO	REVISION DATE	DESCRIPTION	INFRA-13 Pvt. Ltd.				
		R1	18.01.11		DRAWING TITLE DETAILS OF 9 M WIDE ROAD				
CLIENT: INFRA-13 Pvt. Ltd.		R2	26.02.11		DRAWING NO W-H-T/SER/RD-9/SEC/1				
		R3	02.06.11		SCALE N.T.S				
		R4	28.06.11		DATE 04.10.10				
		R5	03.08.11	REVISED KERB STONE DETAIL	DEALT BY GAJENDRA SINGH (T.D.)	Sr. Architect (T.D.)	G.M. (EX.)	G.M. (T.D.)	C.O.O. (T.D.)

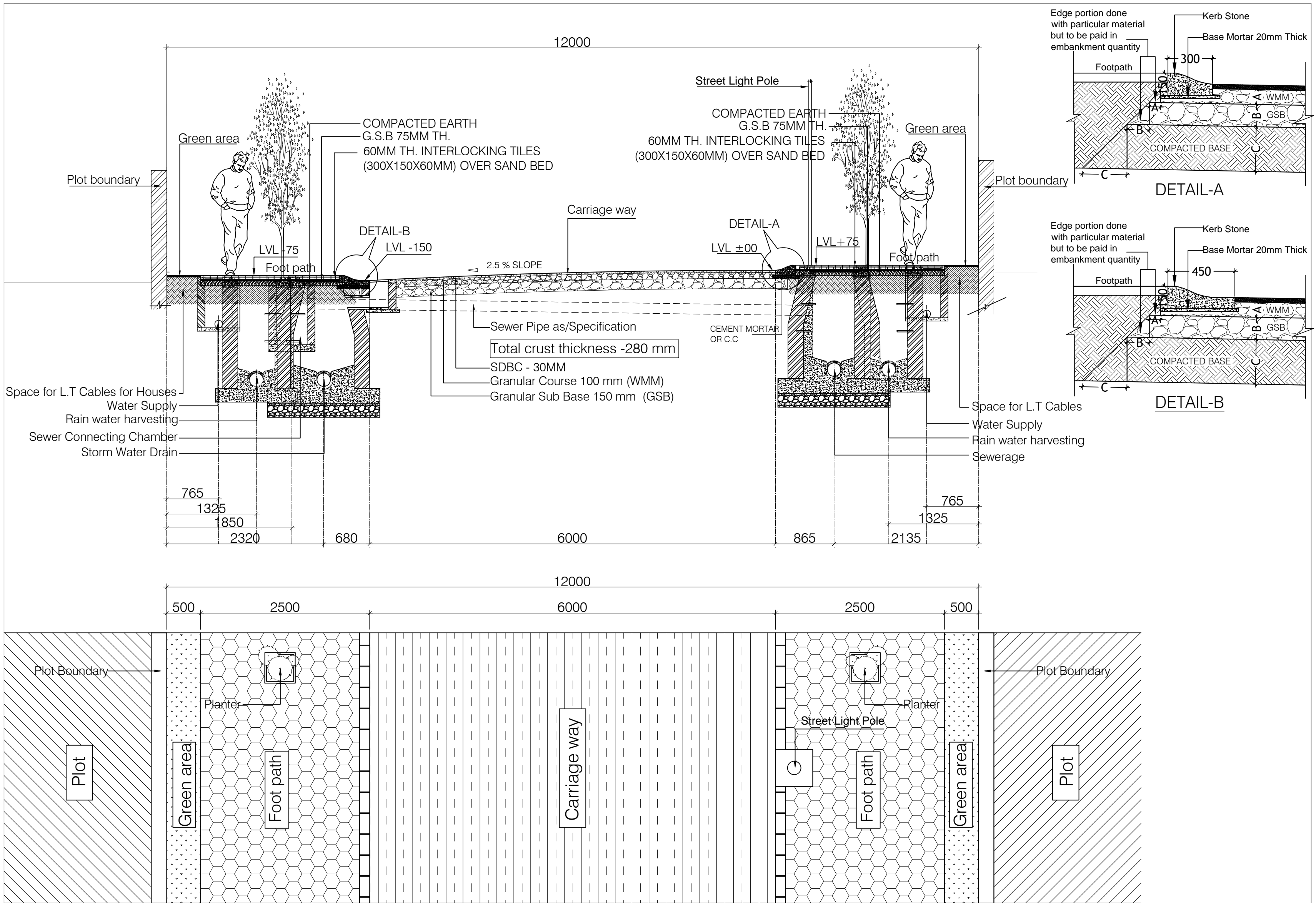

PROJECT NAME:
WAVE HI - TECH TOWNSHIP

CLIENT:
INFRA- 13 Pvt. Ltd.

NOTE:-

1. THE CRUST THICKNESS SHALL BE AS PER DESIGN
2. THE FORMATION LEVELS SHOULD BE CHECKED AS PER SITE GRADING PLAN
3. THE LOCATION AND SIZES OF MANHOLES, CHAMBERS & PIPES FOR DRAINAGE, SEWERAGE, RAIN WATER HARVESTING AND WATER SUPPLY SHALL BE AS PER RESPECTIVE DRAWINGS
4. THE LOCATION OF ELECTRIC POLES AND ELECTRIC TRENCHES TO BE READ FROM ELECTRICAL DRAWING
5. IN CASE OF ANY DISCREPANCY THE ISSUE SHOULD BE BROUGHT TO THE NOTICE OF REPL. BEFORE COMMENCEMENT OF EXECUTION

REVISION NO	REVISION DATE	DESCRIPTION
R1	18.01.11	
R2	26.02.11	
R3	02.06.11	
R4	28.06.11	
R5	03.08.11	REVISED KERB STONE DETAIL

DRAWING TITLE DETAILS OF 12 M WIDE ROAD	
DRAWING NO W-H-T/SER/RD-12/SEC/2	
SCALE	N.T.S
DATE	04.10.10
DEALT BY	GAJENDRA SINGH (T.D.)

INFRA-13 Pvt. Ltd.			
Sr. Architect (T.D.)	G.M. (EX.)	G.M. (T.D.)	C.O.O. (T.D.)

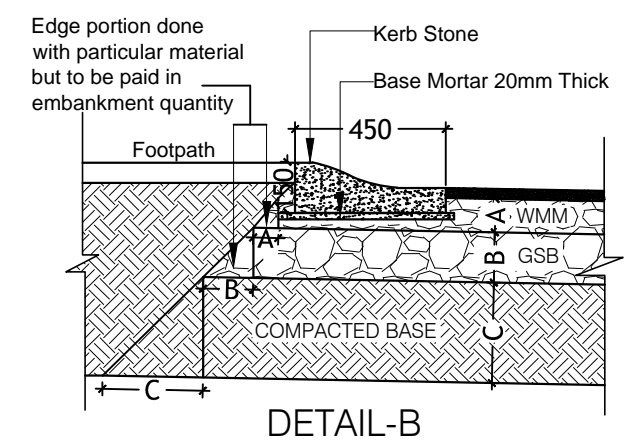
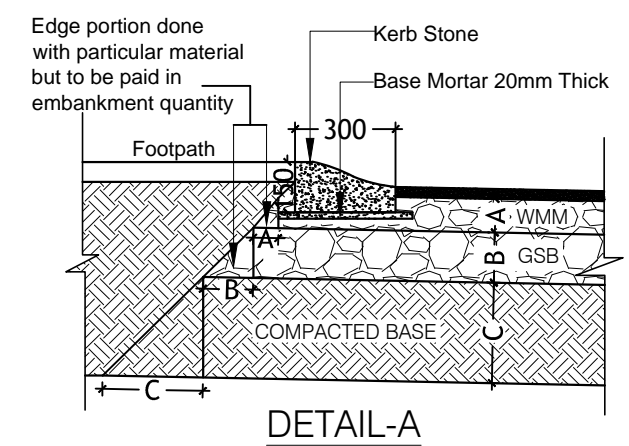
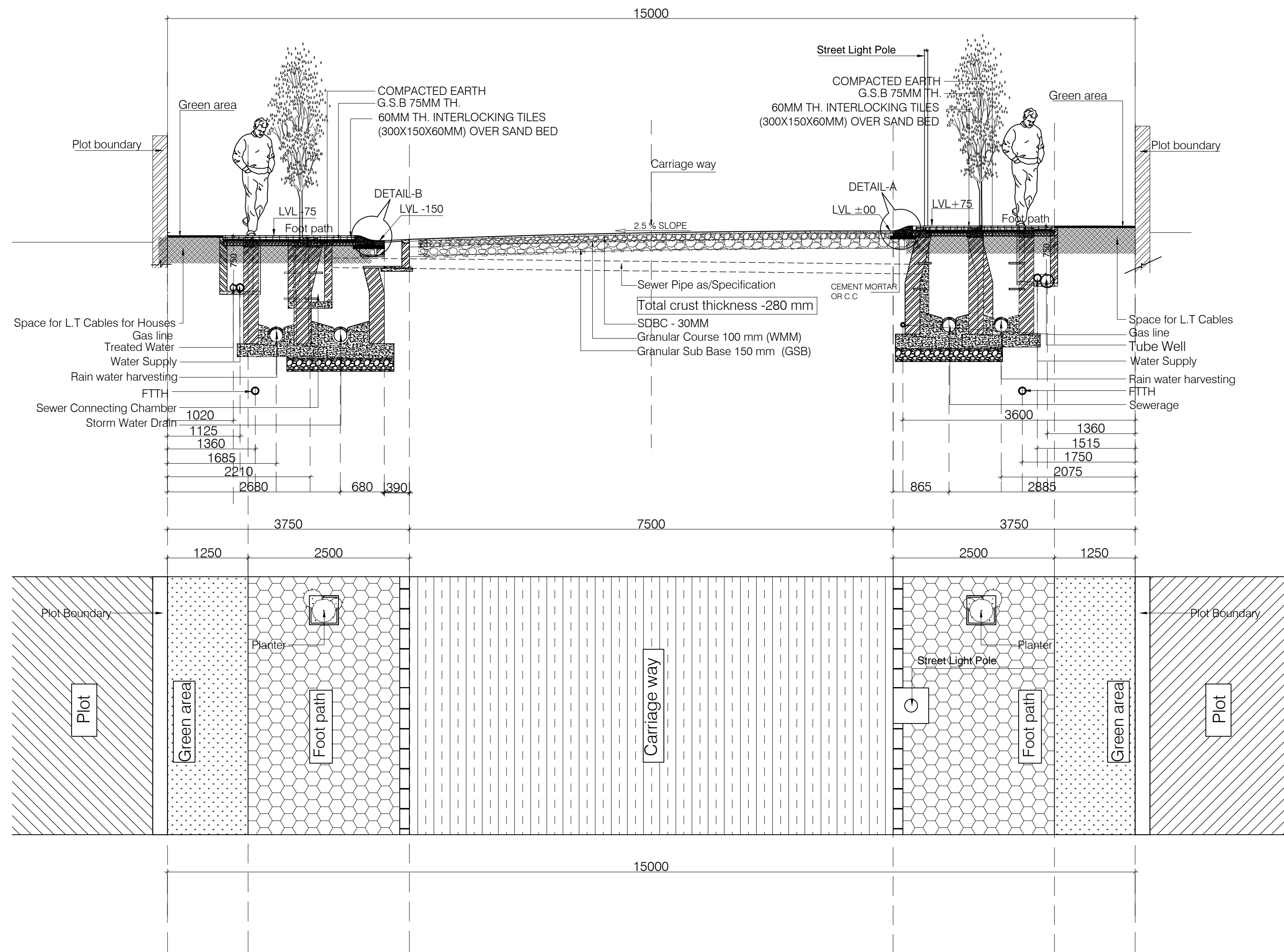

ROAD SECTION- 15 M WIDE ROAD
FOR SECTOR-1 PLOTTED _WC

05 SEP 2018