

Total Plot Area of Commercial 2 as per Layout	49795.75	Sqm
Total Plot Area as currently Approved	29415.27	Sqm
FAR Achieved	2.46	

Block No.	FAR Area	Proportionate Land Area	
Block-1 (Omexe Metro City Commercial-2 Phase-1)	7507.70	3050	Sqm
Block-2A (Omexe Metro City Commercial-2 Phase-2)	11473.37	4662	Sqm
Block-2B (Omexe Metro City Commercial-2 Phase-3)	17573.30	7140	Sqm Proposed for Registration
Block-2C (Omexe Metro City Commercial-2 Phase-4)	35844.67	14563	Sqm Already Registered (UPRERAPR1461785)
Total	72399.04	29415	Sqm

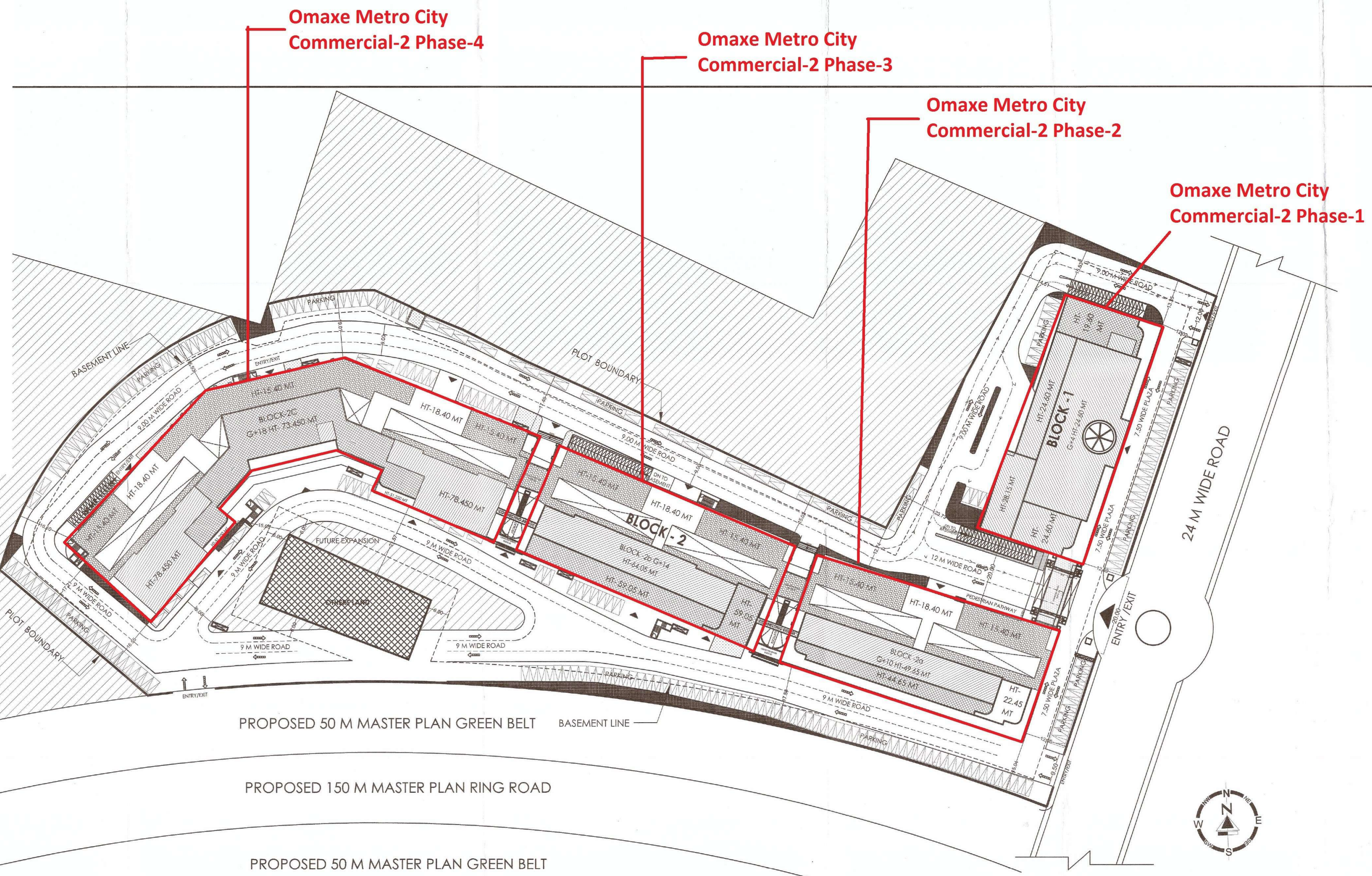

This drawing is a "COPYRIGHT" contents of this drawing or part thereof may not be used or reproduced without the permission of the Architect

PROJECT
 PROPOSED BUILDING AT
 COMMERCIAL - 2, CITY CENTER / ZONAL SHOPPING
 OMEXE METRO CITY (GARV BUILDTECH PVT. LTD.)
 (KHA/SRA NO - 2011, 2012, 2013, 2042,
 2043,2044,2045,2050,2046,2068,2089 & 2058)

SITE PLAN

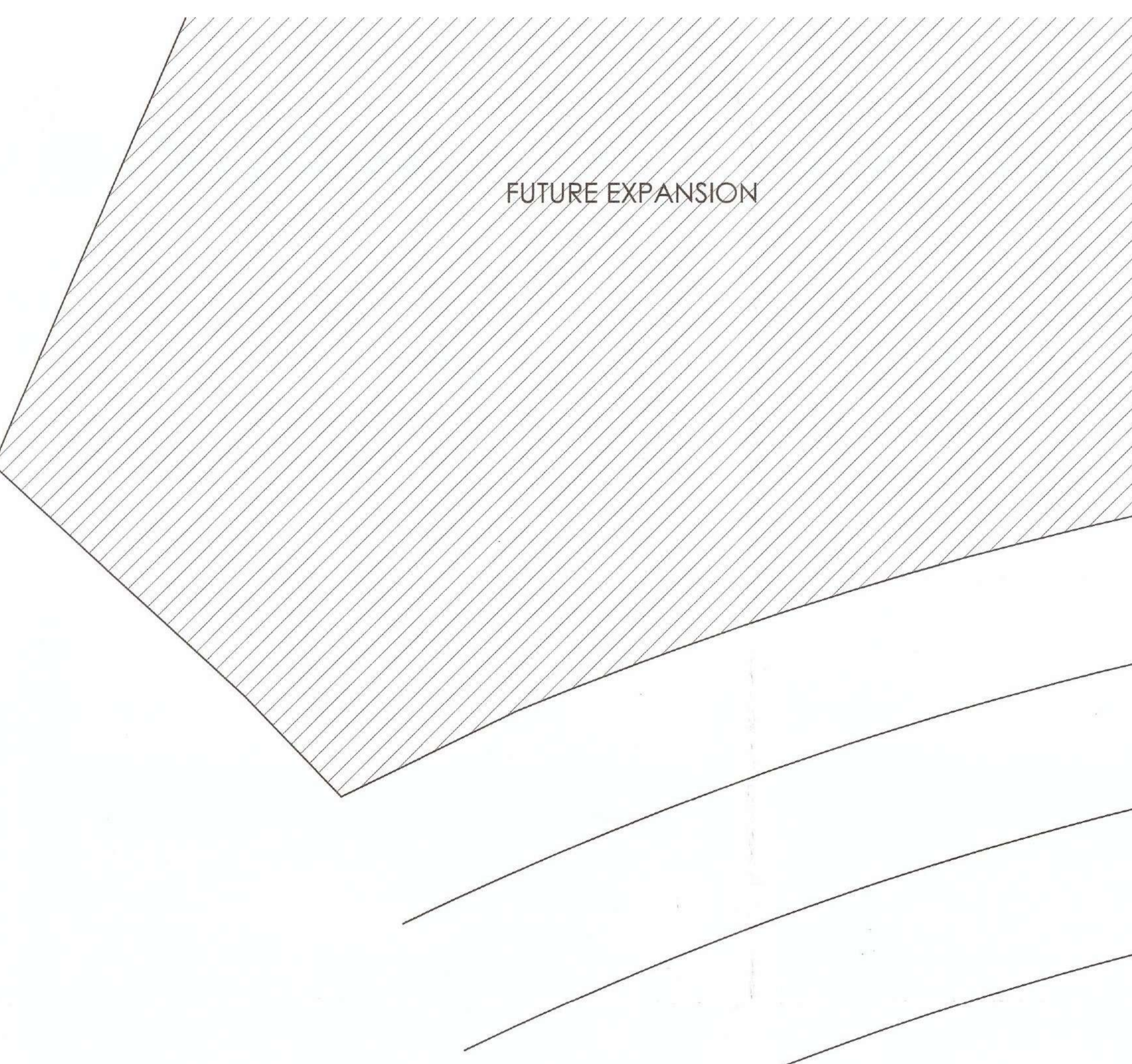

SITE PLAN

SL. NO.	DESCRIPTION	No./%	(sq.m.)	(acres)	(hac)
1	PLOT AREA	100	64,103.77	15.84	6.41
2	NET PLANNING AREA		29,415.27	7.27	2.94
3	PERMISSIBLE GROUND COVERAGE (40% OF NETT PLANNING AREA)	40%	11,766.11		
4	PERMISSIBLE FAR(2.5 OF NET PLANNING AREA)	2.5	73,538.18		
5	REQUIRED NO. OF PARKING @1.5 ECS/100 SQ.MT TOTAL FAR AREA OF COMMERCIAL SHOPS (28541 SQ.MTRS)	427	ECS		
6	REQUIRED NO. OF PARKING @2.0 ECS/100 SQ.MT TOTAL FAR AREA OF COMMERCIAL ACTIVITY HALL (7418.09 SQ.MTRS)	131	ECS		
7	REQUIRED NO. OF PARKING @1.0 ECS/PER 2 ROOM (TOTAL NO. OF UNITS = 879)	439.5	ECS		
8	TOTAL PARKING REQUIRED	998	ECS		
9	ACHIEVED GROUND COVERAGE	39.27	11550.02	2.85	1.16
10	ACHIEVED FAR	2.46	72,399.04		
11	Block 02A		11473.37		
12	Block 02B		17573.30		
13	Block 02C		35844.67		
14	TOTAL FAR	2.46	72399.04		
15	Balance FAR		1,139.136		
16	PROVIDED NO. OF PARKING (On Surface)	372	ECS		
17	NORMAL PARKING IN BASEMENT	630	ECS		
18	TOTAL	1002	ECS		

SL. NO.	DESCRIPTION	No./%	(sq.m.)	(acres)	(hac)
1	PLOT AREA	100	64,103.77	15.84	6.41
2	NET PLANNING AREA		29,415.27	7.27	2.94
3	PERMISSIBLE GROUND COVERAGE (40% OF NETT PLANNING AREA)	40%	11,766.11		
4	PERMISSIBLE FAR(2.5 OF NET PLANNING AREA)	2.5	73,538.18		
5	REQUIRED NO. OF PARKING @1.5 ECS/100 SQ.MT TOTAL FAR AREA OF COMMERCIAL SHOPS (28541 SQ.MTRS)	427	ECS		
6	REQUIRED NO. OF PARKING @2.0 ECS/100 SQ.MT TOTAL FAR AREA OF COMMERCIAL ACTIVITY HALL (7418.09 SQ.MTRS)	131	ECS		
7	REQUIRED NO. OF PARKING @1.0 ECS/PER 2 ROOM (TOTAL NO. OF UNITS = 879)	439.5	ECS		
8	TOTAL PARKING REQUIRED	998	ECS		
9	ACHIEVED GROUND COVERAGE	39.27	11550.02	2.85	1.16
10	ACHIEVED FAR	2.46	72,399.04		
11	Block 02A		11473.37		
12	Block 02B		17573.30		
13	Block 02C		35844.67		
14	TOTAL FAR	2.46	72399.04		
15	Balance FAR		1,139.136		
16	PROVIDED NO. OF PARKING (On Surface)	372	ECS		
17	NORMAL PARKING IN BASEMENT	630	ECS		
18	TOTAL	1002	ECS		

BLOCKS	FLOORS	FAR Area	Non FAR Area (m2/mtr)	Ground Coverage	No. OF UNITS	Covered Area (For Fee)	
BLOCK-01 (GRO + 02 FLOORS COMMERCIAL SHOPS + 02 FLOORS COMMERCIAL ACTIVITY HALL)	Ground Floor	2051.21	361.40	2221.50	2221.50	2221.50	
	1st Floor	1801.36	99.80	1901.16	1901.16	1901.16	
	2nd Floor	1591.52	99.80	1691.32	1691.32	1691.32	
	3rd Floor	1381.68	99.80	1481.48	1481.48	1481.48	
	Murumty	7507.70	329.53	2221.50	2221.50	2221.50	
	TOTAL	7507.70	829.83	2221.50	2221.50	2221.50	
	BLOCK-02	Ground Floor	2208.08	431.09	2639.09	2639.09	2639.09
		1st Floor	1991.15	61.29	2052.44	2052.44	2052.44
		2nd Floor	1784.22	61.29	1845.51	1845.51	1845.51
		3rd Floor	1577.29	61.29	1638.58	1638.58	1638.58
Service Floor		651.32	799.09	799.09	799.09	799.09	
COMMERCIAL SHOPS + 02 FLOORS COMMERCIAL		651.32	61.29	712.61	712.61	712.61	
ACTIVITY HALL + 02		651.32	61.29	712.61	712.61	712.61	
FLOORS HOTEL		651.32	61.29	712.61	712.61	712.61	
ROOMS + 02 AMENITY FLOORS		651.32	61.29	712.61	712.61	712.61	
Murumty		348.73	341.88	490.61	490.61	490.61	
TOTAL	11473.37	1001.88	2905.90	2905.90	2905.90		

SP1	SP2	SP3	SP4	SP5	SP6	SP7	SP8	SP9	SP10	SP11	SP12	SP13	SP14	SP15	SP16	SP17	SP18	SP19	SP20	SP21	SP22	SP23	SP24
69.49	48.45	23.72	19.23	36.16	27.29	12.00	56.22	27.00	autocad area	17.41	162.15	29.56	20.92	29.03	7.50	18.00	10.00	11.50	8.50	8.50	9.92	12.51	9.01
11.50	11.50	11.50	11.50	11.50	11.50	11.50	11.50	11.50	11.50	9.45	9.00	9.00	11.50	11.50	11.50	8.50	11.50	11.50	5.00	11.00	22.00	10.22	11.10
1	1	1	1	1	1	1	1	1	1	1	1	1	1	1	1	1	1	1	1	1	1	1	1
799.14	534.16	272.78	221.15	404.34	313.84	138.00	646.53	310.50	1020.00	164.52	1459.35	286.04	240.58	333.85	86.25	153.00	115.00	57.50	93.50	218.24	127.85	100.01	
sqm	sqm	sqm	sqm	sqm	sqm	sqm	sqm	sqm	sqm	sqm	sqm	sqm	sqm	sqm	sqm	sqm	sqm	sqm	sqm	sqm	sqm	sqm	sqm

Check List for Fire Fighting Submission of Commercial-2 City Center/Zonal Shopping Center in Omexe Hitech City, Lucknow, JP	Building Category: Commercial-2	Requirement As Per NBC 2016	Proposal
1	Fire extinguisher	Required	Yes, We Will Provide
2	Hose reel	Required	Yes, We Will Provide
3	Wet riser	Required	Yes, We Will Provide
4	Yard hydrant	Required	Yes, We Will Provide
5	Automatic Sprinkler system	Required	Yes, We Will Provide
6	Manually Operated Electric Fire Alarm	Required	Yes, We Will Provide
7	Automatic Fire Detection & Alarm System	Required	Yes, We Will Provide
8	Underground Water Tank	500 KLD. Required	500 KLD. Yes, We Will Provide
9	Overhead Tank - Each Tower	20 KLD. Required	20 KLD. We Will Provide
10	Underground Pump Requirement	2 Diesel pump-2850 LPM, 3 Electrical pump- 2850 LPM, 3 Jockey pump - 180 LPM,	3 Diesel pump- 2850 LPM, 3 Electrical pump- 2850 LPM, 3 Jockey pump - 180 LPM,
11	Ventilation System	Required	Yes, We Will Provide
12	Pressurization System	Required	Yes, We Will Provide
13	Fire Command centre at Ground floor	Required	Yes, We Will Provide
14	Fire shaft	Required	Yes, We Will Provide
15	P.A System	Required	Yes, We Will Provide
16	Fire Man Switch Lift	Required	Yes, We Will Provide
17	Fire Officer per Tower	Required	Yes, We Will Provide
18	Compartmentation	Required	Yes, We Will Provide
19	Exit Signage	Required	Yes, We Will Provide
20	Fire Door	Required	All doors of each staircase at all floor will be 240 min. fire resistant and all roof will be 240 min. fire resistant
21	Termination of all stairs at Ground Lvl.	Required	Yes, We Will Provide
22	Separate staircase to pump house.	Required	Yes, We Will Provide
23	For more than 60.0m ht Building pressure pump will be provided in basement	Required	Yes, We Will Provide

Note: All Fire Fighting System Will be Provided as per NBC

ALL TOILETS ARE MECHANICALLY VENTILATED AS PER REFERENCE UP GOVT. AWAS EVAM SHARHI NIYOJAN - ANUBHAG -3 - VIDE LETTER NO - I/19257(1)/2019 - DATED - 29/01/20

DRAWING TITLE
 SUBMISSION DRAWING (SITE PLAN)

SCALE DATE

CLIENT/ OWNERS

ARCHITECT'S SIGNATURES

OWNER'S SIGNATURES

DRAWING NUMBER- LKO/COMM-2S-1/SUB-F-D-1/14

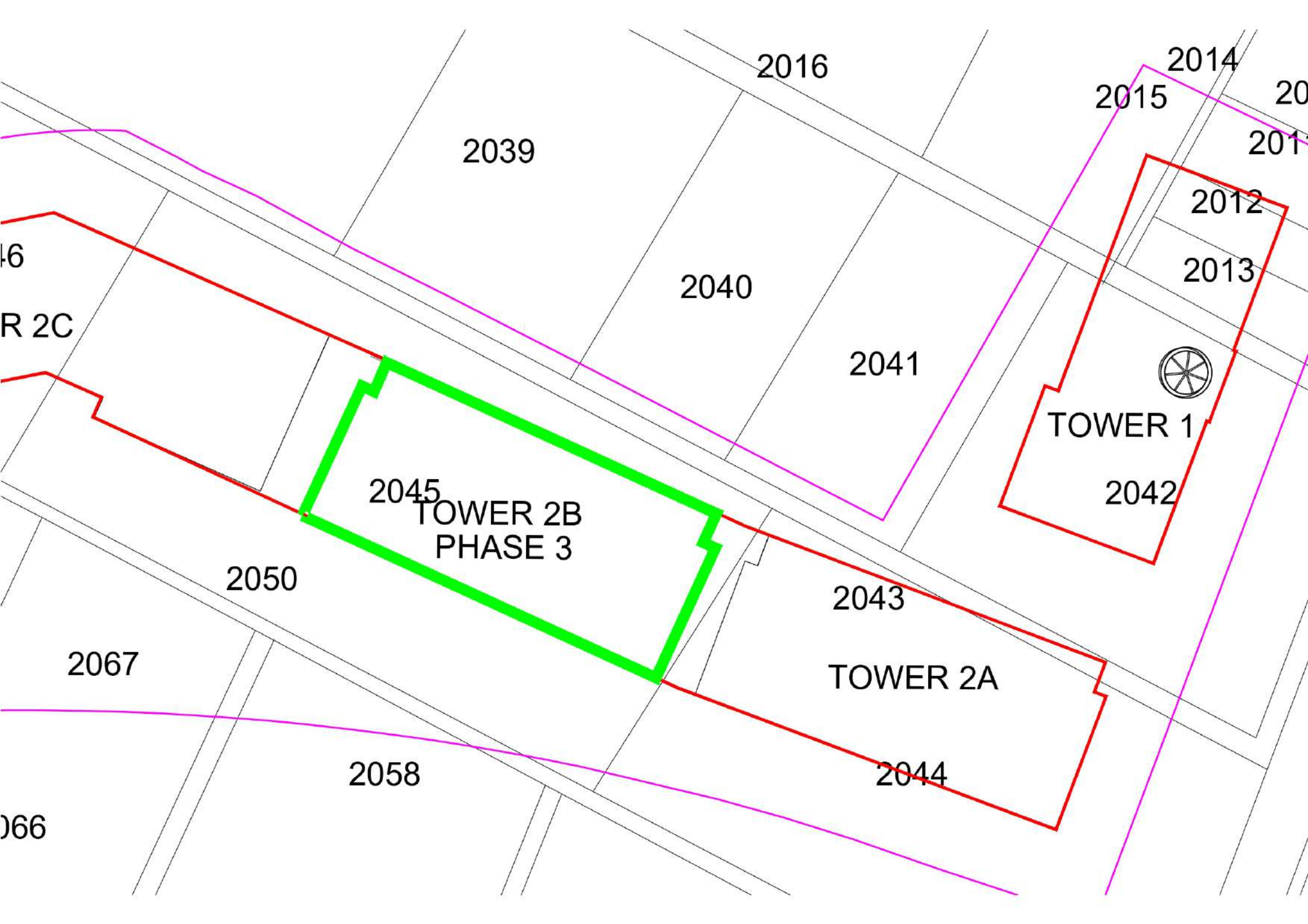

2016

2014

2039

2015

2011

2040

2012

16

R 2C

2041

2013



TOWER 1

2045

TOWER 2B
PHASE 3

2042

2050

2043

2067

TOWER 2A

2058

2044

066