

PRODUCED BY AN AUTODESK EDUCATIONAL PRODUCT

PLOT NO-SLC-8/G/1

PLOT NO-88 TO 95

PLOT NO.-SLC-8/G/2

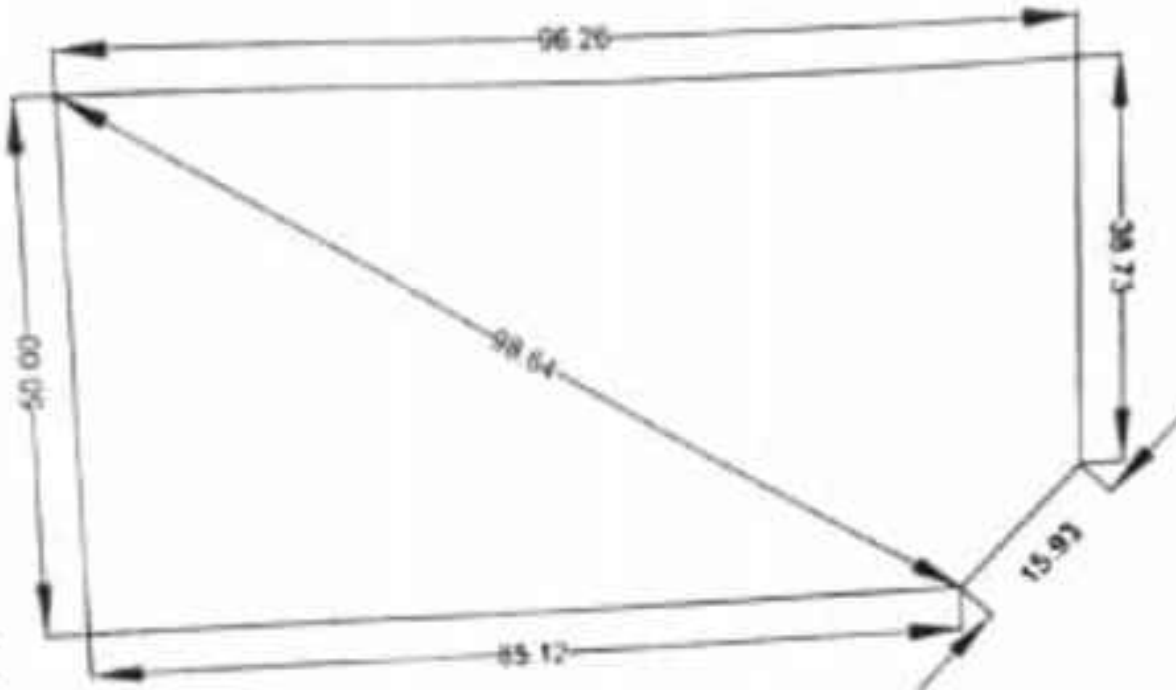

60.00 M WIDE ROAD

60.00 M WIDE ROAD

AREA=4751.16 SQM

SIGN POSSESSION TAKEN OVER ALLOTTEE

SIGN POSSESSION HANDED OVER



LEASE PLAN FOR PLOT NO.-SLC-8/G/1 SECTOR-DELTA-2 GREATER NOIDA

PROJ. DEPTT.

01/10/21
ASST. MANAGER

01/11/21
MANAGER

01/11/21
ASST. MANAGER

LAND DEPT.

Signed by Subash Singh
Lekhpal

Signed by Rashmi Singh
ASST. MANAGER

Signed by Jitendra Gautam
TEHSILDAR
01/11/21 16:25:21

LAW DEPTT.

11/21 16:11:24

ASST. MANAGER

MANAGER

PLNG. DEPTT.

Signed by Shikha Singh
DRAFTSMAN
30/09/21 15:59:44

Signed by Shikha Singh
DEPUTY LAW OFFICE
09/11/21 15:06:15



GREATER NOIDA INDUSTRIAL DEVELOPMENT AUTHORITY

PRODUCED BY AN AUTODESK EDUCATIONAL PRODUCT

PRODUCED BY AN AUTODESK EDUCATIONAL PRODUCT

PRODUCED BY AN AUTODESK EDUCATIONAL PRODUCT