

**Project Title** -PROPOSED LAYOUT PLAN FOR MR. MOHAMMED ASLAM SURAI, AKRAM, SUHAIB AKRAM, AND SMT. TASNEEM KAUSER, CN, GATA NO - 398, VILL. SARAI SHEKH, DISTIC AND TERHEL, LUCKNOW

MAINLINE (SOIL PIPE 400 MM)	SECONDARY LINE (SOIL PIPE 200 MM)
SOIL PIPE SLOP = 1%TMM	
MAINLINE (RAIN WATER 200 MM)	SECONDARY LINE (RAIN WATER 100 MM)
PIPE SLOP = 1%OZMM, 1%OZMM, 1%OZMM, 1%OZMM	
GAS PIPE LINE	

- MH** MAIN JUNCTION CHAMBER (2'X2')
- MH** SECONDARY JUNCTION CHAMBER (2'X2')
- RWH** RAIN WATER HARVESTING CHAMBER (2' X 2')

PLOT AREA AS PER SITE	-36685.42 sqmt
ROAD WEDNING AREA	-1308.90 sqmt
NET PLOT AREA	-35376.52 sqmt
REQUIRED GREEN AREA 15% OF NET PLOT AREA	-5306.478 SQMT
PROP.GREEN AREA(15.008%)	-5309.0 SQMT
GARBAGE COLLECTION AREA	-30.0 SQMT
KIOSK /PLATFROM AREA	-30.0 SQMT
SECTOR SHOPPING AREA(0.85)	-197.84 SQMT
CONVINENT SHOP AREA (0.80)	-326.90 SQMT
INTERNAL ROAD AREA(24.0%)	-8474.30 SQMT
TOTAL PLOTTED AREA(67.85%)	-26393.08 SQMT

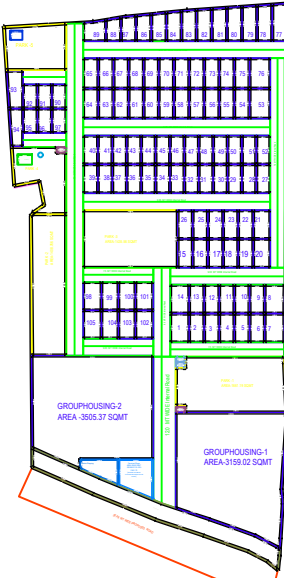

**NOTE:**

- This drawing is a property of De:Ca+Pe Studio and is not to be reproduced copied or handed over in any form except for the purpose for which it is intended.
- All dimension are in Meter except where mentioned.
- Drawings are not to be scaled written dimensions are to be followed.
- All discrepancies to be brought to the notice of the Architect and resolved before commencement of any work.

**Project Title** -PROPOSED LAYOUT PLAN FOR MR. MOHAMMED ASLAM SURAI, AKRAM, SUHAIB AKRAM, AND SMT. TASNEEM KAUSER, CN, GATA NO - 398, VILL. SARAI SHEKH, DISTIC AND TERHEL, LUCKNOW

<b>Architectural Consultant</b>	Ar. Gaurav Gupta
<b>Structural Consultant</b>	MR MAYUR PANDYA, ACCENT MUMBAI
<b>Plumbing Consultant</b>	MR VIVEK, LUCKNOW
<b>Electrical Consultant</b>	MR PK KUSHWAHA, DELHI

<b>Client/Owner</b>	MR. JEESHAN ASLAM, CCS INFRATECH
<b>Project Description</b>	TOWNSHIP LAYOUT
<b>North</b>	
<b>Drawing Title</b>	

<b>Date:-</b>	08/02/2025
<b>Drawn By:-</b>	Ar. Gaurav Gupta
<b>Checked By:-</b>	N.T.S
<b>Scale:-</b>	
<b>Project Code-</b>	
<b>Sheet No.-</b>	

**Office Stamp**

**DE: CA+PE STUDIO**  
Collaborative Architecture & Planning Environment

**Head Office** - L2-155, Sector G, LDA colony, Noida  
**Branch Office** - Spring Dale School, Lucknow - 226012  
**Branch Office** - B1, Basement, Kalkaji extension, New Delhi  
**Contact no** - +91 99350 05439  
**E-Mail** - studio.decape18@gmail.com  
**Info** - decapestudio@gmail.com

